

9450 W. Laraway Rd.  
 Frankfort, IL 60423  
 P: 800-843-7234  
 F: 888-479-1515  
 www.therafin.com

## Seating Order Form

Client:

Account Number:

Shipping Address:

Mark For:

ATP:

PO#:

### Patient Dimensions

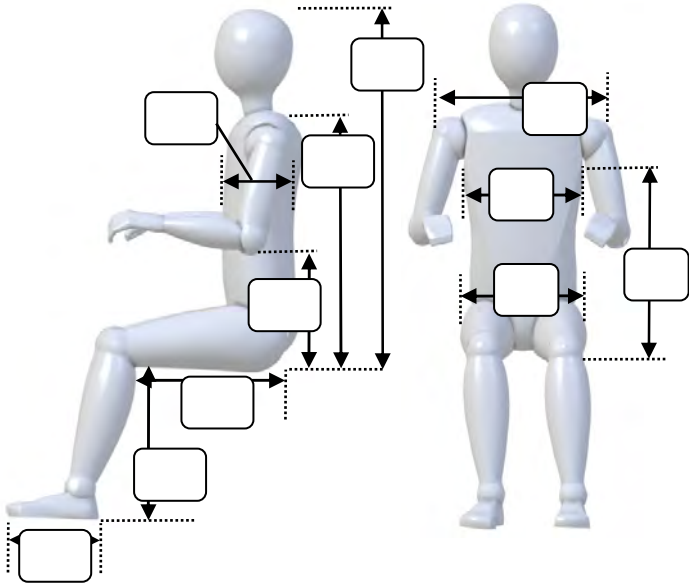

Chair Manuf.

Chair Model

Chair Width

Chair Depth

- No Assembly
- Include Assembly

### Seat Dimensions

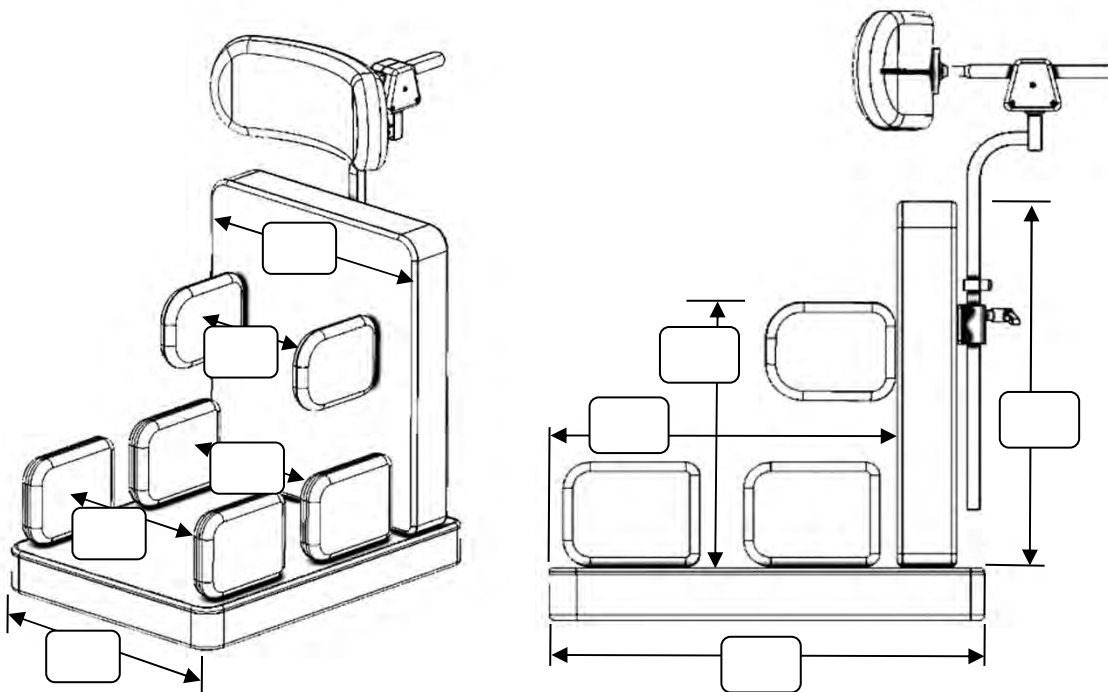

## Monogram Style

N/C

- 70202 MONOGRAM FONT, NEW BLOCK
- 70204 MONOGRAM FONT, EURO NEW BLOCK
- 70203 MONOGRAM FONT, ALEGRA SCRIPT
- 70205 MONOGRAM FONT, MANILA SCRIPT
- 70206 MONOGRAM FONT, CIN SCRIPT

## Monogram Text

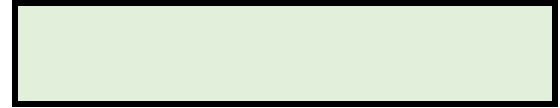

## Monogram Color

N/C

- 70207 LIGHT BLUE
- 70208 BLUE (VINYL)
- 70209 BLUE OPAL
- 70210 COSMIC BLUE
- 70211 CANDY BLUE
- 70212 ELECTRIC BLUE
- 70215 DEEP PURPLE
- 70216 ELECTRIC PURPLE
- 70214 PURPLE (VINYL)
- 70213 LIGHT PURPLE
- 70231 CANDY TURQUOISE
- 70230 ELECTRIC TEAL
- 70229 ISLAND BLUE
- 70222 GRANNY SMITH
- 70223 GRASSHOPPER GREEN
- 70220 LIME GREEN
- 70221 MONSTER GREEN
- 70224 KELLY GREEN
- 70225 TOXIC GREEN
- 70219 FOREST GREEN (VINYL)
- 70228 TANGERINE RED
- 70227 CANDY RED
- 70226 RED (VINYL)
- 70232 RASPBERRY

- 70233 RAZZLEBERRY
- 70234 VERY CHERRY
- 70235 BLACK CHERRY
- 70237 PEARL PINK
- 70238 PINK PARFAIT
- 70239 PRETTY IN PINK
- 70240 HOT PINK
- 70236 PINK (VINYL)
- 70242 BUBBLEGUM PINK
- 70241 FUSCHIA
- 70245 BURNT ORANGE
- 70243 ORANGE
- 70244 ORANGESICLE
- 70246 COPPER
- 70248 YELLOW GOLD
- 70249 VEGAS GOLD
- 70247 YELLOW (VINYL)
- 70251 ROOT BEER (BROWN)
- 70250 BEIGE
- 70217 GREY (VINYL)
- 70218 SILVER
- 70252 CINNAMON
- 70253 CINNAMON SPICE

## Fabric Color and Type

N/C

### Contact Non-Contact

- |                          |       |                          |       |                         |
|--------------------------|-------|--------------------------|-------|-------------------------|
| <input type="checkbox"/> | 72019 | <input type="checkbox"/> | 72020 | DARLEXX                 |
| <input type="checkbox"/> | 72066 | <input type="checkbox"/> | 72067 | DARTEX SMOOTH SIDE OUT  |
| <input type="checkbox"/> | 72064 | <input type="checkbox"/> | 72069 | MESH FABRIC (TheraVent) |
| <input type="checkbox"/> | 71006 | <input type="checkbox"/> | 72068 | DARTEX KNIT SIDE OUT    |
| <input type="checkbox"/> | 72070 | <input type="checkbox"/> | 72071 | 2MM KNIT NEOPRENE       |
| <input type="checkbox"/> | 72072 | <input type="checkbox"/> | 72073 | BLACK VINYL             |
| <input type="checkbox"/> | 72074 | <input type="checkbox"/> | 71037 | RED VINYL               |
| <input type="checkbox"/> | 72075 | <input type="checkbox"/> | 71038 | GREY VINYL              |
| <input type="checkbox"/> | 72076 | <input type="checkbox"/> | 71039 | PINK VINYL              |
| <input type="checkbox"/> | 72077 | <input type="checkbox"/> | 71040 | YELLOW VINYL            |
| <input type="checkbox"/> | 72078 | <input type="checkbox"/> | 71041 | PURPLE VINYL            |
| <input type="checkbox"/> | 72079 | <input type="checkbox"/> | 71042 | BLUE VINYL              |
| <input type="checkbox"/> | 72080 | <input type="checkbox"/> | 71043 | GREEN VINYL             |
| <input type="checkbox"/> | 72081 | <input type="checkbox"/> | 71044 | TEAL VINYL              |
| <input type="checkbox"/> | 72082 | <input type="checkbox"/> | 71045 | RASPBERRY VINYL         |
| <input type="checkbox"/> | 72085 | <input type="checkbox"/> | 72092 | MONSTER GREEN VINYL     |
| <input type="checkbox"/> | 72086 | <input type="checkbox"/> | 72093 | ORANGESICLE VINYL       |
| <input type="checkbox"/> | 72087 | <input type="checkbox"/> | 72094 | VERY CHERRY VINYL       |
| <input type="checkbox"/> | 72088 | <input type="checkbox"/> | 72095 | FIZZY COLA VINYL        |
| <input type="checkbox"/> | 72089 | <input type="checkbox"/> | 72096 | ISLAND BLUE VINYL       |
| <input type="checkbox"/> | 72090 | <input type="checkbox"/> | 72097 | CINNAMON SPICE VINYL    |
| <input type="checkbox"/> | 72091 | <input type="checkbox"/> | 72098 | PRETTY IN PINK VINYL    |

## Design Custom Seat

### Choose Seat Fit

- Drop In Seat (Equals Chair width minus 2.75")
- Full Width Seat

### Choose Seat Type E2609

- |                          |       |  |       |
|--------------------------|-------|--|-------|
| <input type="checkbox"/> | 71046 | Seat including Base, Foam & Cover        | \$529 |
| <input type="checkbox"/> | 71055 | Base Only                                | \$529 |
| <input type="checkbox"/> | 71047 | Cushion Only (includes hook and loop)    | \$529 |
| <input type="checkbox"/> | 71072 | Vinyl covered base with separate cushion | \$798 |

### Select for Transit (Please select Seat Type First)

- 72054 Transit Seat (Must select Transit seat hdwr)

## Select Shape Modifications

### Back Post Notch

- |                          |       |                                      |      |
|--------------------------|-------|--------------------------------------|------|
| <input type="checkbox"/> | 71085 | Growth Notches on base only (Hidden) | \$0  |
| <input type="checkbox"/> | 71009 | Growth Notches on base & seat        | \$93 |

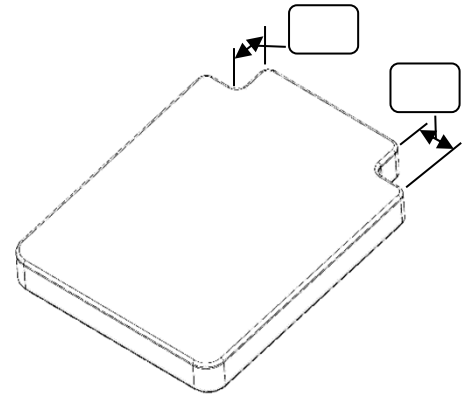

### I Shape

- |                          |       |                     |       |
|--------------------------|-------|---------------------|-------|
| <input type="checkbox"/> | 71026 | I Seat Modification | \$116 |
|--------------------------|-------|---------------------|-------|

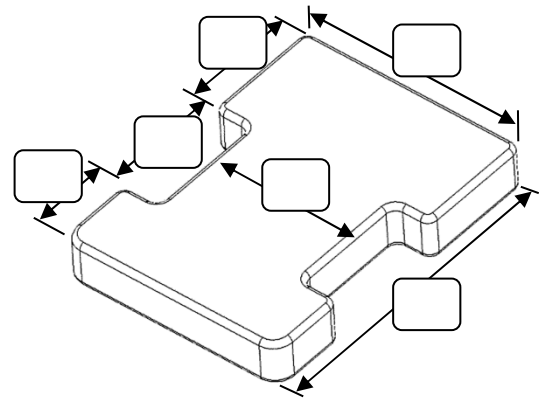

### Asymmetrical Shape

- |                          |       |                   |       |
|--------------------------|-------|-------------------|-------|
| <input type="checkbox"/> | 71008 | Asymmetrical Seat | \$105 |
|--------------------------|-------|-------------------|-------|
- Right Leg Shortened (use diagram below)
  - Include T-Nuts for Medial Thigh Support

- Left Leg Shortened (use diagram below)
- Include T-Nuts for Medial Thigh Support

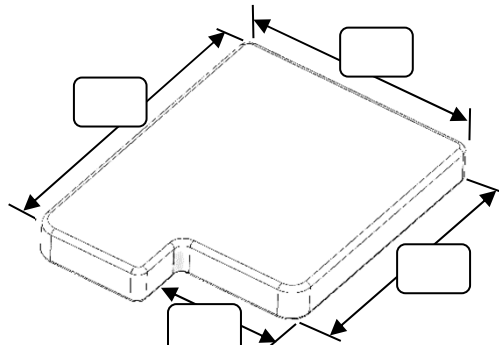
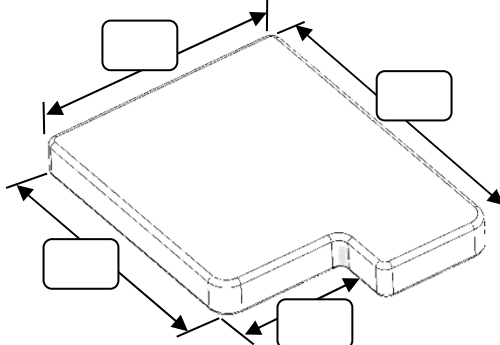

## Hamstring Relief

- |                          |       |                |       |
|--------------------------|-------|----------------|-------|
| <input type="checkbox"/> | 72060 | Extended Foam  | \$116 |
| <input type="checkbox"/> | 72061 | Shortened Base | \$116 |

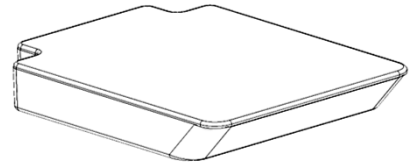

### Extended Foam



User Seat Depth PLUS 2" Foam Extended Out Front

### Shortened Base



User Seat Depth Cut Back 2"

## Select Contour Modifications

### Anti-Thrust Seat

- |                          |       |                  |      |
|--------------------------|-------|------------------|------|
| <input type="checkbox"/> | 71027 | Anti-Thrust Seat | \$93 |
|--------------------------|-------|------------------|------|
- 72065 Add Depth Adjustability to Contour \$165
- Standard contours**
- Shallow Contour (1/2" Riser; C=2, F= 1.5) - provide D & D1
- Medium Contour (1" Riser; C=2.5, F= 1.5)- provide D & D1
- Deep Contour (1 1/2" Riser C=3 F= 1.5)- provide D & D1

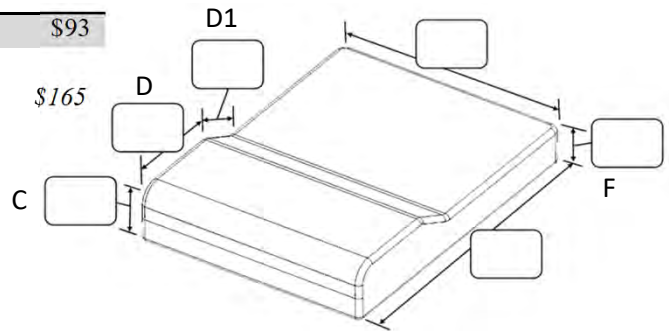

- Custom - provide dimensions on diagram

### Contoured Seats

- |                          |       |                                |       |
|--------------------------|-------|--------------------------------|-------|
| <input type="checkbox"/> | 71028 | Contoured Seat With Leg Wells: | \$192 |
|--------------------------|-------|--------------------------------|-------|
- 72065 Add Depth Adjustability to Contour \$165
- Standard contours**
- Shallow (1/2" Riser/1/2" wedge; C=2.5, F= 1.5, G=2, H=2.5) - provide D
- Medium (1" Riser/1/2" wedge; C=3, F= 1.5, G=2.5, H=3) - provide D
- Deep (1" Riser/1" wedge; C=3.5, F= 1.5, G=2.5, H=3.5) - provide D

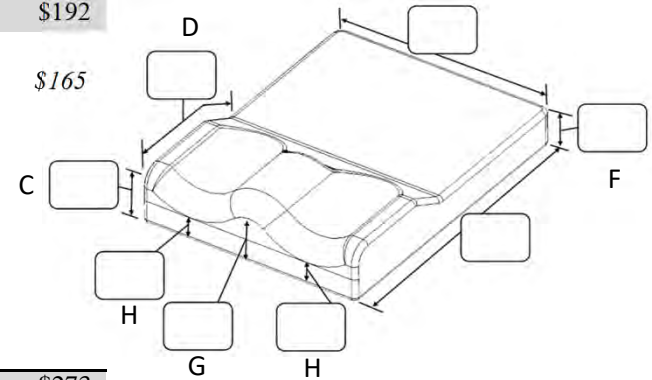

- Custom - provide dimensions on diagram

- |                          |       |   |       |
|--------------------------|-------|---|-------|
| <input type="checkbox"/> | 71029 | Contoured Seat With Leg and Pelvic Wells: | \$273 |
|--------------------------|-------|---|-------|

- 72065 Add Depth Adjustability to Contour \$165

### Standard contours

- Shallow (1/2" Riser/1/2" wedge; C=2.5, F= 2, G=2, H=2.5, J=1.5) - provide D
- Medium (1" Riser/1/2" wedge; C=3, F= 2, G=2.5, H=3, J=1.5) - provide D
- Deep (1" Riser/1" wedge; C=3.5, F= 2.5, G=2.5, H=3.5, J=1.5) - provide D

- Custom - provide dimensions on diagram

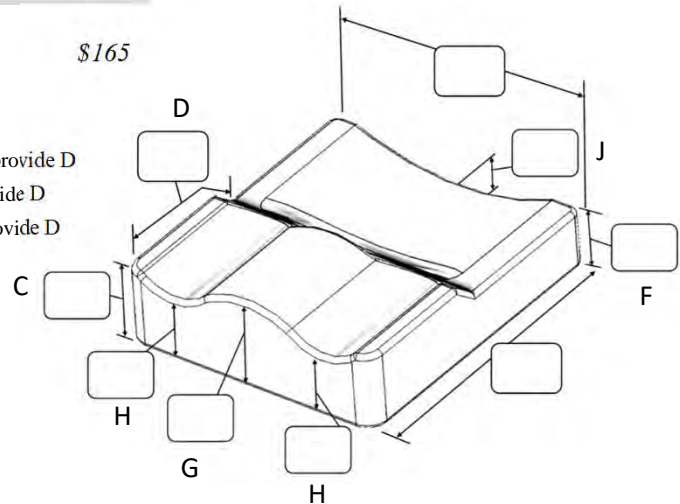

## Foam Modifications

### Standard Foam

<input type="checkbox"/>	Standard Foam: 1" soft over 1" medium (visco)	\$0
<input type="checkbox"/>	Standard Contoured Foam: 1/2" soft over 1" medium	\$0

### Substitute Foam

<input type="checkbox"/>	72062 Use Poly Foam Instead of Visco Foam	\$0
<input type="checkbox"/>	1/2"	
<input type="checkbox"/>	1"	
<input type="checkbox"/>	1 1/2"	
<input type="checkbox"/>	2"	

### Additional Foam

<input type="checkbox"/>	71016 Additional 1/2" Visco Foam	\$79
<input type="checkbox"/>	X-Soft	<input type="checkbox"/> XX- Soft T-Foam
<input type="checkbox"/>	Soft	
<input type="checkbox"/>	Medium	
<input type="checkbox"/>	71017 Additional 1" Visco Foam	\$116
<input type="checkbox"/>	X-Soft	<input type="checkbox"/> XX- Soft T-Foam
<input type="checkbox"/>	Soft	
<input type="checkbox"/>	Medium	
<input type="checkbox"/>	71018 Additional 1/2" Pudgee Type Visco Foam	\$192
<input type="checkbox"/>	71019 Additional 1" Pudgee Type Visco Foam	\$247
<input type="checkbox"/>	71020 1/2" Gel Overlay, Flat	
<input type="checkbox"/>	71095 1/2" Gel Overlay, Cubed	\$247
		\$279

\* note if gel is greater than 18x18 additional charges apply

<input type="checkbox"/>	71032 <b>Foam Modification</b>	
	Mushroom Foam for Seat	\$247

### Custom Foam Layering

Top Layer

Middle Layer

Bottom Layer

#### Custom Foam Layering Choices (see note at right)

None		
70179	1/2" XX-SOFT T-FOAM	\$75
70180	1/2" X-SOFT VISCO FOAM	\$75
70181	1/2" SOFT VISCO FOAM	\$75
70182	1/2" MEDIUM VISCO FOAM	\$75
70183	1/2" SOFT POLY FOAM	\$0
70184	1/2" FIRM POLY FOAM	\$0
70185	1" XX-SOFT T-FOAM	\$110
70186	1" X-SOFT VISCO FOAM	\$110
70187	1" SOFT VISCO FOAM	\$110
70188	1" MEDIUM VISCO FOAM	\$110
70189	1" FIRM VISCO FOAM	\$110
70190	1" SOFT POLY FOAM	\$0
70191	1" FIRM POLY FOAM	\$0

All foam up to 2" total thickness is included in base price of seat. Cost for custom foams is **only** applied when total thickness is greater than 2"

## Cover Modifications

### Cover Modifications

<input type="checkbox"/>	71023 2" Hook-n-Loop Strips, sewn, pair	\$93
<input type="checkbox"/>	50252 Shower Cap Seat Cover	\$275
<input type="checkbox"/>	50252 Additional Cover for Seat (Identical cover)	\$275
<input type="checkbox"/>	72056 Dureflex Liner (Seat)	\$69

## Hardware

### 2 Knob (Hinged Clamp) (Incl with E2609)

<input type="checkbox"/>	50405	2 Knob with short slotted brackets	\$286
<input type="checkbox"/>	50470	2 Knob with long slotted brackets	\$286

### 2 Knob Wrap Around (Incl with E2609)

<input type="checkbox"/>	50467	2 Knob Wrap Around Kit, 7/8" and 1" tubing	\$332
<input type="checkbox"/>	50494	2 Knob Wrap Around Kit, 1 3/8" tubing	\$439

#### *Transit*

<input type="checkbox"/>	51077	2 Knob Wrap Ar. Transit Seat Hdwr. (7/8", 1")	\$454
<input type="checkbox"/>	51094	2 Knob Wrap Ar. Transit Seat Hdwr. (1-3/8")	\$618

### 4 Knob Wrap Around (Incl with E2609)

<input type="checkbox"/>	50468	4 Knob Wrap Around Seat Hardware(7/8", 1")	\$481
<input type="checkbox"/>	50495	4 Knob Wrap Around Seat Hardware(1-3/8")	\$579

#### *Transit*

<input type="checkbox"/>	51078	4 Knob Wrap Ar. Transit Seat Hdwr. (7/8", 1")	\$618
<input type="checkbox"/>	51095	4 Knob Wrap Ar. Transit Seat Hdwr. (1-3/8")	\$768

### Snap On Hardware (Incl with E2609)

<input type="checkbox"/>	50618	W/Raised Drop Hooks and Universal Rail Locks	\$180
<input type="checkbox"/>	50617	Snap On Seat Hardware - 2 Pair	\$181

### Drop Hook Kits

#### w/2 Rail Locks & 2 Hinged Collars (Incl with E2609)

7/8" Tubing	<input type="checkbox"/>	50364	0" drop hook	\$ 176
	<input type="checkbox"/>	50357	1" drop hook	\$ 176
	<input type="checkbox"/>	50359	2" drop hook	\$ 176
1" Tubing	<input type="checkbox"/>	50364	0" drop hook	\$ 176
	<input type="checkbox"/>	50360	1" drop hook	\$ 176
	<input type="checkbox"/>	50362	2" drop hook	\$ 176

#### w/4 Rail Locks (Incl with E2609)

7/8" Tubing	<input type="checkbox"/>	50389	0" drop hook	\$ 176
	<input type="checkbox"/>	50482	1" drop hook	\$ 176
	<input type="checkbox"/>	50484	2" drop hook	\$ 176
1" Tubing	<input type="checkbox"/>	50389	0" drop hook	\$ 176
	<input type="checkbox"/>	50480	1" drop hook	\$ 176
	<input type="checkbox"/>	50391	2" drop hook	\$ 176

#### w/2 Swing Tabs & 2 Hinged Collars (Incl with E2609)

7/8" Tubing	<input type="checkbox"/>	50390	0" drop hook	\$ 182
	<input type="checkbox"/>	50483	1" drop hook	\$ 182
	<input type="checkbox"/>	50485	2" drop hook	\$ 182
1" Tubing	<input type="checkbox"/>	50390	0" drop hook	\$ 182
	<input type="checkbox"/>	50481	1" drop hook	\$ 182
	<input type="checkbox"/>	50393	2" drop hook	\$ 182

#### w/2 Swing Tabss & 2 Rail Locks (Incl with E2609)

7/8" Tubing	<input type="checkbox"/>	50394	0" drop hook	\$ 176
	<input type="checkbox"/>	50396	1" drop hook	\$ 176
	<input type="checkbox"/>	50397	2" drop hook	\$ 176
1" Tubing	<input type="checkbox"/>	50394	0" drop hook	\$ 176
	<input type="checkbox"/>	50398	1" drop hook	\$ 176
	<input type="checkbox"/>	50392	2" drop hook	\$ 176

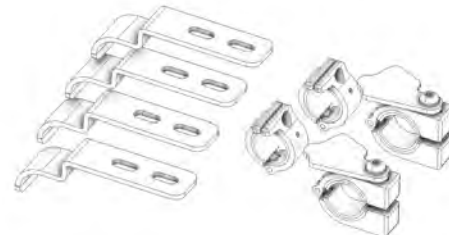
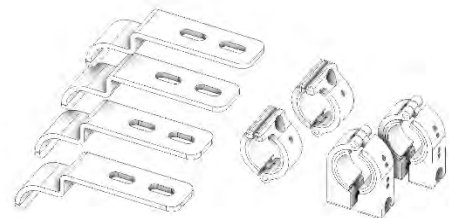
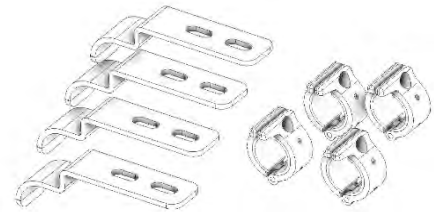
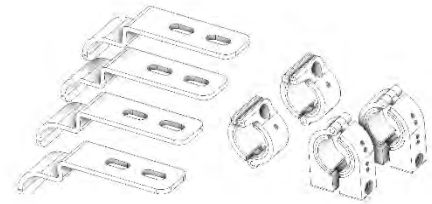
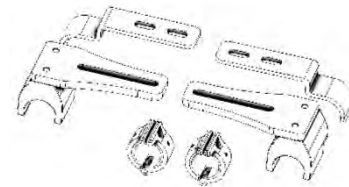
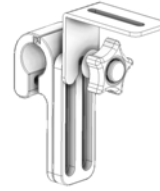
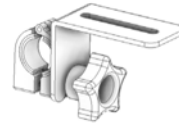

Choose  
Seat/Back Hinge  
when specifying  
the Back



# Design Custom Back

## Back Fabric Color and Type N/C

Contact	Non-Contact	
<input type="checkbox"/>	<input type="checkbox"/>	72019 72020 DARLEXX
<input type="checkbox"/>	<input type="checkbox"/>	72066 72067 DARTEX SMOOTH SIDE OUT
<input type="checkbox"/>	<input type="checkbox"/>	72064 72069 MESH FABRIC (TheraVent)
<input type="checkbox"/>	<input type="checkbox"/>	71006 72068 DARTEX KNIT SIDE OUT
<input type="checkbox"/>	<input type="checkbox"/>	72070 72071 2MM KNIT NEOPRENE
<input type="checkbox"/>	<input type="checkbox"/>	72072 72073 BLACK VINYL
<input type="checkbox"/>	<input type="checkbox"/>	72074 71037 RED VINYL
<input type="checkbox"/>	<input type="checkbox"/>	72075 71038 GREY VINYL
<input type="checkbox"/>	<input type="checkbox"/>	72076 71039 PINK VINYL
<input type="checkbox"/>	<input type="checkbox"/>	72077 71040 YELLOW VINYL
<input type="checkbox"/>	<input type="checkbox"/>	72078 71041 PURPLE VINYL
<input type="checkbox"/>	<input type="checkbox"/>	72079 71042 BLUE VINYL
<input type="checkbox"/>	<input type="checkbox"/>	72080 71043 GREEN VINYL
<input type="checkbox"/>	<input type="checkbox"/>	72081 71044 TEAL VINYL
<input type="checkbox"/>	<input type="checkbox"/>	72082 71045 RASPBERRY VINYL
<input type="checkbox"/>	<input type="checkbox"/>	72085 72092 MONSTER GREEN VINYL
<input type="checkbox"/>	<input type="checkbox"/>	72086 72093 ORANGESICLE VINYL
<input type="checkbox"/>	<input type="checkbox"/>	72087 72094 VERY CHERRY VINYL
<input type="checkbox"/>	<input type="checkbox"/>	72088 72095 FIZZY COLA VINYL
<input type="checkbox"/>	<input type="checkbox"/>	72089 72096 ISLAND BLUE VINYL
<input type="checkbox"/>	<input type="checkbox"/>	72090 72097 CINNAMON SPICE VINYL
<input type="checkbox"/>	<input type="checkbox"/>	72091 72098 PRETTY IN PINK VINYL

### Choose Back Fit

- Drop In Back (Equals Chair width minus 2.75")
- Full Width Back (Same as wheelchair width)

### Choose Back Type and Shape E2609

#### Base Foam and Cover - This is the most common back

- 71051 Rectangular Back including Base, Foam & Cover \$529
- 71052 T Back including Base, Foam & Cover \$529
- 71036 I Back including Base, Foam & Cover \$529

#### Base Only (Covered) - Plywood base no foam

- 71077 Rectangular Back Base Only \$529
- 71078 T Back Base Only \$529
- 71056 I Back Base Only \$529

#### Cushion Only (Covered) - No Plywood base

- 71080 Rectangular Cushion Only \$529
- 71081 T Back Cushion Only \$529
- 71079 I Back Cushion Only \$529

#### Vinyl Covered Base with Separate Cushion (Covered)

- 71075 Rectangular Base with Vinyl cover and Cushion \$798
- 71076 T Back Base with Vinyl cover and Cushion \$798
- 71073 I Back Base with Vinyl cover and Cushion \$798

### Select for Transit (Please select Back Type)

- 72055 Transit Seat (Must select Transit seat hdwr)

This dimension reduced by 2.75" if "Drop In Back" is selected

R Back Dimensions (synchronized with diagram on page 1)

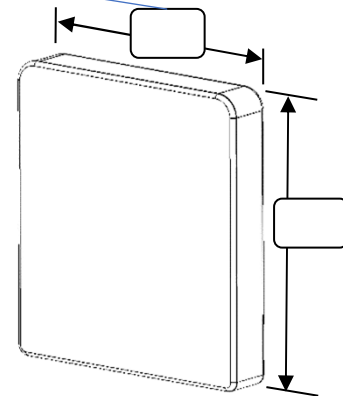

- 71073 Custom T Back Dimensions  
*select box above and input dimensions*

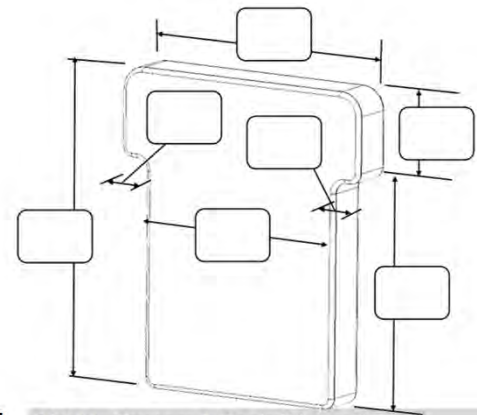

- 71011 Custom I Back Dimensions  
*select box above and input dimensions*

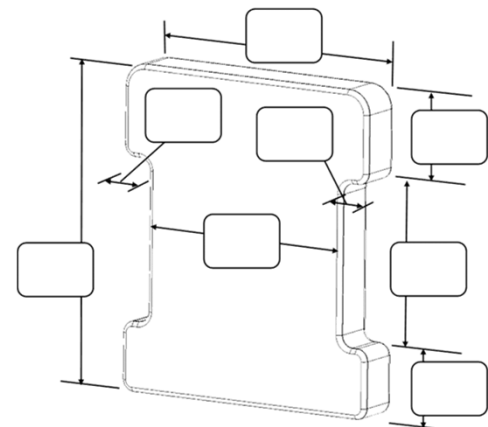

## Select Contour Modificatio

### Curved Back Modification (Base is curved)

<input type="checkbox"/>	70169	Modify Rectagular Back for Curved Base	\$205
<input type="checkbox"/>	70167	Modify T Back for Curved Base	\$263
<input type="checkbox"/>	70166	Modify I Back for Curved Base	\$278

### Contoured (Curved) Foam Modification (Base is flat)

<input type="checkbox"/>	71002	Modify with 1/2" Contour	\$79
<input type="checkbox"/>	71003	Modify with 1" Contour	\$116
<input type="checkbox"/>	71004	Modify with Full Contour	\$126

### Bi-Angular Back

<input type="checkbox"/>	71050	Bi-Angular Back Modification	\$402
--------------------------	-------	------------------------------	-------

### Scapular Relief (Cutouts)

<input type="checkbox"/>	71035	Scapular Relief Modification	\$158
--------------------------	-------	------------------------------	-------

### Sacral Buildup

<input type="checkbox"/>	72059	Sacral Buildup Modification	N/C
--------------------------	-------	-----------------------------	-----

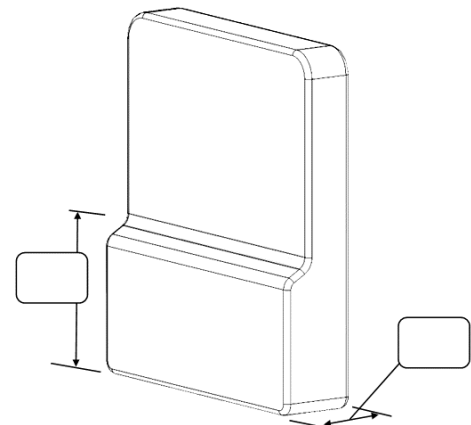
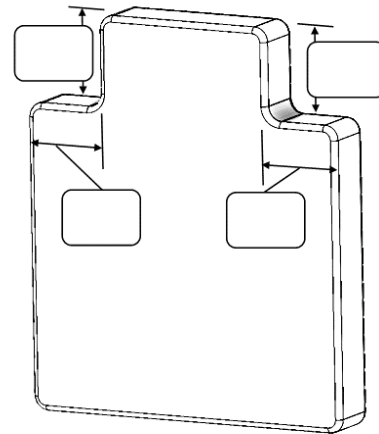
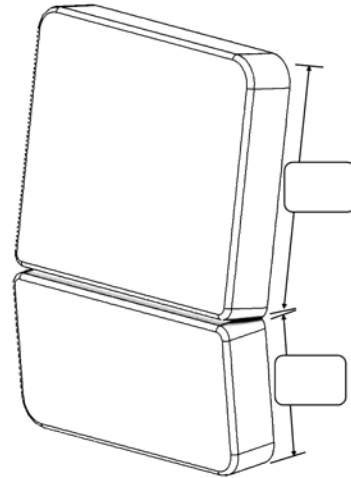



## Foam Modifications

### Standard Foam

<input type="checkbox"/>	Standard Foam: 1 1/2" soft (visco)	\$0
--------------------------	------------------------------------	-----

### Substitute Foam

<input type="checkbox"/>	72062 Use Poly Foam Instead of Visco Foam	\$0
<input type="checkbox"/>	1/2"	
<input type="checkbox"/>	1"	
<input type="checkbox"/>	1 1/2"	
<input type="checkbox"/>	2"	

### Additional Foam

<input type="checkbox"/>	71016 Additional 1/2" Visco Foam	\$79
<input type="checkbox"/>	XX-Soft T-Foam	
<input type="checkbox"/>	X-Soft	
<input type="checkbox"/>	Soft	
<input type="checkbox"/>	Medium	
<input type="checkbox"/>	71017 Additional 1" Visco Foam	\$116
<input type="checkbox"/>	XX-Soft T-Foam	
<input type="checkbox"/>	X-Soft	
<input type="checkbox"/>	Soft	
<input type="checkbox"/>	Medium	
<input type="checkbox"/>	71018 Additional 1/2" Pudgee Type Visco Foam	\$192
<input type="checkbox"/>	71019 Additional 1" Pudgee Type Visco Foam	\$247
<input type="checkbox"/>	71020 1/2" Gel Overlay, Flat	\$247
<input type="checkbox"/>	71095 1/2" Gel Overlay, Cubed	\$279

*\* note if gel is greater than 18x18 additional charges a,*

### Foam Modifications

<input type="checkbox"/>	71032 Mushroom Foam for Back	\$247
<input type="checkbox"/>	71074 Grid Foam, 2"	\$378
<input type="checkbox"/>	71091 Grid Foam, 3"	\$415
<input type="checkbox"/>	50224 1/2 Unit Foam In Place Kit (w/bag)	\$110
<input type="checkbox"/>	50226 1 Unit Foam In Place Kit (w/bag)	\$219
<input type="checkbox"/>	50228 1 1/2 Unit Foam In Place Kit (w/bag)	\$274

*Standard foam used with Foam-in-Place Kits = 1" soft visco glued to*

### Custom Foam Layering

Top Layer

Middle Layer

Bottom Layer

### Custom Foam Layering Choices

None		
70179	1/2" XX-SOFT T-FOAM	\$75
70180	1/2" X-SOFT VISCO FOAM	\$75
70181	1/2" SOFT VISCO FOAM	\$75
70182	1/2" MEDIUM VISCO FOAM	\$75
70183	1/2" SOFT POLY FOAM	\$0
70184	1/2" FIRM POLY FOAM	\$0
70185	1" XX-SOFT T-FOAM	\$110
70186	1" X-SOFT VISCO FOAM	\$110
70187	1" SOFT VISCO FOAM	\$110
70188	1" MEDIUM VISCO FOAM	\$110
70189	1" FIRM VISCO FOAM	\$110
70190	1" SOFT POLY FOAM	\$0
70191	1" FIRM POLY FOAM	\$0

**Select Foam-In-Place Cover  
Modification In Cover Modification  
Section**

*All foam up to 2" total thickness is included in base price of seat. Cost for custom foams is **only** applied when total thickness is greater than 2"*

## Cover Modifications

### Cover Modifications

<input type="checkbox"/>	71007	Foam-In_Place Cover (Specify Cover thickness)	\$93
<input type="checkbox"/>	72056	Dureflex Liner	\$69
<input type="checkbox"/>	50251	Additional Cover for Back (Identical cover)	\$275
<input type="checkbox"/>		Top Zipper Placement	N/C
<input type="checkbox"/>	71005	Bottom Zipper Placement	N/C

### Other Modifications

<input type="checkbox"/>	71025	Attach Channels to Back ( <i>Channels Selected Below</i> )	\$93
<input type="checkbox"/>	50080	Spreader Bar	\$66
<input type="checkbox"/>	50067	Channel, Back 6" Pair	\$153
<input type="checkbox"/>	50068	Channel, Back 7" Pair	\$153
<input type="checkbox"/>	50069	Channel, Back 8" Pair	\$153
<input type="checkbox"/>	50045	Channel, Back 10" Pair	\$153
<input type="checkbox"/>	50070	Channel, Back 9" Pair	\$153
<input type="checkbox"/>	50071	Channel, Back 11" Pair	\$153
<input type="checkbox"/>	50072	Channel, Back 12" Pair	\$153
<input type="checkbox"/>	50073	Channel, Back 13" Pair	\$153
<input type="checkbox"/>	50074	Channel, Back 14" Pair	\$153
<input type="checkbox"/>	50075	Channel, Back 15" Pair	\$153
<input type="checkbox"/>	50076	Channel, Back 16" Pair	\$153
<input type="checkbox"/>	50077	Channel, Back 17" Pair	\$153
<input type="checkbox"/>	50078	Channel, Back 18" Pair	\$153
<input type="checkbox"/>	50079	Channel, Back 19" Pair	\$153

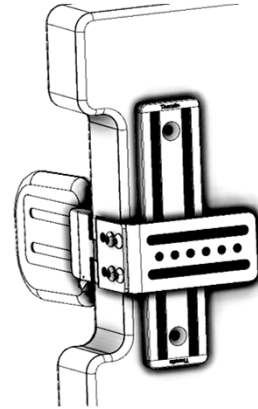

## Back Mounting Hardware

### Hardware WITH Seat/Back Hinge

#### FLUSH Seat/Back Hinge (qty 2) (Incl with E2617)

##### Molded J&L

<input type="checkbox"/>	51097	Molded J&Ls w/ Flush Hinges	\$ 268
--------------------------	-------	-----------------------------	--------

##### 2 Knob Hardware

<input type="checkbox"/>	50460	2 Knob w/ Flush Hinges	\$ 413
--------------------------	-------	------------------------	--------

##### 2 Knob Hardware for Curved Back (C

Back width			
12-13	<input type="checkbox"/>	50732	2 Knob w/ Flush Hinges (Curved Back) \$ 470
14-15	<input type="checkbox"/>	50740	2 Knob w/ Flush Hinges (Curved Back) \$ 470
16-17	<input type="checkbox"/>	50748	2 Knob w/ Flush Hinges (Curved Back) \$ 470
17-18	<input type="checkbox"/>	50756	2 Knob w/ Flush Hinges (Curved Back) \$ 470

##### 2 Knob Hardware TRANSIT

<input type="checkbox"/>	51082	2 Knob Transit w/ Flush Hinges	\$ 448
--------------------------	-------	--------------------------------	--------

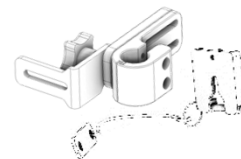
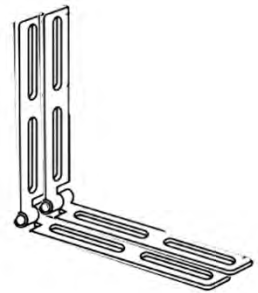
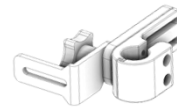
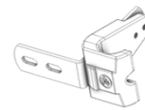

**OFFSET Seat/Back Hinge: 2" Rise, 1" O/S (Incl with E2617)**

**Molded J&L**

<input type="checkbox"/>	51098	Molded J&Ls w/2" Rise, 1" O/S Hinge	\$ 268
--------------------------	-------	-------------------------------------	--------

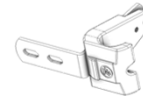

**2 Knob Hardware**

<input type="checkbox"/>	50461	2 Knob w/2" Rise, 1" O/S Hinge	\$ 413
--------------------------	-------	--------------------------------	--------

**2 Knob Hardware for Curved Back (C)**

*Back width*

12-13	<input type="checkbox"/>	50733	2 Knob w/2" Rise, 1" O/S Hinge	\$ 470
-------	--------------------------	-------	--------------------------------	--------

14-15	<input type="checkbox"/>	50741	2 Knob w/2" Rise, 1" O/S Hinge	\$ 470
-------	--------------------------	-------	--------------------------------	--------

16-17	<input type="checkbox"/>	50749	2 Knob w/2" Rise, 1" O/S Hinge	\$ 470
-------	--------------------------	-------	--------------------------------	--------

17-18	<input type="checkbox"/>	50757	2 Knob w/2" Rise, 1" O/S Hinge	\$ 470
-------	--------------------------	-------	--------------------------------	--------

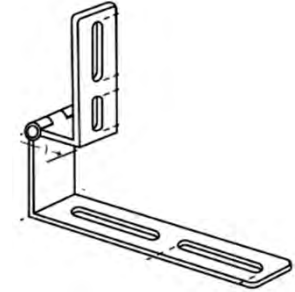
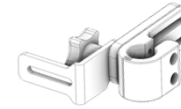

**2 Knob Hardware TRANSIT**

<input type="checkbox"/>	51083	2 Knob Transit w/2" Rise, 1" O/S Hinge	\$ 448
--------------------------	-------	--	--------

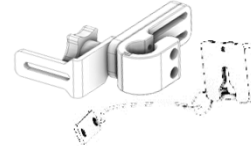

**OFFSET Seat/Back Hinge: 2" Rise, 2" O/S (Incl with E2617)**

**Molded J&L**

<input type="checkbox"/>	51099	Molded J&Ls w/2" Rise, 2" O/S Hinge	\$ 268
--------------------------	-------	-------------------------------------	--------

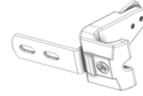

**2 Knob Hardware**

<input type="checkbox"/>	50462	2 Knob w/2" Rise, 2" O/S Hinge	\$ 413
--------------------------	-------	--------------------------------	--------

**2 Knob Hardware for Curved Back (C)**

*Back width*

12-13	<input type="checkbox"/>	50734	2 Knob w/2" Rise, 2" O/S Hinge	\$ 470
-------	--------------------------	-------	--------------------------------	--------

14-15	<input type="checkbox"/>	50742	2 Knob w/2" Rise, 2" O/S Hinge	\$ 470
-------	--------------------------	-------	--------------------------------	--------

16-17	<input type="checkbox"/>	50750	2 Knob w/2" Rise, 2" O/S Hinge	\$ 470
-------	--------------------------	-------	--------------------------------	--------

17-18	<input type="checkbox"/>	50758	2 Knob w/2" Rise, 2" O/S Hinge	\$ 470
-------	--------------------------	-------	--------------------------------	--------

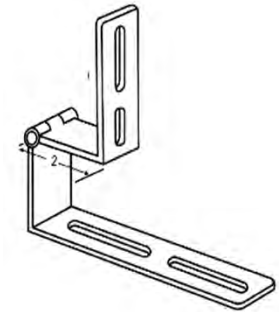
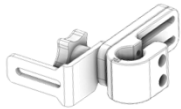

**2 Knob Hardware TRANSIT**

<input type="checkbox"/>	51084	2 Knob Transit w/2" Rise, 2" O/S Hinge	\$ 448
--------------------------	-------	--	--------

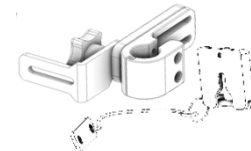

**OFFSET Seat/Back Hinge: 2" Rise, 3" O/S (Incl with E2617)**

**Molded J&L**

<input type="checkbox"/>	51100	Molded J&Ls w/2" Rise, 3" O/S Hinge	\$ 268
--------------------------	-------	-------------------------------------	--------

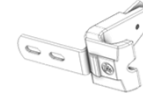

**2 Knob Hardware**

<input type="checkbox"/>	50463	2 Knob w/2" Rise, 3" O/S Hinge	\$ 413
--------------------------	-------	--------------------------------	--------

**2 Knob Hardware for Curved Back (C)**

*Back width*

12-13	<input type="checkbox"/>	50735	2 Knob w/2" Rise, 3" O/S Hinge	\$ 470
-------	--------------------------	-------	--------------------------------	--------

14-15	<input type="checkbox"/>	50743	3 Knob w/2" Rise, 3" O/S Hinge	\$ 470
-------	--------------------------	-------	--------------------------------	--------

16-17	<input type="checkbox"/>	50751	2 Knob w/2" Rise, 3" O/S Hinge	\$ 470
-------	--------------------------	-------	--------------------------------	--------

17-18	<input type="checkbox"/>	50759	2 Knob w/2" Rise, 3" O/S Hinge	\$ 470
-------	--------------------------	-------	--------------------------------	--------

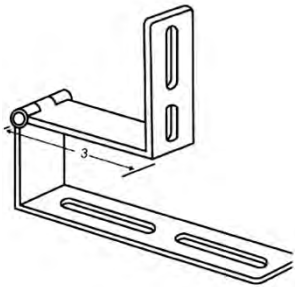
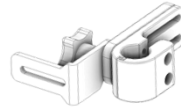

**2 Knob Hardware TRANSIT**

<input type="checkbox"/>	51085	2 Knob Transit w/2" Rise, 3" O/S Hinge	\$ 448
--------------------------	-------	--	--------

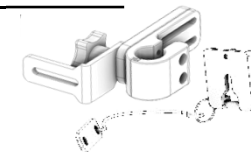

**OFFSET Seat/Back Hinge: 3" Rise, 1" O/S (Incl with E2617)**

**Molded J&L**

<input type="checkbox"/>	51102	Molded J&Ls w/3" Rise, 1" O/S Hinge	\$ 268
--------------------------	-------	-------------------------------------	--------

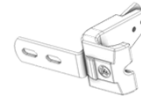

**2 Knob Hardware**

<input type="checkbox"/>	50464	2 Knob w/3" Rise, 1" O/S Hinge	\$ 413
--------------------------	-------	--------------------------------	--------

**2 Knob Hardware for Curved Back (C**

*Back width*

12-13	<input type="checkbox"/>	50736	2 Knob w/3" Rise, 1" O/S Hinge	\$ 470
-------	--------------------------	-------	--------------------------------	--------

14-15	<input type="checkbox"/>	50744	2 Knob w/3" Rise, 1" O/S Hinge	\$ 470
-------	--------------------------	-------	--------------------------------	--------

16-17	<input type="checkbox"/>	50752	2 Knob w/3" Rise, 1" O/S Hinge	\$ 470
-------	--------------------------	-------	--------------------------------	--------

17-18	<input type="checkbox"/>	50760	2 Knob w/3" Rise, 1" O/S Hinge	\$ 470
-------	--------------------------	-------	--------------------------------	--------

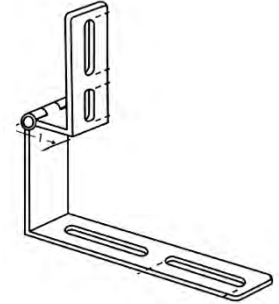
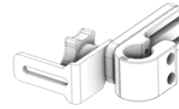

**2 Knob Hardware TRANSIT**

<input type="checkbox"/>	51086	2 Knob Transit w/3" Rise, 1" O/S Hinge	\$ 448
--------------------------	-------	--	--------

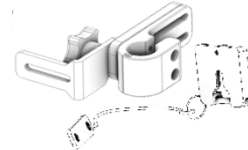

**OFFSET Seat/Back Hinge: 3" Rise, 2" O/S (Incl with E2617)**

**Molded J&L**

<input type="checkbox"/>	51103	Molded J&Ls w/3" Rise, 2" O/S Hinge	\$ 268
--------------------------	-------	-------------------------------------	--------

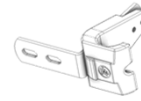

**2 Knob Hardware**

<input type="checkbox"/>	50465	2 Knob w/3" Rise, 2" O/S Hinge	\$ 413
--------------------------	-------	--------------------------------	--------

**2 Knob Hardware for Curved Back (C**

*Back width*

12-13	<input type="checkbox"/>	50737	2 Knob w/3" Rise, 2" O/S Hinge	\$ 470
-------	--------------------------	-------	--------------------------------	--------

14-15	<input type="checkbox"/>	50745	2 Knob w/3" Rise, 2" O/S Hinge	\$ 470
-------	--------------------------	-------	--------------------------------	--------

16-17	<input type="checkbox"/>	50753	2 Knob w/3" Rise, 2" O/S Hinge	\$ 470
-------	--------------------------	-------	--------------------------------	--------

17-18	<input type="checkbox"/>	50761	2 Knob w/3" Rise, 2" O/S Hinge	\$ 470
-------	--------------------------	-------	--------------------------------	--------

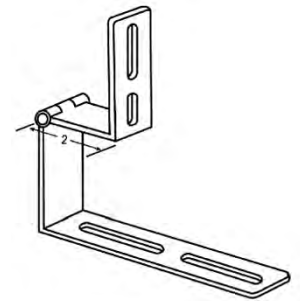
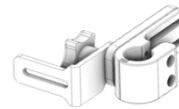

**2 Knob Hardware TRANSIT**

<input type="checkbox"/>	51087	2 Knob Transit w/3" Rise, 2" O/S Hinge	\$ 448
--------------------------	-------	--	--------

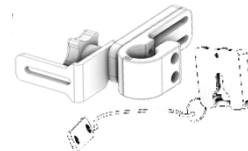

**OFFSET Seat/Back Hinge: 3" Rise, 3" O/S (Incl with E2617)**

**Molded J&L**

<input type="checkbox"/>	51104	Molded J&Ls w/3" Rise, 3" O/S Hinge	\$ 268
--------------------------	-------	-------------------------------------	--------

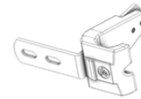

**2 Knob Hardware**

<input type="checkbox"/>	50466	2 Knob w/3" Rise, 3" O/S Hinge	\$ 413
--------------------------	-------	--------------------------------	--------

**2 Knob Hardware for Curved Back (C**

*Back width*

12-13	<input type="checkbox"/>	50738	2 Knob w/3" Rise, 3" O/S Hinge	\$ 470
-------	--------------------------	-------	--------------------------------	--------

14-15	<input type="checkbox"/>	50746	2 Knob w/3" Rise, 3" O/S Hinge	\$ 470
-------	--------------------------	-------	--------------------------------	--------

16-17	<input type="checkbox"/>	50754	2 Knob w/3" Rise, 3" O/S Hinge	\$ 470
-------	--------------------------	-------	--------------------------------	--------

17-18	<input type="checkbox"/>	50762	2 Knob w/3" Rise, 3" O/S Hinge	\$ 470
-------	--------------------------	-------	--------------------------------	--------

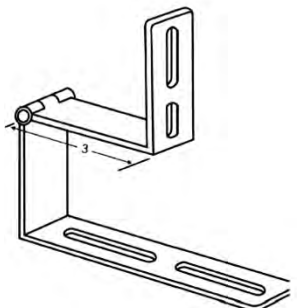
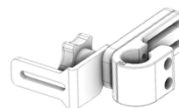

**2 Knob Hardware TRANSIT**

<input type="checkbox"/>	51088	2 Knob Transit w/3" Rise, 3" O/S Hinge	\$ 448
--------------------------	-------	--	--------

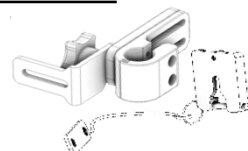

**OFFSET Seat/Back Hinge: 2.5" Rise, Adjustable O/S (Incl with E2617)**

**Molded J&L**

- 51101 Molded J&Ls w/2.5" Rise, Adj O/S Hin \$ 441

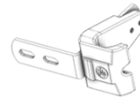

**2 Knob Hardware**

- 51093 2 Knob w/2.5" Rise, Adj O/S Hinge \$ 525

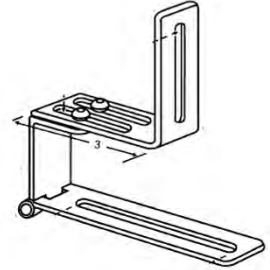
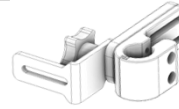

**2 Knob Hardware TRANSIT**

- 51090 2 Knob Transit w/2.5 Rise, Adj O/S Hin; \$ 593

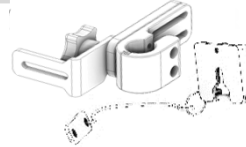

**OFFSET 2 Seat/Back Hinges: 2.5" Rise, Adjustable O/S (Incl with E2617)**

**2 Knob Hardware**

- 51092 2 Knob w/2.5" Rise, Adj O/S Hinge \$ 525

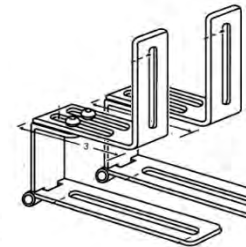
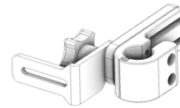

**2 Knob Hardware TRANSIT**

- 51089 2 Knob w/2.5" Rise, Adj O/S Hinge \$ 593



**Hardware WITHOUT Seat/Back Hinge**

**4 Knob Hardware (Incl with E2617)**

**4 Knob Hardware**

- 50473 4 Knob Hardware \$ 475

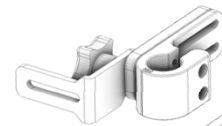

*Back width*

**4 Knob Hardware for Curved Back (C**

- |       |                          |       |                               |        |
|-------|--------------------------|-------|-------------------------------|--------|
| 12-13 | <input type="checkbox"/> | 50739 | 4 Knob Hardware (Curved Back) | \$ 540 |
| 14-15 | <input type="checkbox"/> | 50747 | 4 Knob Hardware (Curved Back) | \$ 540 |
| 16-17 | <input type="checkbox"/> | 50755 | 4 Knob Hardware (Curved Back) | \$ 540 |
| 17-18 | <input type="checkbox"/> | 50763 | 4 Knob Hardware (Curved Back) | \$ 540 |

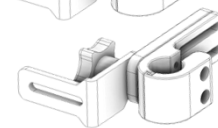

**4 Knob Hardware TRANSIT**

- 51076 4 Knob Transit \$ 655

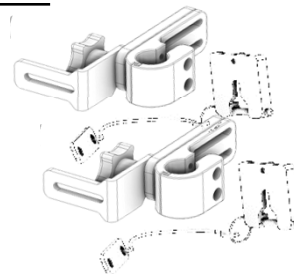

**4 Molded J and L Hardware (Incl with E2617)**

- 50475 Slotted L Brackets, w/ Swingtabs \$ 268
- 50499 Heavy Duty, w/ Swingtabs \$ 297
- 50469 Long Slotted L Brackets, w/ Swingtabs \$ 340

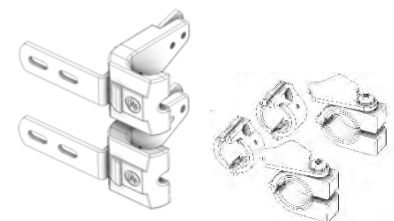

## Drop Hook Kits

### w/2 Rail Locks & 2 Hinged Swing Collars (Incl with E2609)

7/8" Tubing	<input type="checkbox"/>	50290	6 Hole Ls & 2 Hole Js	\$ 181
	<input type="checkbox"/>	50291	6 Hole Ls & 4 Hole Js	\$ 181
	<input type="checkbox"/>	50297	6 Hole Ls & 6 Hole Js	\$ 181
	<input type="checkbox"/>	50329	10 Hole Ls & 2 Hole Js	\$ 181
	<input type="checkbox"/>	50331	2 Hole Set Lock Ls & 6 Hole Js	\$ 181
	<input type="checkbox"/>	50333	5 Hole Set Lock Ls & 6 Hole Js	\$ 181
1" Tubing	<input type="checkbox"/>	50295	6 Hole Ls & 2 Hole Js	\$ 181
	<input type="checkbox"/>	50292	6 Hole Ls & 4 Hole Js	\$ 181
	<input type="checkbox"/>	50296	6 Hole Ls & 6 Hole Js	\$ 181
	<input type="checkbox"/>	50330	10 Hole Ls & 2 Hole Js	\$ 181
	<input type="checkbox"/>	50332	2 Hole Set Lock Ls & 6 Hole Js	\$ 181
	<input type="checkbox"/>	50334	5 Hole Set Lock Ls & 6 Hole Js	\$ 181
<input type="checkbox"/>	50395	Back Hardware, 7/8" & 1" Kit w/ 6 Hole Ls & 2 Hole Js w/	\$ 181	



### w/4 Rail Locks (Incl with E2609)

7/8" Tubing	<input type="checkbox"/>	50471	6 Hole Ls & 2 Hole Js	\$ 181
1" Tubing	<input type="checkbox"/>	50486	6 Hole Ls & 2 Hole Js	\$ 181

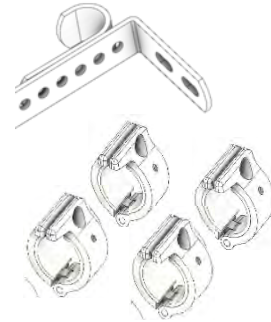

# Head Supports

## Brackets

### Multi-Axis Offset E1028

- 50215 Headrest Hardware, Multi-Axis \$255.00

### Surelock E1028

- 50218 Headrest Hardware, Surelock Square Bar \$249.00

### Flip Down E1028

- 50230 Headrest Hrdw, Flip-Down w/Ball Mount \$274.00

### Flip Down E1028

- 50229 Headrest Hrdw, Flip-Down w/Flat Mount \$274.00

### Basic Hardware E1028

- 50413 Basic w/ Short 4" Horizontal Bar \$146.00
- 50414 Basic w/ Long 7" Horizontal Bar \$146.00

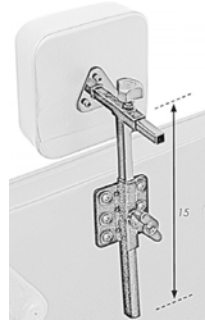
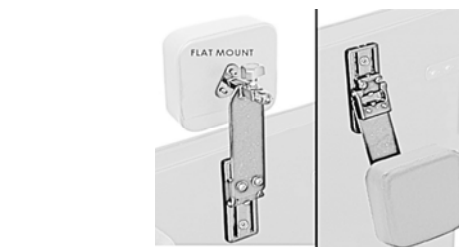
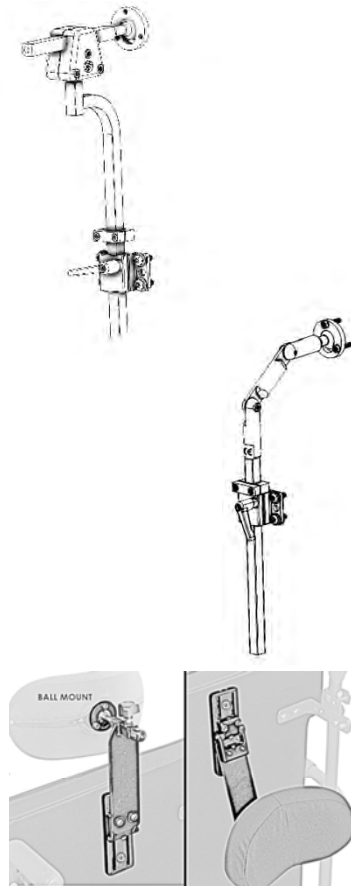

### Bracket Options K0108

- 32825 Headrest Universal Adaptor Plate \$117.00
- 32975 Headrest Hardware, Horizontal Slide Mount \$ 98.00

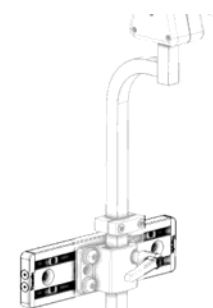
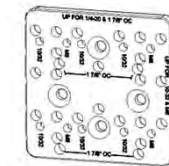



**Pads**

**Profit Adjust E0955**

<input type="checkbox"/>	50361 Pro-Fit Adjust w/ Knit Cover, Large	\$305.00
<input type="checkbox"/>	50363 Pro-Fit Adjust w/ Knit Cover, Small	\$305.00
<input type="checkbox"/>	50368 Pro-Fit Adjust w/ Smooth Cover, Small	\$305.00
<input type="checkbox"/>	50369 Pro-Fit Adjust w/ Smooth Cover, Large	\$305.00

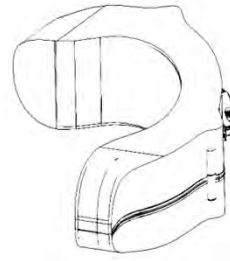

**Profit Soft Pad E0955**

<input type="checkbox"/>	50365 Pro-Fit Soft Pad w/ Smooth Cover, 5 x 8	\$157.00
<input type="checkbox"/>	50366 Pro-Fit Soft Pad w/ Smooth Cover, 5 x 10	\$157.00
<input type="checkbox"/>	50367 Pro-Fit Soft Pad w/ Smooth Cover, 5 x 14	\$157.00
<input type="checkbox"/>	50374 Pro-Fit Soft Pad w/ Knit Cover, 4 x 8	\$157.00
<input type="checkbox"/>	50375 Pro-Fit Soft Pad w/ Knit Cover, 4 x 10	\$157.00
<input type="checkbox"/>	50376 Pro-Fit Soft Pad w/ Knit Cover, 4 x 14	\$157.00

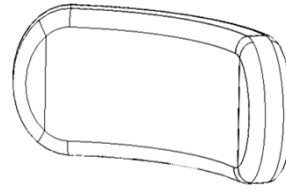

**Flat Pad E0955**

<input type="checkbox"/>	50477 Headrest Pad, Flat w/ Smooth Cover, 5" x 5"	\$147.00
<input type="checkbox"/>	50478 Headrest Pad, Flat w/ Smooth Cover, 6" x 6"	\$147.00
<input type="checkbox"/>	50479 Headrest Pad, Flat w/ Smooth Cover, 8" x 8"	\$147.00

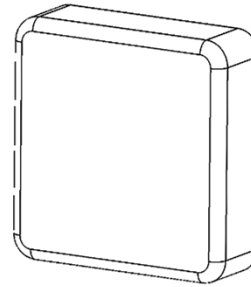

**Molded Pads E0955**

<input type="checkbox"/>	31436 Headrest Pad, Molded, Small	\$199.00
<input type="checkbox"/>	31437 Headrest Pad, Molded, Large	\$199.00
<input type="checkbox"/>	31438 Headrest Pad, Molded, Head/Neck Combo	\$194.00
<input type="checkbox"/>	32471 Headrest Pad, Molded, Lateral	\$199.00
<input type="checkbox"/>	32472 Headrest Pad, Molded, Neck	\$188.00

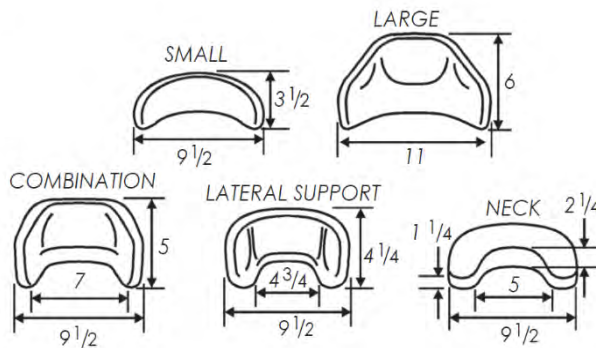

**Curved Tri-Form Headrest E0955 and K0108**

*Must select all 3 boxes*

<input type="checkbox"/>	32458C Tri-form, Center Section E0955	\$237.00
<input type="checkbox"/>	32458L Tri-form, Curved, Left Side K0108	\$199.00
<input type="checkbox"/>	32458R Tri-form, Curved, Right Side K0108	\$199.00

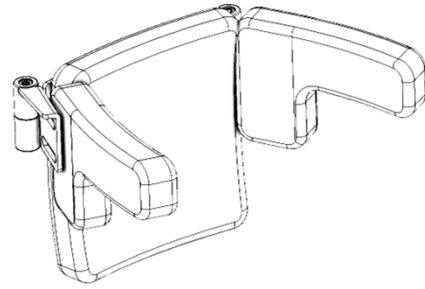

**Flat Tri-Form Headrest E0955 and K0108**

*Must select all 3 boxes*

<input type="checkbox"/>	32414C Tri-form, Center Section E0955	\$244.00
<input type="checkbox"/>	32414L Tri-form, Straight, Left Side K0108	\$160.00
<input type="checkbox"/>	32414R Tri-form, Straight, Right Side K0108	\$160.00

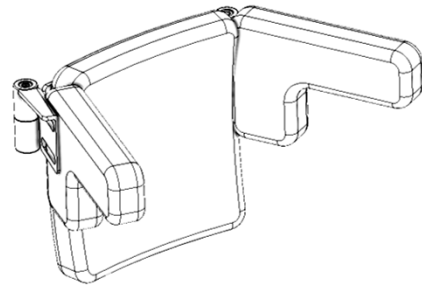

**Custom Tri-Form Headrest E0955 and K0108**

*Must select all 3 boxes*

<input type="checkbox"/>	50373C Tri-form, Custom Center Section E0955	\$237.00
<input type="checkbox"/>	50373L Tri-form, Custom Side Section, Left K0108	\$277.00
<input type="checkbox"/>	50373R Tri-form, Custom Side Section, Right K0108	\$277.00

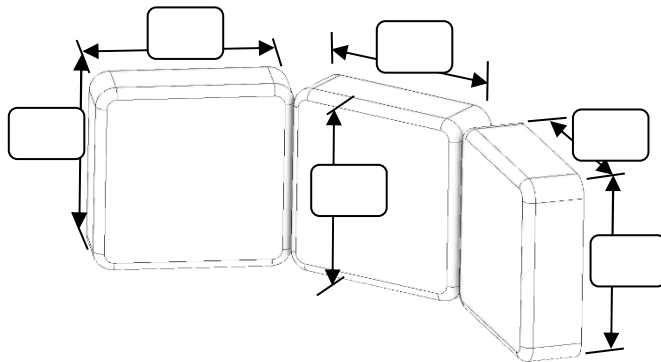
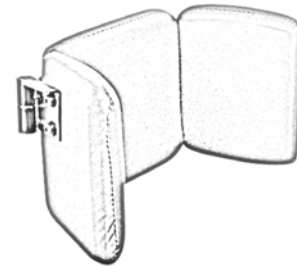

**Headrest Parts K0108**

<input type="checkbox"/>	32967 Headrest Mounting Plate w/ Lever	\$ 45.00
<input type="checkbox"/>	32477 Headrest Hardware, Surelock Extension Bar	\$103.00

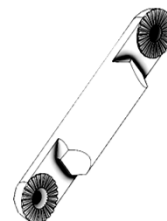
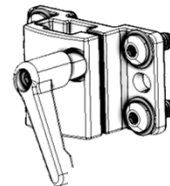

## Lateral Thoracic Supports

### VALUE Lateral Thoracic Pad E0956 Ea.

#### FLAT

*These pads have Black Smooth Dartex Face and Neoprene Knit Back Side*

#### LEFT

#### RIGHT

*Molded Pads are self skinning molded foam with Neoprene cover*

<input type="checkbox"/>	None	<input type="checkbox"/>	None		
<input type="checkbox"/>	50051	<input type="checkbox"/>	50051	3 x 4	\$ 85
<input type="checkbox"/>	50052	<input type="checkbox"/>	50052	3 x 5	\$ 85
<input type="checkbox"/>	<b>50061</b>	<input type="checkbox"/>	<b>50061</b>	<b>Molded, 3x6</b>	<b>\$ 85</b>
<input type="checkbox"/>	50053	<input type="checkbox"/>	50053	4 x 5	\$ 85
<input type="checkbox"/>	50054	<input type="checkbox"/>	50054	4 x 6	\$ 85
<input type="checkbox"/>	<b>50141</b>	<input type="checkbox"/>	<b>50141</b>	<b>Gel, 4x6</b>	<b>\$ 96</b>
<input type="checkbox"/>	<b>50062</b>	<input type="checkbox"/>	<b>50062</b>	<b>Molded, 4x7</b>	<b>\$ 85</b>
<input type="checkbox"/>	50028	<input type="checkbox"/>	50028	5 x 5	\$ 85
<input type="checkbox"/>	50038	<input type="checkbox"/>	50038	5 x 6	\$ 85

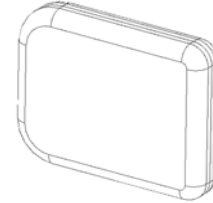

#### CURVED

*These pads have Black Smooth Dartex Face and Neoprene Knit Back Side*

#### LEFT

#### RIGHT

*Molded Pads are self skinning molded foam with Neoprene cover*

<input type="checkbox"/>	None	<input type="checkbox"/>	None		
<input type="checkbox"/>	50056	<input type="checkbox"/>	50056	3 x 4	\$ 106
<input type="checkbox"/>	50057	<input type="checkbox"/>	50057	3 x 5	\$ 106
<input type="checkbox"/>	<b>50064</b>	<input type="checkbox"/>	<b>50064</b>	<b>Molded, 3x6</b>	<b>\$ 100</b>
<input type="checkbox"/>	50058	<input type="checkbox"/>	50058	4 x 5	\$ 106
<input type="checkbox"/>	50059	<input type="checkbox"/>	50059	4 x 6	\$ 106
<input type="checkbox"/>	<b>50142</b>	<input type="checkbox"/>	<b>50142</b>	<b>Gel, 4 x 6</b>	<b>\$ 119</b>
<input type="checkbox"/>	<b>50065</b>	<input type="checkbox"/>	<b>50065</b>	<b>Molded, 4x7</b>	<b>\$ 100</b>
<input type="checkbox"/>	50029	<input type="checkbox"/>	50029	5 x 5	\$ 106
<input type="checkbox"/>	50039	<input type="checkbox"/>	50039	5 x 6	\$ 106

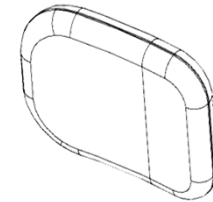

### NEOPRENE/VINYL Lateral Thoracic Pad E0956 Ea.

#### FLAT

*These pads have Black Neoprene Face and Vinyl Back Side*

#### LEFT

#### RIGHT

<input type="checkbox"/>	None	<input type="checkbox"/>	None		
<input type="checkbox"/>	50766	<input type="checkbox"/>	50766	4 x 4 (.25" thick foam)	\$ 85
<input type="checkbox"/>	50767	<input type="checkbox"/>	50767	4 x 4.5 (.25" thick foam)	\$ 85
<input type="checkbox"/>	50765	<input type="checkbox"/>	50765	4 x 4.5	\$ 85

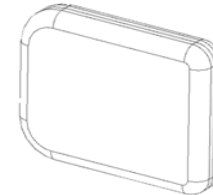

### TRU SPEC Lateral Thoracic Pad E0956 Ea.

#### FLAT

*These pads can have custom fabrics and colors*

#### LEFT

#### RIGHT

*Select fabrics and colors on next page*

<input type="checkbox"/>	None	<input type="checkbox"/>	None		
<input type="checkbox"/>	50600	<input type="checkbox"/>	50600	3 x 4	\$ 118
<input type="checkbox"/>	50601	<input type="checkbox"/>	50601	3 x 5	\$ 118
<input type="checkbox"/>	50602	<input type="checkbox"/>	50602	4 x 5	\$ 118
<input type="checkbox"/>	50603	<input type="checkbox"/>	50603	4 x 6	\$ 118
<input type="checkbox"/>	50604	<input type="checkbox"/>	50604	5 x 5	\$ 118
<input type="checkbox"/>	50605	<input type="checkbox"/>	50605	5 x 6	\$ 118



#### CURVED

*These pads can have custom fabrics and colors*

#### LEFT

#### RIGHT

*Select fabrics and colors on next page*

<input type="checkbox"/>	None	<input type="checkbox"/>	None		
<input type="checkbox"/>	50610	<input type="checkbox"/>	50610	3 x 4	\$ 118
<input type="checkbox"/>	50611	<input type="checkbox"/>	50611	3 x 5	\$ 118
<input type="checkbox"/>	50612	<input type="checkbox"/>	50612	4 x 5	\$ 118
<input type="checkbox"/>	50613	<input type="checkbox"/>	50613	4 x 6	\$ 118
<input type="checkbox"/>	50614	<input type="checkbox"/>	50614	5 x 5	\$ 118
<input type="checkbox"/>	50615	<input type="checkbox"/>	50615	5 x 6	\$ 118

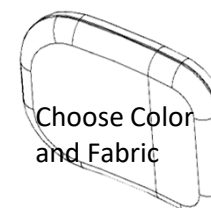

## CUSTOM Lateral Thoracic Pad E0956 Ea.

LEFT	RIGHT	<i>For Custom Pad select fabrics and colors below</i>	
<input type="checkbox"/> None	<input type="checkbox"/> None		
<input type="checkbox"/> 50055	<input type="checkbox"/> 50055	<b>Flat Custom Pad</b>	\$ 145
<input type="checkbox"/> 50060	<input type="checkbox"/> 50060	<b>Curved Custom Pad</b>	\$ 169

LEFT

RIGHT

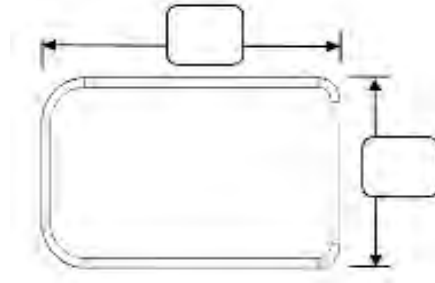
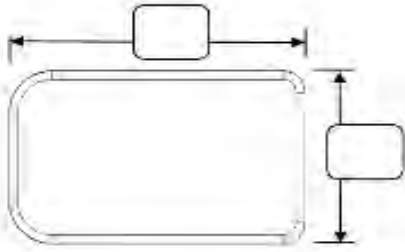

### Pad Modifications Ea.

<input type="checkbox"/> 71068	Modification Extra Foam	\$ 26
	<input type="checkbox"/> XX-Soft	
	<input type="checkbox"/> X-Soft	
	<input type="checkbox"/> Soft	
	<input type="checkbox"/> Medium	
<input type="checkbox"/> 71067	Modification add Gel 1/4"	\$ 39
<input type="checkbox"/> 71092	Modification add 1/2" Pudgee Foam	\$ 37
<input type="checkbox"/> 71069	Mushroom Foam on Pad	\$ 39

### Custom Foam Layering

Top Layer

Middle Layer

#### Custom Foam Layering Choices

None		
70179	1/2" XX-SOFT T-FOAM	\$75
70180	1/2" X-SOFT VISCO FOAM	\$75
70181	1/2" SOFT VISCO FOAM	\$75
70182	1/2" MEDIUM VISCO FOAM	\$75
70183	1/2" SOFT POLY FOAM	\$0
70184	1/2" FIRM POLY FOAM	\$0
70185	1" XX-SOFT VISCO FOAM	\$110
70186	1" X-SOFT T-FOAM	\$110
70187	1" SOFT VISCO FOAM	\$110
70188	1" MEDIUM VISCO FOAM	\$110
70189	1" FIRM VISCO FOAM	\$110
70190	1" SOFT POLY FOAM	\$0
70191	1" FIRM POLY FOAM	\$0

## Lateral Thoracic Pad Fabric Color and Type

N/C

Contact	Non-Contact	
<input type="checkbox"/> 72019	<input type="checkbox"/> 72020	DARLEXX
<input type="checkbox"/> 72066	<input type="checkbox"/> 72067	DARTEX SMOOTH SIDE OUT
<input type="checkbox"/> 72064	<input type="checkbox"/> 72069	MESH FABRIC (TheraVent)
<input type="checkbox"/> 71006	<input type="checkbox"/> 72068	DARTEX KNIT SIDE OUT
<input type="checkbox"/> 72070	<input type="checkbox"/> 72071	2MM KNIT NEOPRENE
<input type="checkbox"/> 72072	<input type="checkbox"/> 72073	BLACK VINYL
<input type="checkbox"/> 72074	<input type="checkbox"/> 71037	RED VINYL
<input type="checkbox"/> 72075	<input type="checkbox"/> 71038	GREY VINYL
<input type="checkbox"/> 72076	<input type="checkbox"/> 71039	PINK VINYL
<input type="checkbox"/> 72077	<input type="checkbox"/> 71040	YELLOW VINYL
<input type="checkbox"/> 72078	<input type="checkbox"/> 71041	PURPLE VINYL
<input type="checkbox"/> 72079	<input type="checkbox"/> 71042	BLUE VINYL
<input type="checkbox"/> 72080	<input type="checkbox"/> 71043	GREEN VINYL
<input type="checkbox"/> 72081	<input type="checkbox"/> 71044	TEAL VINYL
<input type="checkbox"/> 72082	<input type="checkbox"/> 71045	RASPBERRY VINYL
<input type="checkbox"/> 72085	<input type="checkbox"/> 72092	MONSTER GREEN VINYL
<input type="checkbox"/> 72086	<input type="checkbox"/> 72093	ORANGESICLE VINYL
<input type="checkbox"/> 72087	<input type="checkbox"/> 72094	VERY CHERRY VINYL
<input type="checkbox"/> 72088	<input type="checkbox"/> 72095	FIZZY COLA VINYL
<input type="checkbox"/> 72089	<input type="checkbox"/> 72096	ISLAND BLUE VINYL
<input type="checkbox"/> 72090	<input type="checkbox"/> 72097	CINNAMON SPICE VINYL
<input type="checkbox"/> 72091	<input type="checkbox"/> 72098	PRETTY IN PINK VINYL
<input type="checkbox"/> 73006	<input type="checkbox"/> 73008	2.5MM SMOOTH NEOPRENE
<input type="checkbox"/> 73007	<input type="checkbox"/> 73009	2.5MM KNIT NEOPRENE

### Fixed Bracket Each E0956 (Must select Flat Pad)

LEFT	RIGHT		
<input type="checkbox"/> None	<input type="checkbox"/> None		
<input type="checkbox"/> 50171	<input type="checkbox"/> 50171	Flush	\$ 24
<input type="checkbox"/> 50725	<input type="checkbox"/> 50725	1/2" Offset	\$ 27
<input type="checkbox"/> 50175	<input type="checkbox"/> 50175	1" Offset	\$ 24
<input type="checkbox"/> 50166	<input type="checkbox"/> 50166	2" Offset	\$ 24

*Fixed Brackets CANNOT be used with a curved pad*

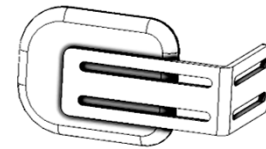

### Fixed MODULAR Bracket Each E0956 (Must select Flat Pad)

LEFT	RIGHT		
<input type="checkbox"/> None	<input type="checkbox"/> None		
<input type="checkbox"/> AssemblyLTS	<input type="checkbox"/> AssemblyLTS	Flush	\$ 119
<input type="checkbox"/> AssemblyLTS	<input type="checkbox"/> AssemblyLTS	1/2" Offset	\$ 119
<input type="checkbox"/> AssemblyLTS	<input type="checkbox"/> AssemblyLTS	1" Offset	\$ 119
<input type="checkbox"/> AssemblyLTS	<input type="checkbox"/> AssemblyLTS	2" Offset	\$ 119

*Part numbers will sometime vary depending on bracket setup needs*

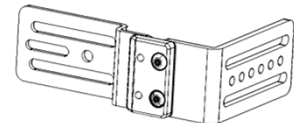

### Swing Away Hardware Each E1028

LEFT	RIGHT		
<input type="checkbox"/> None	<input type="checkbox"/> None		
<input type="checkbox"/> AssemblyLTS	<input type="checkbox"/> AssemblyLTS	Flush	\$ 211
<input type="checkbox"/> AssemblyLTS	<input type="checkbox"/> AssemblyLTS	1/2" Offset	\$ 211
<input type="checkbox"/> AssemblyLTS	<input type="checkbox"/> AssemblyLTS	1" Offset	\$ 211
<input type="checkbox"/> AssemblyLTS	<input type="checkbox"/> AssemblyLTS	2" Offset	\$ 211

*Part numbers wil sometime vary depending on bracket setup needs*

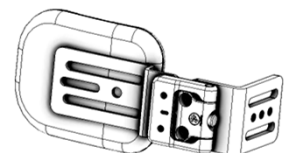

**Proximal Swing Away Hardware Each E1028**

**LEFT                      RIGHT                      *Part numbers wil sometime vary depending on bracket setup needs***

<input type="checkbox"/>	None	<input type="checkbox"/>	None	
<input type="checkbox"/>	AssemblyLTS	<input type="checkbox"/>	AssemblyLTS Flush	\$ 250
<input type="checkbox"/>	AssemblyLTS	<input type="checkbox"/>	AssemblyLTS 1/2" Offset	\$ 250
<input type="checkbox"/>	AssemblyLTS	<input type="checkbox"/>	AssemblyLTS 1" Offset	\$ 250
<input type="checkbox"/>	AssemblyLTS	<input type="checkbox"/>	AssemblyLTS 2" Offset	\$ 250

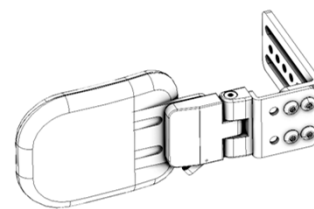

**Spacers (1/2" Each) Each K0108**

**LEFT                      RIGHT**

Qty		Qty			
	50098		50098	Spacer (1/2")	\$ 25



**Pin Style Summer/Winter Hardware Each K0108**

**LEFT                      RIGHT**

<input type="checkbox"/>	50325	<input type="checkbox"/>	50325	Summer/Winter Hardware	\$ 100
--------------------------	-------	--------------------------	-------	------------------------	--------

*(Must order channels on back)*

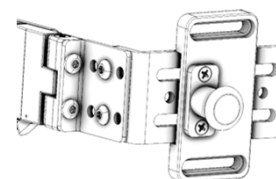

**Low Profile Summer/Winter Hardware Each K0108**

**LEFT                      RIGHT**

<input type="checkbox"/>	50324	<input type="checkbox"/>	50324	Summer/Winter Hardware	\$ 73
--------------------------	-------	--------------------------	-------	------------------------	-------

*(Must order channels on back)*

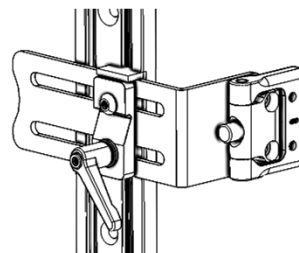

# Rear Lateral Hip Supports

For Front Setup see section several pages below

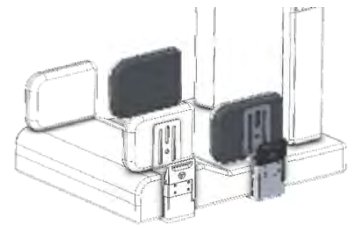

## Standard Lateral Hip Pad E0956 Ea.

LEFT	RIGHT	<i>These pads have Black Smooth Dartex Face and Neoprene Knit Back Side</i>	
<input type="checkbox"/> 50144	<input type="checkbox"/> 50144	Hip Guide, Flat, 3 x 4	\$ 83
<input type="checkbox"/> 50145	<input type="checkbox"/> 50145	Hip Guide, Flat, 3 x 5	\$ 83
<input type="checkbox"/> 50146	<input type="checkbox"/> 50146	Hip Guide, Flat, 4 x 5	\$ 83
<input type="checkbox"/> 50147	<input type="checkbox"/> 50147	Hip Guide, Flat, 4 x 6	\$ 83
<input type="checkbox"/> 50148	<input type="checkbox"/> 50148	Hip Guide, Flat, 4 x 8	\$ 83
<input type="checkbox"/> 50246	<input type="checkbox"/> 50246	Hip Guide, Flat, 4 x 10	\$ 89
<input type="checkbox"/> 50247	<input type="checkbox"/> 50247	Hip Guide, Flat, 4 x 12	\$ 89
<input type="checkbox"/> 50268	<input type="checkbox"/> 50268	Hip Guide, Flat, 4 x 14	\$ 93
<input type="checkbox"/> 50276	<input type="checkbox"/> 50276	Hip Guide, Flat, 4 x 16	\$ 93
<input type="checkbox"/> 50343	<input type="checkbox"/> 50343	Hip Guide, Flat, 4 x 18	\$ 93



## Custom Lateral Hip Pad E0956 Ea.

LEFT	RIGHT	<i>For Custom Pad select fabrics next page</i>	
<input type="checkbox"/> 73001	<input type="checkbox"/> 73001	Hip Pad, TrU-Spec Non-Contoured	\$ 121

LEFT

RIGHT

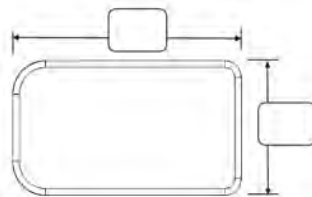
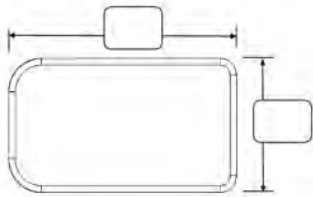

LEFT	RIGHT	<i>For Custom Pad select fabrics next page</i>	
<input type="checkbox"/> 73002	<input type="checkbox"/> 73002	Hip Guide, Custom Contoured	\$ 155

LEFT

RIGHT

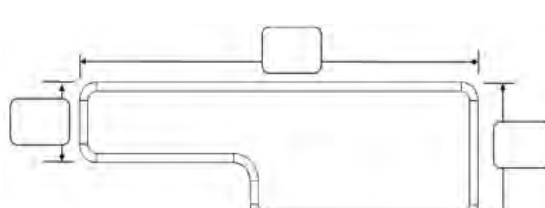
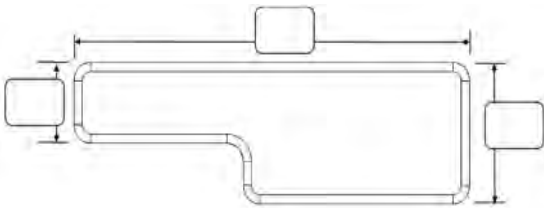

## Pad Modifications Ea.

<input type="checkbox"/> 71068	Modification Extra Foam	\$ 26
	<input type="checkbox"/> XX-Soft	
	<input type="checkbox"/> X-Soft	
	<input type="checkbox"/> Soft	
	<input type="checkbox"/> Medium	
<input type="checkbox"/> 71067	Modification add Gel 1/4"	\$ 39

Set Pad FLUSH with Front of Seat N/C

Set Pad BACK from Front Edge *Indicate distance in Box at right* N/C

Set Pad BEYOND of Front Edge *Indicate distance in Box at right* N/C

Distance

Distance



## Rear Hip Pad Fabric Color and Type

N/C

Contact	Non-Contact	
<input type="checkbox"/> 72019	<input type="checkbox"/> 72020	DARLEXX
<input type="checkbox"/> 72066	<input type="checkbox"/> 72067	DARTEX SMOOTH SIDE OUT
<input type="checkbox"/> 72064	<input type="checkbox"/> 72069	MESH FABRIC (TheraVent)
<input type="checkbox"/> 71006	<input type="checkbox"/> 72068	DARTEX KNIT SIDE OUT
<input type="checkbox"/> 72070	<input type="checkbox"/> 72071	2MM KNIT NEOPRENE
<input type="checkbox"/> 72072	<input type="checkbox"/> 72073	BLACK VINYL
<input type="checkbox"/> 72074	<input type="checkbox"/> 71037	RED VINYL
<input type="checkbox"/> 72075	<input type="checkbox"/> 71038	GREY VINYL
<input type="checkbox"/> 72076	<input type="checkbox"/> 71039	PINK VINYL
<input type="checkbox"/> 72077	<input type="checkbox"/> 71040	YELLOW VINYL
<input type="checkbox"/> 72078	<input type="checkbox"/> 71041	PURPLE VINYL
<input type="checkbox"/> 72079	<input type="checkbox"/> 71042	BLUE VINYL
<input type="checkbox"/> 72080	<input type="checkbox"/> 71043	GREEN VINYL
<input type="checkbox"/> 72081	<input type="checkbox"/> 71044	TEAL VINYL
<input type="checkbox"/> 72082	<input type="checkbox"/> 71045	RASPBERRY VINYL
<input type="checkbox"/> 72085	<input type="checkbox"/> 72092	MONSTER GREEN VINYL
<input type="checkbox"/> 72086	<input type="checkbox"/> 72093	ORANGESICLE VINYL
<input type="checkbox"/> 72087	<input type="checkbox"/> 72094	VERY CHERRY VINYL
<input type="checkbox"/> 72088	<input type="checkbox"/> 72095	FIZZY COLA VINYL
<input type="checkbox"/> 72089	<input type="checkbox"/> 72096	ISLAND BLUE VINYL
<input type="checkbox"/> 72090	<input type="checkbox"/> 72097	CINNAMON SPICE VINYL
<input type="checkbox"/> 72091	<input type="checkbox"/> 72098	PRETTY IN PINK VINYL
<input type="checkbox"/> 73006	<input type="checkbox"/> 73008	2.5MM SMOOTH NEOPRENE
<input type="checkbox"/> 73007	<input type="checkbox"/> 73009	2.5MM KNIT NEOPRENE

### Spacers (1/2" Each) Each K0108

LEFT	RIGHT	
Qty	Qty	
50098	50098	Spacer (1/2") \$ 25

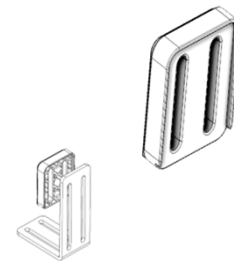

### Fixed Bracket Each E0956

LEFT	RIGHT	
<input type="checkbox"/> None	<input type="checkbox"/> None	
<input type="checkbox"/> 50171	<input type="checkbox"/> 50171	L-Bracket, Heavy Duty, 3.5 x 5 \$ 24
<input type="checkbox"/> 50172	<input type="checkbox"/> 50172	L-Bracket, Heavy Duty, 3.5 x 6 \$ 24
<input type="checkbox"/> 50173	<input type="checkbox"/> 50173	L-Bracket, Heavy Duty, 3.5 x 8 \$ 24
<input type="checkbox"/> 50725	<input type="checkbox"/> 50725	1/2" Offset for 2-1/4" Thick, 3 x 4 \$ 27
<input type="checkbox"/> 50723	<input type="checkbox"/> 50723	1/2" Offset for 2-1/4" Thick, 3 x 5 \$ 27
<input type="checkbox"/> 50724	<input type="checkbox"/> 50724	1/2" Offset for 3" Thick, 3 x 6 \$ 27
<input type="checkbox"/> 50175	<input type="checkbox"/> 50175	1" Offset for 2-1/4" Thick, 3 x 4 \$ 24
<input type="checkbox"/> 50176	<input type="checkbox"/> 50176	1" Offset for 2-1/4" Thick, 3 x 5 \$ 24
<input type="checkbox"/> 50179	<input type="checkbox"/> 50179	1" Offset for 3" Thick, 3 x 6 \$ 24
<input type="checkbox"/> 50166	<input type="checkbox"/> 50166	2" Offset for 2-1/4" Thick, 3 x 4 \$ 24
<input type="checkbox"/> 50167	<input type="checkbox"/> 50167	2" Offset for 2-1/4" Thick, 3 x 5 \$ 24
<input type="checkbox"/> 50181	<input type="checkbox"/> 50181	2" Offset for 3" Thick, 3 x 6 \$ 24



### Adjustable Angle Bracket Each E0956

LEFT	RIGHT	
<input type="checkbox"/> None	<input type="checkbox"/> None	
<input type="checkbox"/> 50235	<input type="checkbox"/> 50235	1" Offset Adjustable Angle Assembly \$ 140
<input type="checkbox"/> 50236	<input type="checkbox"/> 50236	2" Offset Adjustable Angle Assembly \$ 140

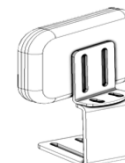

### Removable Bracket (Non-Locking) Each E1028

LEFT	RIGHT	
<input type="checkbox"/> None	<input type="checkbox"/> None	
<input type="checkbox"/> 50240	<input type="checkbox"/> 50240	Removable, 0" Offset \$ 144
<input type="checkbox"/> 50241	<input type="checkbox"/> 50241	Removable, 1" Offset \$ 144
<input type="checkbox"/> 50245	<input type="checkbox"/> 50245	Removable, 1-1/2" Offset \$ 144
<input type="checkbox"/> 50242	<input type="checkbox"/> 50242	Removable, 2" Offset \$ 144

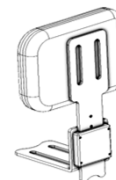

**Flip Down Bracket Each E1028**

**LEFT RIGHT**

<input type="checkbox"/>	None	<input type="checkbox"/>	None		
<input type="checkbox"/>	31397	<input type="checkbox"/>	31397	Flip Down for Quantum	\$ 161

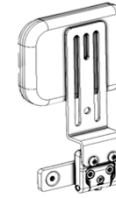

**SEAT MOUNT Locking Removable Bracket Each E1028**

**LEFT RIGHT No Offset, 3" Pad Mount**

<input type="checkbox"/>	None	<input type="checkbox"/>	None		
<input type="checkbox"/>	34320	<input type="checkbox"/>	34320	No Offset, 2" Thick Seat, 3" Pad Mount	\$ 226
<input type="checkbox"/>	34328	<input type="checkbox"/>	34328	No Offset, 2.5" Thick Seat, 3" Pad Mount	\$ 226
<input type="checkbox"/>	34336	<input type="checkbox"/>	34336	No Offset, 3" Thick Seat, 3" Pad Mount	\$ 226
<input type="checkbox"/>	34344	<input type="checkbox"/>	34344	No Offset, 3.5" Thick Seat, 3" Pad Mount	\$ 226
<input type="checkbox"/>	34352	<input type="checkbox"/>	34352	No Offset, 4" Thick Seat, 3" Pad Mount	\$ 226
<input type="checkbox"/>	34360	<input type="checkbox"/>	34360	No Offset, 4.5" Thick Seat, 3" Pad Mount	\$ 226
<input type="checkbox"/>	34368	<input type="checkbox"/>	34368	No Offset, 5" Thick Seat, 3" Pad Mount	\$ 226
<input type="checkbox"/>	34376	<input type="checkbox"/>	34376	No Offset, 5.5" Thick Seat, 3" Pad Mount	\$ 226
<input type="checkbox"/>	34384	<input type="checkbox"/>	34384	No Offset, 6" Thick Seat, 3" Pad Mount	\$ 226

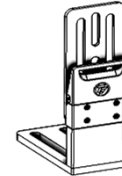

**LEFT RIGHT No Offset, 5" Pad Mount**

<input type="checkbox"/>	None	<input type="checkbox"/>	None		
<input type="checkbox"/>	34321	<input type="checkbox"/>	34321	No Offset, 2" Thick Seat, 5" Pad Mount	\$ 226
<input type="checkbox"/>	34329	<input type="checkbox"/>	34329	No Offset, 2.5" Thick Seat, 5" Pad Mount	\$ 226
<input type="checkbox"/>	34337	<input type="checkbox"/>	34337	No Offset, 3" Thick Seat, 5" Pad Mount	\$ 226
<input type="checkbox"/>	34345	<input type="checkbox"/>	34345	No Offset, 3.5" Thick Seat, 5" Pad Mount	\$ 226
<input type="checkbox"/>	34353	<input type="checkbox"/>	34353	No Offset, 4" Thick Seat, 5" Pad Mount	\$ 226
<input type="checkbox"/>	34361	<input type="checkbox"/>	34361	No Offset, 4.5" Thick Seat, 5" Pad Mount	\$ 226
<input type="checkbox"/>	34369	<input type="checkbox"/>	34369	No Offset, 5" Thick Seat, 5" Pad Mount	\$ 226
<input type="checkbox"/>	34377	<input type="checkbox"/>	34377	No Offset, 5.5" Thick Seat, 5" Pad Mount	\$ 226
<input type="checkbox"/>	34385	<input type="checkbox"/>	34385	No Offset, 6" Thick Seat, 5" Pad Mount	\$ 226

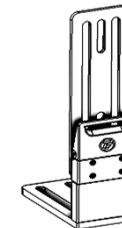

**LEFT RIGHT 1/2" Offset, 3" Pad Mount**

<input type="checkbox"/>	None	<input type="checkbox"/>	None		
<input type="checkbox"/>	34322	<input type="checkbox"/>	34322	1/2" Offset 2" Thick Seat, 3" Pad Mount	\$ 226
<input type="checkbox"/>	34330	<input type="checkbox"/>	34330	1/2" Offset 2.5" Thick Seat, 3" Pad Mount	\$ 226
<input type="checkbox"/>	34338	<input type="checkbox"/>	34338	1/2" Offset 3" Thick Seat, 3" Pad Mount	\$ 226
<input type="checkbox"/>	34346	<input type="checkbox"/>	34346	1/2" Offset 3.5" Thick Seat, 3" Pad Mount	\$ 226
<input type="checkbox"/>	34354	<input type="checkbox"/>	34354	1/2" Offset 4" Thick Seat, 3" Pad Mount	\$ 226
<input type="checkbox"/>	34362	<input type="checkbox"/>	34362	1/2" Offset 4.5" Thick Seat, 3" Pad Mount	\$ 226
<input type="checkbox"/>	34370	<input type="checkbox"/>	34370	1/2" Offset 5" Thick Seat, 3" Pad Mount	\$ 226
<input type="checkbox"/>	34378	<input type="checkbox"/>	34378	1/2" Offset 5.5" Thick Seat, 3" Pad Mount	\$ 226
<input type="checkbox"/>	34386	<input type="checkbox"/>	34386	1/2" Offset 6" Thick Seat, 3" Pad Mount	\$ 226



**LEFT RIGHT 1/2" Offset, 5" Pad Mount**

<input type="checkbox"/>	None	<input type="checkbox"/>	None		
<input type="checkbox"/>	34323	<input type="checkbox"/>	34323	1/2" Offset 2" Thick Seat, 5" Pad Mount	\$ 226
<input type="checkbox"/>	34331	<input type="checkbox"/>	34331	1/2" Offset 2.5" Thick Seat, 5" Pad Mount	\$ 226
<input type="checkbox"/>	34339	<input type="checkbox"/>	34339	1/2" Offset 3" Thick Seat, 5" Pad Mount	\$ 226
<input type="checkbox"/>	34347	<input type="checkbox"/>	34347	1/2" Offset 3.5" Thick Seat, 5" Pad Mount	\$ 226
<input type="checkbox"/>	34355	<input type="checkbox"/>	34355	1/2" Offset 4" Thick Seat, 5" Pad Mount	\$ 226
<input type="checkbox"/>	34363	<input type="checkbox"/>	34363	1/2" Offset 4.5" Thick Seat, 5" Pad Mount	\$ 226
<input type="checkbox"/>	34371	<input type="checkbox"/>	34371	1/2" Offset 5" Thick Seat, 5" Pad Mount	\$ 226
<input type="checkbox"/>	34379	<input type="checkbox"/>	34379	1/2" Offset 5.5" Thick Seat, 5" Pad Mount	\$ 226
<input type="checkbox"/>	34387	<input type="checkbox"/>	34387	1/2" Offset 6" Thick Seat, 5" Pad Mount	\$ 226

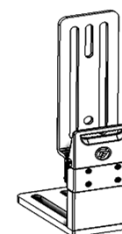

LEFT		RIGHT		<i>1" Offset, 3" Pad Mount</i>	
<input type="checkbox"/>	None	<input type="checkbox"/>	None		
<input type="checkbox"/>	34324	<input type="checkbox"/>	34324	1" Offset 2" Thick Seat, 3" Pad Mount	\$ 226
<input type="checkbox"/>	34332	<input type="checkbox"/>	34332	1" Offset 2.5" Thick Seat, 3" Pad Mount	\$ 226
<input type="checkbox"/>	34340	<input type="checkbox"/>	34340	1" Offset 3" Thick Seat, 3" Pad Mount	\$ 226
<input type="checkbox"/>	34348	<input type="checkbox"/>	34348	1" Offset 3.5" Thick Seat, 3" Pad Mount	\$ 226
<input type="checkbox"/>	34356	<input type="checkbox"/>	34356	1" Offset 4" Thick Seat, 3" Pad Mount	\$ 226
<input type="checkbox"/>	34364	<input type="checkbox"/>	34364	1" Offset 4.5" Thick Seat, 3" Pad Mount	\$ 226
<input type="checkbox"/>	34372	<input type="checkbox"/>	34372	1" Offset 5" Thick Seat, 3" Pad Mount	\$ 226
<input type="checkbox"/>	34380	<input type="checkbox"/>	34380	1" Offset 5.5" Thick Seat, 3" Pad Mount	\$ 226
<input type="checkbox"/>	34388	<input type="checkbox"/>	34388	1" Offset 6" Thick Seat, 3" Pad Mount	\$ 226

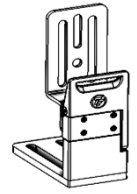

LEFT		RIGHT		<i>1" Offset, 5" Pad Mount</i>	
<input type="checkbox"/>	None	<input type="checkbox"/>	None		
<input type="checkbox"/>	34325	<input type="checkbox"/>	34325	1" Offset 2" Thick Seat, 5" Pad Mount	\$ 226
<input type="checkbox"/>	34333	<input type="checkbox"/>	34333	1" Offset 2.5" Thick Seat, 5" Pad Mount	\$ 226
<input type="checkbox"/>	34341	<input type="checkbox"/>	34341	1" Offset 3" Thick Seat, 5" Pad Mount	\$ 226
<input type="checkbox"/>	34349	<input type="checkbox"/>	34349	1" Offset 3.5" Thick Seat, 5" Pad Mount	\$ 226
<input type="checkbox"/>	34357	<input type="checkbox"/>	34357	1" Offset 4" Thick Seat, 5" Pad Mount	\$ 226
<input type="checkbox"/>	34365	<input type="checkbox"/>	34365	1" Offset 4.5" Thick Seat, 5" Pad Mount	\$ 226
<input type="checkbox"/>	34373	<input type="checkbox"/>	34373	1" Offset 5" Thick Seat, 5" Pad Mount	\$ 226
<input type="checkbox"/>	34381	<input type="checkbox"/>	34381	1" Offset 5.5" Thick Seat, 5" Pad Mount	\$ 226
<input type="checkbox"/>	34389	<input type="checkbox"/>	34389	1" Offset 6" Thick Seat, 5" Pad Mount	\$ 226

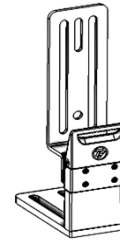

LEFT		RIGHT		<i>2" Offset, 3" Pad Mount</i>	
<input type="checkbox"/>	None	<input type="checkbox"/>	None		
<input type="checkbox"/>	34326	<input type="checkbox"/>	34326	2" Offset 2" Thick Seat, 3" Pad Mount	\$ 226
<input type="checkbox"/>	34334	<input type="checkbox"/>	34334	2" Offset 2.5" Thick Seat, 3" Pad Mount	\$ 226
<input type="checkbox"/>	34342	<input type="checkbox"/>	34342	2" Offset 3" Thick Seat, 3" Pad Mount	\$ 226
<input type="checkbox"/>	34350	<input type="checkbox"/>	34350	2" Offset 3.5" Thick Seat, 3" Pad Mount	\$ 226
<input type="checkbox"/>	34358	<input type="checkbox"/>	34358	2" Offset 4" Thick Seat, 3" Pad Mount	\$ 226
<input type="checkbox"/>	34366	<input type="checkbox"/>	34366	2" Offset 4.5" Thick Seat, 3" Pad Mount	\$ 226
<input type="checkbox"/>	34374	<input type="checkbox"/>	34374	2" Offset 5" Thick Seat, 3" Pad Mount	\$ 226
<input type="checkbox"/>	34382	<input type="checkbox"/>	34382	2" Offset 5.5" Thick Seat, 3" Pad Mount	\$ 226
<input type="checkbox"/>	34390	<input type="checkbox"/>	34390	2" Offset 6" Thick Seat, 3" Pad Mount	\$ 226

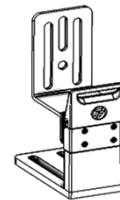

LEFT		RIGHT		<i>2" Offset, 5" Pad Mount</i>	
<input type="checkbox"/>	None	<input type="checkbox"/>	None		
<input type="checkbox"/>	34327	<input type="checkbox"/>	34327	2" Offset 2" Thick Seat, 5" Pad Mount	\$ 226
<input type="checkbox"/>	34335	<input type="checkbox"/>	34335	2" Offset 2.5" Thick Seat, 5" Pad Mount	\$ 226
<input type="checkbox"/>	34343	<input type="checkbox"/>	34343	2" Offset 3" Thick Seat, 5" Pad Mount	\$ 226
<input type="checkbox"/>	34351	<input type="checkbox"/>	34351	2" Offset 3.5" Thick Seat, 5" Pad Mount	\$ 226
<input type="checkbox"/>	34359	<input type="checkbox"/>	34359	2" Offset 4" Thick Seat, 5" Pad Mount	\$ 226
<input type="checkbox"/>	34367	<input type="checkbox"/>	34367	2" Offset 4.5" Thick Seat, 5" Pad Mount	\$ 226
<input type="checkbox"/>	34375	<input type="checkbox"/>	34375	2" Offset 5" Thick Seat, 5" Pad Mount	\$ 226
<input type="checkbox"/>	34383	<input type="checkbox"/>	34383	2" Offset 5.5" Thick Seat, 5" Pad Mount	\$ 226
<input type="checkbox"/>	34391	<input type="checkbox"/>	34391	2" Offset 6" Thick Seat, 5" Pad Mount	\$ 226

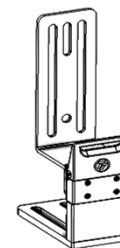

**CHANNEL MOUNT Locking Removable Bracket Each E1028**

LEFT		RIGHT		<i>No Offset, 3" Pad Mount</i>	
<input type="checkbox"/>	None	<input type="checkbox"/>	None		
<input type="checkbox"/>	34437	<input type="checkbox"/>	34437	No Offset, 3.5" Thick Seat, 3" Pad Mount	\$ 237
<input type="checkbox"/>	34445	<input type="checkbox"/>	34445	No Offset, 4" Thick Seat, 3" Pad Mount	\$ 237
<input type="checkbox"/>	34453	<input type="checkbox"/>	34453	No Offset, 4.5" Thick Seat, 3" Pad Mount	\$ 237
<input type="checkbox"/>	34461	<input type="checkbox"/>	34461	No Offset, 5" Thick Seat, 3" Pad Mount	\$ 237
<input type="checkbox"/>	34469	<input type="checkbox"/>	34469	No Offset, 5.5" Thick Seat, 3" Pad Mount	\$ 237
<input type="checkbox"/>	34477	<input type="checkbox"/>	34477	No Offset, 6" Thick Seat, 3" Pad Mount	\$ 237



LEFT		RIGHT		<i>No Offset, 5" Pad Mount</i>	
<input type="checkbox"/>	None	<input type="checkbox"/>	None		
<input type="checkbox"/>	34438	<input type="checkbox"/>	34438	No Offset, 3.5" Thick Seat, 5" Pad Mount	\$ 237
<input type="checkbox"/>	34446	<input type="checkbox"/>	34446	No Offset, 4" Thick Seat, 5" Pad Mount	\$ 237
<input type="checkbox"/>	34454	<input type="checkbox"/>	34454	No Offset, 4.5" Thick Seat, 5" Pad Mount	\$ 237
<input type="checkbox"/>	34462	<input type="checkbox"/>	34462	No Offset, 5" Thick Seat, 5" Pad Mount	\$ 237
<input type="checkbox"/>	34470	<input type="checkbox"/>	34470	No Offset, 5.5" Thick Seat, 5" Pad Mount	\$ 237
<input type="checkbox"/>	34478	<input type="checkbox"/>	34478	No Offset, 6" Thick Seat, 5" Pad Mount	\$ 237



LEFT		RIGHT		<i>1/2" Offset, 3" Pad Mount</i>	
<input type="checkbox"/>	None	<input type="checkbox"/>	None		
<input type="checkbox"/>	34439	<input type="checkbox"/>	34439	1/2" Offset 3.5" Thick Seat, 3" Pad Mount	\$ 237
<input type="checkbox"/>	34447	<input type="checkbox"/>	34447	1/2" Offset 4" Thick Seat, 3" Pad Mount	\$ 237
<input type="checkbox"/>	34455	<input type="checkbox"/>	34455	1/2" Offset 4.5" Thick Seat, 3" Pad Mount	\$ 237
<input type="checkbox"/>	34463	<input type="checkbox"/>	34463	1/2" Offset 5" Thick Seat, 3" Pad Mount	\$ 237
<input type="checkbox"/>	34471	<input type="checkbox"/>	34471	1/2" Offset 5.5" Thick Seat, 3" Pad Mount	\$ 237
<input type="checkbox"/>	34479	<input type="checkbox"/>	34479	1/2" Offset 6" Thick Seat, 3" Pad Mount	\$ 237



LEFT		RIGHT		<i>1/2" Offset, 5" Pad Mount</i>	
<input type="checkbox"/>	None	<input type="checkbox"/>	None		
<input type="checkbox"/>	34440	<input type="checkbox"/>	34440	1/2" Offset 3.5" Thick Seat, 5" Pad Mount	\$ 237
<input type="checkbox"/>	34448	<input type="checkbox"/>	34448	1/2" Offset 4" Thick Seat, 5" Pad Mount	\$ 237
<input type="checkbox"/>	34456	<input type="checkbox"/>	34456	1/2" Offset 4.5" Thick Seat, 5" Pad Mount	\$ 237
<input type="checkbox"/>	34464	<input type="checkbox"/>	34464	1/2" Offset 5" Thick Seat, 5" Pad Mount	\$ 237
<input type="checkbox"/>	34472	<input type="checkbox"/>	34472	1/2" Offset 5.5" Thick Seat, 5" Pad Mount	\$ 237
<input type="checkbox"/>	34480	<input type="checkbox"/>	34480	1/2" Offset 6" Thick Seat, 5" Pad Mount	\$ 237



LEFT		RIGHT		<i>1" Offset, 3" Pad Mount</i>	
<input type="checkbox"/>	None	<input type="checkbox"/>	None		
<input type="checkbox"/>	34441	<input type="checkbox"/>	34441	1" Offset 3.5" Thick Seat, 3" Pad Mount	\$ 237
<input type="checkbox"/>	34449	<input type="checkbox"/>	34449	1" Offset 4" Thick Seat, 3" Pad Mount	\$ 237
<input type="checkbox"/>	34457	<input type="checkbox"/>	34457	1" Offset 4.5" Thick Seat, 3" Pad Mount	\$ 237
<input type="checkbox"/>	34465	<input type="checkbox"/>	34465	1" Offset 5" Thick Seat, 3" Pad Mount	\$ 237
<input type="checkbox"/>	34473	<input type="checkbox"/>	34473	1" Offset 5.5" Thick Seat, 3" Pad Mount	\$ 237
<input type="checkbox"/>	34481	<input type="checkbox"/>	34481	1" Offset 6" Thick Seat, 3" Pad Mount	\$ 237



LEFT		RIGHT		<i>1" Offset, 5" Pad Mount</i>	
<input type="checkbox"/>	None	<input type="checkbox"/>	None		
<input type="checkbox"/>	34442	<input type="checkbox"/>	34442	1" Offset 3.5" Thick Seat, 5" Pad Mount	\$ 237
<input type="checkbox"/>	34450	<input type="checkbox"/>	34450	1" Offset 4" Thick Seat, 5" Pad Mount	\$ 237
<input type="checkbox"/>	34458	<input type="checkbox"/>	34458	1" Offset 4.5" Thick Seat, 5" Pad Mount	\$ 237
<input type="checkbox"/>	34466	<input type="checkbox"/>	34466	1" Offset 5" Thick Seat, 5" Pad Mount	\$ 237
<input type="checkbox"/>	34474	<input type="checkbox"/>	34474	1" Offset 5.5" Thick Seat, 5" Pad Mount	\$ 237
<input type="checkbox"/>	34482	<input type="checkbox"/>	34482	1" Offset 6" Thick Seat, 5" Pad Mount	\$ 237



LEFT		RIGHT		<i>2" Offset, 3" Pad Mount</i>	
<input type="checkbox"/>	None	<input type="checkbox"/>	None		
<input type="checkbox"/>	34443	<input type="checkbox"/>	34443	2" Offset 3.5" Thick Seat, 3" Pad Mount	\$ 237
<input type="checkbox"/>	34451	<input type="checkbox"/>	34451	2" Offset 4" Thick Seat, 3" Pad Mount	\$ 237
<input type="checkbox"/>	34459	<input type="checkbox"/>	34459	2" Offset 4.5" Thick Seat, 3" Pad Mount	\$ 237
<input type="checkbox"/>	34467	<input type="checkbox"/>	34467	2" Offset 5" Thick Seat, 3" Pad Mount	\$ 237
<input type="checkbox"/>	34475	<input type="checkbox"/>	34475	2" Offset 5.5" Thick Seat, 3" Pad Mount	\$ 237
<input type="checkbox"/>	34483	<input type="checkbox"/>	34483	2" Offset 6" Thick Seat, 3" Pad Mount	\$ 237

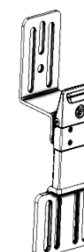

LEFT		RIGHT		<i>2" Offset, 5" Pad Mount</i>	
<input type="checkbox"/>	None	<input type="checkbox"/>	None		
<input type="checkbox"/>	34444	<input type="checkbox"/>	34444	2" Offset 3.5" Thick Seat, 5" Pad Mount	\$ 237
<input type="checkbox"/>	34452	<input type="checkbox"/>	34452	2" Offset 4" Thick Seat, 5" Pad Mount	\$ 237
<input type="checkbox"/>	34460	<input type="checkbox"/>	34460	2" Offset 4.5" Thick Seat, 5" Pad Mount	\$ 237
<input type="checkbox"/>	34468	<input type="checkbox"/>	34468	2" Offset 5" Thick Seat, 5" Pad Mount	\$ 237
<input type="checkbox"/>	34476	<input type="checkbox"/>	34476	2" Offset 5.5" Thick Seat, 5" Pad Mount	\$ 237
<input type="checkbox"/>	34484	<input type="checkbox"/>	34484	2" Offset 6" Thick Seat, 5" Pad Mount	\$ 237



# Front Lateral Hip Supports

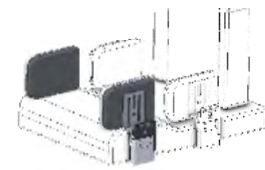

## Standard Lateral Hip Pad E0956 Ea.

LEFT	RIGHT	<i>These pads have Black Smooth Dartex Face and Neoprene Knit Back Side</i>	
<input type="checkbox"/> 50270	<input type="checkbox"/> 50270	Hip Guide, Flat, 3 x 4	\$ 84
<input type="checkbox"/> 50271	<input type="checkbox"/> 50271	Hip Guide, Flat, 3 x 5	\$ 84
<input type="checkbox"/> 50272	<input type="checkbox"/> 50272	Hip Guide, Flat, 4 x 5	\$ 84
<input type="checkbox"/> 50273	<input type="checkbox"/> 50273	Hip Guide, Flat, 4 x 6	\$ 84
<input type="checkbox"/> 50275	<input type="checkbox"/> 50275	Hip Guide, Flat, 4 x 8	\$ 84

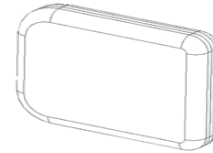

## Custom Lateral Hip Pad E0956 Ea.

LEFT	RIGHT	<i>For Custom Pad select fabrics next page</i>	
<input type="checkbox"/> 73004	<input type="checkbox"/> 73004	Hip Pad, TrU-Spec Non-Contoured	\$ 121

LEFT

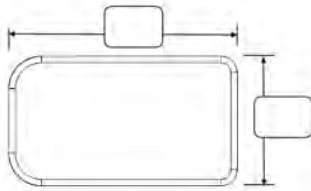

RIGHT

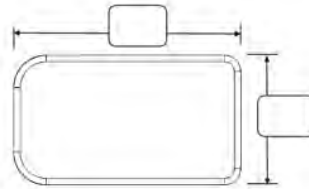

## Pad Modifications Ea.

<input type="checkbox"/> 71068	Modification Extra Foam	\$ 26	
	<input type="checkbox"/> XX-Soft		
	<input type="checkbox"/> X-Soft		
	<input type="checkbox"/> Soft		
	<input type="checkbox"/> Medium		
<input type="checkbox"/> 71067	Modification add Gel 1/4"	\$ 39	
<input type="checkbox"/>	Set Pad FLUSH with Front of Seat	N/C	
<input type="checkbox"/>	Set Pad BACK from Front Edge <i>Indicate distance in Box at right</i>	N/C	Distance <input type="text"/>
<input type="checkbox"/>	Set Pad BEYOND of Front Edge <i>Indicate distance in Box at right</i>	N/C	Distance <input type="text"/>

## Front Hip Pad Fabric Color and Type N/C

Contact	Non-Contact	
<input type="checkbox"/> 72019	<input type="checkbox"/> 72020	DARLEXX
<input type="checkbox"/> 72066	<input type="checkbox"/> 72067	DARTEX SMOOTH SIDE OUT
<input type="checkbox"/> 72064	<input type="checkbox"/> 72069	MESH FABRIC (TheraVent)
<input type="checkbox"/> 71006	<input type="checkbox"/> 72068	DARTEX KNIT SIDE OUT
<input type="checkbox"/> 72070	<input type="checkbox"/> 72071	2MM KNIT NEOPRENE
<input type="checkbox"/> 72072	<input type="checkbox"/> 72073	BLACK VINYL
<input type="checkbox"/> 72074	<input type="checkbox"/> 71037	RED VINYL
<input type="checkbox"/> 72075	<input type="checkbox"/> 71038	GREY VINYL
<input type="checkbox"/> 72076	<input type="checkbox"/> 71039	PINK VINYL
<input type="checkbox"/> 72077	<input type="checkbox"/> 71040	YELLOW VINYL
<input type="checkbox"/> 72078	<input type="checkbox"/> 71041	PURPLE VINYL
<input type="checkbox"/> 72079	<input type="checkbox"/> 71042	BLUE VINYL
<input type="checkbox"/> 72080	<input type="checkbox"/> 71043	GREEN VINYL
<input type="checkbox"/> 72081	<input type="checkbox"/> 71044	TEAL VINYL
<input type="checkbox"/> 72082	<input type="checkbox"/> 71045	RASPBERRY VINYL
<input type="checkbox"/> 72085	<input type="checkbox"/> 72092	MONSTER GREEN VINYL
<input type="checkbox"/> 72086	<input type="checkbox"/> 72093	ORANGESICLE VINYL
<input type="checkbox"/> 72087	<input type="checkbox"/> 72094	VERY CHERRY VINYL
<input type="checkbox"/> 72088	<input type="checkbox"/> 72095	FIZZY COLA VINYL
<input type="checkbox"/> 72089	<input type="checkbox"/> 72096	ISLAND BLUE VINYL
<input type="checkbox"/> 72090	<input type="checkbox"/> 72097	CINNAMON SPICE VINYL
<input type="checkbox"/> 72091	<input type="checkbox"/> 72098	PRETTY IN PINK VINYL
<input type="checkbox"/> 73006	<input type="checkbox"/> 73008	2.5MM SMOOTH NEOPRENE
<input type="checkbox"/> 73007	<input type="checkbox"/> 73009	2.5MM KNIT NEOPRENE

**Spacers (1/2" Each) Each K0108**

LEFT		RIGHT			
Qty		Qty			
	50098		50098	Spacer (1/2")	\$ 25

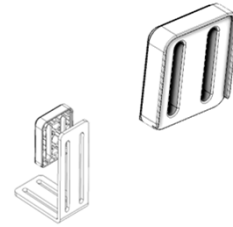

**Fixed Bracket Each E0956**

LEFT		RIGHT			
<input type="checkbox"/>	None	<input type="checkbox"/>	None		
<input type="checkbox"/>	50171	<input type="checkbox"/>	50171	L-Bracket, Heavy Duty, 3.5 x 5	\$ 24
<input type="checkbox"/>	50172	<input type="checkbox"/>	50172	L-Bracket, Heavy Duty, 3.5 x 6	\$ 24
<input type="checkbox"/>	50173	<input type="checkbox"/>	50173	L-Bracket, Heavy Duty, 3.5 x 8	\$ 24
<input type="checkbox"/>	50725	<input type="checkbox"/>	50725	1/2" Offset for 2-1/4" Thick, 3 x 4	\$ 27
<input type="checkbox"/>	50723	<input type="checkbox"/>	50723	1/2" Offset for 2-1/4" Thick, 3 x 5	\$ 27
<input type="checkbox"/>	50724	<input type="checkbox"/>	50724	1/2" Offset for 3" Thick, 3 x 6	\$ 27
<input type="checkbox"/>	50175	<input type="checkbox"/>	50175	1" Offset for 2-1/4" Thick, 3 x 4	\$ 24
<input type="checkbox"/>	50176	<input type="checkbox"/>	50176	1" Offset for 2-1/4" Thick, 3 x 5	\$ 24
<input type="checkbox"/>	50179	<input type="checkbox"/>	50179	1" Offset for 3" Thick, 3 x 6	\$ 24
<input type="checkbox"/>	50166	<input type="checkbox"/>	50166	2" Offset for 2-1/4" Thick, 3 x 4	\$ 24
<input type="checkbox"/>	50167	<input type="checkbox"/>	50167	2" Offset for 2-1/4" Thick, 3 x 5	\$ 24
<input type="checkbox"/>	50181	<input type="checkbox"/>	50181	2" Offset for 3" Thick, 3 x 6	\$ 24



**Adjustable Angle Bracket Each E0956**

LEFT		RIGHT			
<input type="checkbox"/>	None	<input type="checkbox"/>	None		
<input type="checkbox"/>	50235	<input type="checkbox"/>	50235	1" Offset Adjustable Angle Assembly	\$ 140
<input type="checkbox"/>	50236	<input type="checkbox"/>	50236	2" Offset Adjustable Angle Assembly	\$ 140

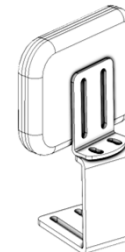

**Removable Bracket (Non-Locking) Each E1028**

LEFT		RIGHT			
<input type="checkbox"/>	None	<input type="checkbox"/>	None		
<input type="checkbox"/>	50240	<input type="checkbox"/>	50240	Removable, 0" Offset	\$ 144
<input type="checkbox"/>	50241	<input type="checkbox"/>	50241	Removable, 1" Offset	\$ 144
<input type="checkbox"/>	50245	<input type="checkbox"/>	50245	Removable, 1-1/2" Offset	\$ 144
<input type="checkbox"/>	50242	<input type="checkbox"/>	50242	Removable, 2" Offset	\$ 144



**Flip Down Bracket Each E1028**

LEFT		RIGHT			
<input type="checkbox"/>	None	<input type="checkbox"/>	None		
<input type="checkbox"/>	31397	<input type="checkbox"/>	31397	Flip Down for Quantum	\$ 161

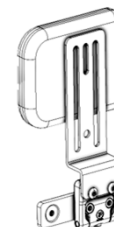



## SEAT MOUNT Locking Removable Bracket Each E1028

### LEFT                      RIGHT      *No Offset, 3" Pad Mount*

<input type="checkbox"/>	None	<input type="checkbox"/>	None		
<input type="checkbox"/>	34320	<input type="checkbox"/>	34320	No Offset, 2" Thick Seat, 3" Pad Mount	\$ 226
<input type="checkbox"/>	34328	<input type="checkbox"/>	34328	No Offset, 2.5" Thick Seat, 3" Pad Mount	\$ 226
<input type="checkbox"/>	34336	<input type="checkbox"/>	34336	No Offset, 3" Thick Seat, 3" Pad Mount	\$ 226
<input type="checkbox"/>	34344	<input type="checkbox"/>	34344	No Offset, 3.5" Thick Seat, 3" Pad Mount	\$ 226
<input type="checkbox"/>	34352	<input type="checkbox"/>	34352	No Offset, 4" Thick Seat, 3" Pad Mount	\$ 226
<input type="checkbox"/>	34360	<input type="checkbox"/>	34360	No Offset, 4.5" Thick Seat, 3" Pad Mount	\$ 226
<input type="checkbox"/>	34368	<input type="checkbox"/>	34368	No Offset, 5" Thick Seat, 3" Pad Mount	\$ 226
<input type="checkbox"/>	34376	<input type="checkbox"/>	34376	No Offset, 5.5" Thick Seat, 3" Pad Mount	\$ 226
<input type="checkbox"/>	34384	<input type="checkbox"/>	34384	No Offset, 6" Thick Seat, 3" Pad Mount	\$ 226



### LEFT                      RIGHT      *No Offset, 5" Pad Mount*

<input type="checkbox"/>	None	<input type="checkbox"/>	None		
<input type="checkbox"/>	34321	<input type="checkbox"/>	34321	No Offset, 2" Thick Seat, 5" Pad Mount	\$ 226
<input type="checkbox"/>	34329	<input type="checkbox"/>	34329	No Offset, 2.5" Thick Seat, 5" Pad Mount	\$ 226
<input type="checkbox"/>	34337	<input type="checkbox"/>	34337	No Offset, 3" Thick Seat, 5" Pad Mount	\$ 226
<input type="checkbox"/>	34345	<input type="checkbox"/>	34345	No Offset, 3.5" Thick Seat, 5" Pad Mount	\$ 226
<input type="checkbox"/>	34353	<input type="checkbox"/>	34353	No Offset, 4" Thick Seat, 5" Pad Mount	\$ 226
<input type="checkbox"/>	34361	<input type="checkbox"/>	34361	No Offset, 4.5" Thick Seat, 5" Pad Mount	\$ 226
<input type="checkbox"/>	34369	<input type="checkbox"/>	34369	No Offset, 5" Thick Seat, 5" Pad Mount	\$ 226
<input type="checkbox"/>	34377	<input type="checkbox"/>	34377	No Offset, 5.5" Thick Seat, 5" Pad Mount	\$ 226
<input type="checkbox"/>	34385	<input type="checkbox"/>	34385	No Offset, 6" Thick Seat, 5" Pad Mount	\$ 226

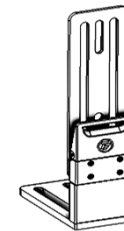

### LEFT                      RIGHT      *1/2" Offset, 3" Pad Mount*

<input type="checkbox"/>	None	<input type="checkbox"/>	None		
<input type="checkbox"/>	34322	<input type="checkbox"/>	34322	1/2" Offset 2" Thick Seat, 3" Pad Mount	\$ 226
<input type="checkbox"/>	34330	<input type="checkbox"/>	34330	1/2" Offset 2.5" Thick Seat, 3" Pad Mount	\$ 226
<input type="checkbox"/>	34338	<input type="checkbox"/>	34338	1/2" Offset 3" Thick Seat, 3" Pad Mount	\$ 226
<input type="checkbox"/>	34346	<input type="checkbox"/>	34346	1/2" Offset 3.5" Thick Seat, 3" Pad Mount	\$ 226
<input type="checkbox"/>	34354	<input type="checkbox"/>	34354	1/2" Offset 4" Thick Seat, 3" Pad Mount	\$ 226
<input type="checkbox"/>	34362	<input type="checkbox"/>	34362	1/2" Offset 4.5" Thick Seat, 3" Pad Mount	\$ 226
<input type="checkbox"/>	34370	<input type="checkbox"/>	34370	1/2" Offset 5" Thick Seat, 3" Pad Mount	\$ 226
<input type="checkbox"/>	34378	<input type="checkbox"/>	34378	1/2" Offset 5.5" Thick Seat, 3" Pad Mount	\$ 226
<input type="checkbox"/>	34386	<input type="checkbox"/>	34386	1/2" Offset 6" Thick Seat, 3" Pad Mount	\$ 226



### LEFT                      RIGHT      *1/2" Offset, 5" Pad Mount*

<input type="checkbox"/>	None	<input type="checkbox"/>	None		
<input type="checkbox"/>	34323	<input type="checkbox"/>	34323	1/2" Offset 2" Thick Seat, 5" Pad Mount	\$ 226
<input type="checkbox"/>	34331	<input type="checkbox"/>	34331	1/2" Offset 2.5" Thick Seat, 5" Pad Mount	\$ 226
<input type="checkbox"/>	34339	<input type="checkbox"/>	34339	1/2" Offset 3" Thick Seat, 5" Pad Mount	\$ 226
<input type="checkbox"/>	34347	<input type="checkbox"/>	34347	1/2" Offset 3.5" Thick Seat, 5" Pad Mount	\$ 226
<input type="checkbox"/>	34355	<input type="checkbox"/>	34355	1/2" Offset 4" Thick Seat, 5" Pad Mount	\$ 226
<input type="checkbox"/>	34363	<input type="checkbox"/>	34363	1/2" Offset 4.5" Thick Seat, 5" Pad Mount	\$ 226
<input type="checkbox"/>	34371	<input type="checkbox"/>	34371	1/2" Offset 5" Thick Seat, 5" Pad Mount	\$ 226
<input type="checkbox"/>	34379	<input type="checkbox"/>	34379	1/2" Offset 5.5" Thick Seat, 5" Pad Mount	\$ 226
<input type="checkbox"/>	34387	<input type="checkbox"/>	34387	1/2" Offset 6" Thick Seat, 5" Pad Mount	\$ 226

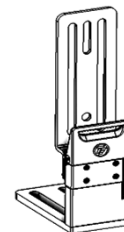

### LEFT                      RIGHT      *1" Offset, 3" Pad Mount*

<input type="checkbox"/>	None	<input type="checkbox"/>	None		
<input type="checkbox"/>	34324	<input type="checkbox"/>	34324	1" Offset 2" Thick Seat, 3" Pad Mount	\$ 226
<input type="checkbox"/>	34332	<input type="checkbox"/>	34332	1" Offset 2.5" Thick Seat, 3" Pad Mount	\$ 226
<input type="checkbox"/>	34340	<input type="checkbox"/>	34340	1" Offset 3" Thick Seat, 3" Pad Mount	\$ 226
<input type="checkbox"/>	34348	<input type="checkbox"/>	34348	1" Offset 3.5" Thick Seat, 3" Pad Mount	\$ 226
<input type="checkbox"/>	34356	<input type="checkbox"/>	34356	1" Offset 4" Thick Seat, 3" Pad Mount	\$ 226
<input type="checkbox"/>	34364	<input type="checkbox"/>	34364	1" Offset 4.5" Thick Seat, 3" Pad Mount	\$ 226
<input type="checkbox"/>	34372	<input type="checkbox"/>	34372	1" Offset 5" Thick Seat, 3" Pad Mount	\$ 226
<input type="checkbox"/>	34380	<input type="checkbox"/>	34380	1" Offset 5.5" Thick Seat, 3" Pad Mount	\$ 226
<input type="checkbox"/>	34388	<input type="checkbox"/>	34388	1" Offset 6" Thick Seat, 3" Pad Mount	\$ 226

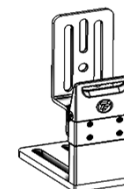



<b>LEFT</b>		<b>RIGHT</b>		<b>1" Offset, 5" Pad Mount</b>	
<input type="checkbox"/>	None	<input type="checkbox"/>	None		
<input type="checkbox"/>	34325	<input type="checkbox"/>	34325	1" Offset 2" Thick Seat, 5" Pad Mount	\$ 226
<input type="checkbox"/>	34333	<input type="checkbox"/>	34333	1" Offset 2.5" Thick Seat, 5" Pad Mount	\$ 226
<input type="checkbox"/>	34341	<input type="checkbox"/>	34341	1" Offset 3" Thick Seat, 5" Pad Mount	\$ 226
<input type="checkbox"/>	34349	<input type="checkbox"/>	34349	1" Offset 3.5" Thick Seat, 5" Pad Mount	\$ 226
<input type="checkbox"/>	34357	<input type="checkbox"/>	34357	1" Offset 4" Thick Seat, 5" Pad Mount	\$ 226
<input type="checkbox"/>	34365	<input type="checkbox"/>	34365	1" Offset 4.5" Thick Seat, 5" Pad Mount	\$ 226
<input type="checkbox"/>	34373	<input type="checkbox"/>	34373	1" Offset 5" Thick Seat, 5" Pad Mount	\$ 226
<input type="checkbox"/>	34381	<input type="checkbox"/>	34381	1" Offset 5.5" Thick Seat, 5" Pad Mount	\$ 226
<input type="checkbox"/>	34389	<input type="checkbox"/>	34389	1" Offset 6" Thick Seat, 5" Pad Mount	\$ 226

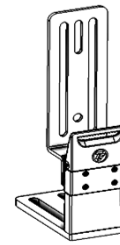

<b>LEFT</b>		<b>RIGHT</b>		<b>2" Offset, 3" Pad Mount</b>	
<input type="checkbox"/>	None	<input type="checkbox"/>	None		
<input type="checkbox"/>	34326	<input type="checkbox"/>	34326	2" Offset 2" Thick Seat, 3" Pad Mount	\$ 226
<input type="checkbox"/>	34334	<input type="checkbox"/>	34334	2" Offset 2.5" Thick Seat, 3" Pad Mount	\$ 226
<input type="checkbox"/>	34342	<input type="checkbox"/>	34342	2" Offset 3" Thick Seat, 3" Pad Mount	\$ 226
<input type="checkbox"/>	34350	<input type="checkbox"/>	34350	2" Offset 3.5" Thick Seat, 3" Pad Mount	\$ 226
<input type="checkbox"/>	34358	<input type="checkbox"/>	34358	2" Offset 4" Thick Seat, 3" Pad Mount	\$ 226
<input type="checkbox"/>	34366	<input type="checkbox"/>	34366	2" Offset 4.5" Thick Seat, 3" Pad Mount	\$ 226
<input type="checkbox"/>	34374	<input type="checkbox"/>	34374	2" Offset 5" Thick Seat, 3" Pad Mount	\$ 226
<input type="checkbox"/>	34382	<input type="checkbox"/>	34382	2" Offset 5.5" Thick Seat, 3" Pad Mount	\$ 226
<input type="checkbox"/>	34390	<input type="checkbox"/>	34390	2" Offset 6" Thick Seat, 3" Pad Mount	\$ 226

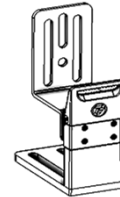

<b>LEFT</b>		<b>RIGHT</b>		<b>2" Offset, 5" Pad Mount</b>	
<input type="checkbox"/>	None	<input type="checkbox"/>	None		
<input type="checkbox"/>	34327	<input type="checkbox"/>	34327	2" Offset 2" Thick Seat, 5" Pad Mount	\$ 226
<input type="checkbox"/>	34335	<input type="checkbox"/>	34335	2" Offset 2.5" Thick Seat, 5" Pad Mount	\$ 226
<input type="checkbox"/>	34343	<input type="checkbox"/>	34343	2" Offset 3" Thick Seat, 5" Pad Mount	\$ 226
<input type="checkbox"/>	34351	<input type="checkbox"/>	34351	2" Offset 3.5" Thick Seat, 5" Pad Mount	\$ 226
<input type="checkbox"/>	34359	<input type="checkbox"/>	34359	2" Offset 4" Thick Seat, 5" Pad Mount	\$ 226
<input type="checkbox"/>	34367	<input type="checkbox"/>	34367	2" Offset 4.5" Thick Seat, 5" Pad Mount	\$ 226
<input type="checkbox"/>	34375	<input type="checkbox"/>	34375	2" Offset 5" Thick Seat, 5" Pad Mount	\$ 226
<input type="checkbox"/>	34383	<input type="checkbox"/>	34383	2" Offset 5.5" Thick Seat, 5" Pad Mount	\$ 226
<input type="checkbox"/>	34391	<input type="checkbox"/>	34391	2" Offset 6" Thick Seat, 5" Pad Mount	\$ 226

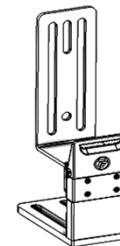

**CHANNEL MOUNT Locking Removable Bracket Each E1028**

<b>LEFT</b>		<b>RIGHT</b>		<b>No Offset, 3" Pad Mount</b>	
<input type="checkbox"/>	None	<input type="checkbox"/>	None		
<input type="checkbox"/>	34437	<input type="checkbox"/>	34437	No Offset, 3.5" Thick Seat, 3" Pad Mount	\$ 237
<input type="checkbox"/>	34445	<input type="checkbox"/>	34445	No Offset, 4" Thick Seat, 3" Pad Mount	\$ 237
<input type="checkbox"/>	34453	<input type="checkbox"/>	34453	No Offset, 4.5" Thick Seat, 3" Pad Mount	\$ 237
<input type="checkbox"/>	34461	<input type="checkbox"/>	34461	No Offset, 5" Thick Seat, 3" Pad Mount	\$ 237
<input type="checkbox"/>	34469	<input type="checkbox"/>	34469	No Offset, 5.5" Thick Seat, 3" Pad Mount	\$ 237
<input type="checkbox"/>	34477	<input type="checkbox"/>	34477	No Offset, 6" Thick Seat, 3" Pad Mount	\$ 237

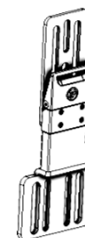

<b>LEFT</b>		<b>RIGHT</b>		<b>No Offset, 5" Pad Mount</b>	
<input type="checkbox"/>	None	<input type="checkbox"/>	None		
<input type="checkbox"/>	34438	<input type="checkbox"/>	34438	No Offset, 3.5" Thick Seat, 5" Pad Mount	\$ 237
<input type="checkbox"/>	34446	<input type="checkbox"/>	34446	No Offset, 4" Thick Seat, 5" Pad Mount	\$ 237
<input type="checkbox"/>	34454	<input type="checkbox"/>	34454	No Offset, 4.5" Thick Seat, 5" Pad Mount	\$ 237
<input type="checkbox"/>	34462	<input type="checkbox"/>	34462	No Offset, 5" Thick Seat, 5" Pad Mount	\$ 237
<input type="checkbox"/>	34470	<input type="checkbox"/>	34470	No Offset, 5.5" Thick Seat, 5" Pad Mount	\$ 237
<input type="checkbox"/>	34478	<input type="checkbox"/>	34478	No Offset, 6" Thick Seat, 5" Pad Mount	\$ 237



<b>LEFT</b>		<b>RIGHT</b>		<i>1/2" Offset, 3" Pad Mount</i>	
<input type="checkbox"/>	None	<input type="checkbox"/>	None		
<input type="checkbox"/>	34439	<input type="checkbox"/>	34439	1/2" Offset 3.5" Thick Seat, 3" Pad Mount	\$ 237
<input type="checkbox"/>	34447	<input type="checkbox"/>	34447	1/2" Offset 4" Thick Seat, 3" Pad Mount	\$ 237
<input type="checkbox"/>	34455	<input type="checkbox"/>	34455	1/2" Offset 4.5" Thick Seat, 3" Pad Mount	\$ 237
<input type="checkbox"/>	34463	<input type="checkbox"/>	34463	1/2" Offset 5" Thick Seat, 3" Pad Mount	\$ 237
<input type="checkbox"/>	34471	<input type="checkbox"/>	34471	1/2" Offset 5.5" Thick Seat, 3" Pad Mount	\$ 237
<input type="checkbox"/>	34479	<input type="checkbox"/>	34479	1/2" Offset 6" Thick Seat, 3" Pad Mount	\$ 237

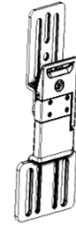

<b>LEFT</b>		<b>RIGHT</b>		<i>1/2" Offset, 5" Pad Mount</i>	
<input type="checkbox"/>	None	<input type="checkbox"/>	None		
<input type="checkbox"/>	34440	<input type="checkbox"/>	34440	1/2" Offset 3.5" Thick Seat, 5" Pad Mount	\$ 237
<input type="checkbox"/>	34448	<input type="checkbox"/>	34448	1/2" Offset 4" Thick Seat, 5" Pad Mount	\$ 237
<input type="checkbox"/>	34456	<input type="checkbox"/>	34456	1/2" Offset 4.5" Thick Seat, 5" Pad Mount	\$ 237
<input type="checkbox"/>	34464	<input type="checkbox"/>	34464	1/2" Offset 5" Thick Seat, 5" Pad Mount	\$ 237
<input type="checkbox"/>	34472	<input type="checkbox"/>	34472	1/2" Offset 5.5" Thick Seat, 5" Pad Mount	\$ 237
<input type="checkbox"/>	34480	<input type="checkbox"/>	34480	1/2" Offset 6" Thick Seat, 5" Pad Mount	\$ 237



<b>LEFT</b>		<b>RIGHT</b>		<i>1" Offset, 3" Pad Mount</i>	
<input type="checkbox"/>	None	<input type="checkbox"/>	None		
<input type="checkbox"/>	34441	<input type="checkbox"/>	34441	1" Offset 3.5" Thick Seat, 3" Pad Mount	\$ 237
<input type="checkbox"/>	34449	<input type="checkbox"/>	34449	1" Offset 4" Thick Seat, 3" Pad Mount	\$ 237
<input type="checkbox"/>	34457	<input type="checkbox"/>	34457	1" Offset 4.5" Thick Seat, 3" Pad Mount	\$ 237
<input type="checkbox"/>	34465	<input type="checkbox"/>	34465	1" Offset 5" Thick Seat, 3" Pad Mount	\$ 237
<input type="checkbox"/>	34473	<input type="checkbox"/>	34473	1" Offset 5.5" Thick Seat, 3" Pad Mount	\$ 237
<input type="checkbox"/>	34481	<input type="checkbox"/>	34481	1" Offset 6" Thick Seat, 3" Pad Mount	\$ 237

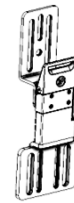

<b>LEFT</b>		<b>RIGHT</b>		<i>1" Offset, 5" Pad Mount</i>	
<input type="checkbox"/>	None	<input type="checkbox"/>	None		
<input type="checkbox"/>	34442	<input type="checkbox"/>	34442	1" Offset 3.5" Thick Seat, 5" Pad Mount	\$ 237
<input type="checkbox"/>	34450	<input type="checkbox"/>	34450	1" Offset 4" Thick Seat, 5" Pad Mount	\$ 237
<input type="checkbox"/>	34458	<input type="checkbox"/>	34458	1" Offset 4.5" Thick Seat, 5" Pad Mount	\$ 237
<input type="checkbox"/>	34466	<input type="checkbox"/>	34466	1" Offset 5" Thick Seat, 5" Pad Mount	\$ 237
<input type="checkbox"/>	34474	<input type="checkbox"/>	34474	1" Offset 5.5" Thick Seat, 5" Pad Mount	\$ 237
<input type="checkbox"/>	34482	<input type="checkbox"/>	34482	1" Offset 6" Thick Seat, 5" Pad Mount	\$ 237



<b>LEFT</b>		<b>RIGHT</b>		<i>2" Offset, 3" Pad Mount</i>	
<input type="checkbox"/>	None	<input type="checkbox"/>	None		
<input type="checkbox"/>	34443	<input type="checkbox"/>	34443	2" Offset 3.5" Thick Seat, 3" Pad Mount	\$ 237
<input type="checkbox"/>	34451	<input type="checkbox"/>	34451	2" Offset 4" Thick Seat, 3" Pad Mount	\$ 237
<input type="checkbox"/>	34459	<input type="checkbox"/>	34459	2" Offset 4.5" Thick Seat, 3" Pad Mount	\$ 237
<input type="checkbox"/>	34467	<input type="checkbox"/>	34467	2" Offset 5" Thick Seat, 3" Pad Mount	\$ 237
<input type="checkbox"/>	34475	<input type="checkbox"/>	34475	2" Offset 5.5" Thick Seat, 3" Pad Mount	\$ 237
<input type="checkbox"/>	34483	<input type="checkbox"/>	34483	2" Offset 6" Thick Seat, 3" Pad Mount	\$ 237

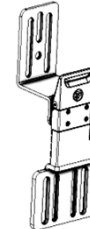

<b>LEFT</b>		<b>RIGHT</b>		<i>2" Offset, 5" Pad Mount</i>	
<input type="checkbox"/>	None	<input type="checkbox"/>	None		
<input type="checkbox"/>	34444	<input type="checkbox"/>	34444	2" Offset 3.5" Thick Seat, 5" Pad Mount	\$ 237
<input type="checkbox"/>	34452	<input type="checkbox"/>	34452	2" Offset 4" Thick Seat, 5" Pad Mount	\$ 237
<input type="checkbox"/>	34460	<input type="checkbox"/>	34460	2" Offset 4.5" Thick Seat, 5" Pad Mount	\$ 237
<input type="checkbox"/>	34468	<input type="checkbox"/>	34468	2" Offset 5" Thick Seat, 5" Pad Mount	\$ 237
<input type="checkbox"/>	34476	<input type="checkbox"/>	34476	2" Offset 5.5" Thick Seat, 5" Pad Mount	\$ 237
<input type="checkbox"/>	34484	<input type="checkbox"/>	34484	2" Offset 6" Thick Seat, 5" Pad Mount	\$ 237



## Medial Thigh Supports

### Flipdown Hardware Kits w/Pad Only (no cover) E0957 and E102

- |                          |   |        |
|--------------------------|---|--------|
| <input type="checkbox"/> | 31495L Abductor Flip-Down w/ Large Molded Pad | \$ 257 |
| <input type="checkbox"/> | 31495M Abductor Flip-Down w/Medium Molded Pad | \$ 257 |
| <input type="checkbox"/> | 31495P Abductor Flip-Down w/ Narrow Gel Pad   | \$ 289 |
| <input type="checkbox"/> | 31495S Abductor Flip-Down w/ Small Molded Pad | \$ 257 |

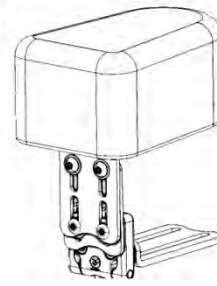

### Flipdown Bracket (no Pad) E1028

- |                          |   |        |
|--------------------------|---|--------|
| <input type="checkbox"/> | 50180 Abductor Hardware, Stainless Steel Flip-Dow | \$ 185 |
|--------------------------|---|--------|

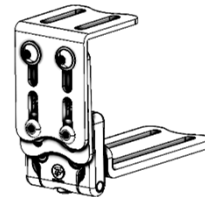

### Heavy Duty Flipdown Bracket E1028

- |                          |   |        |
|--------------------------|---|--------|
| <input type="checkbox"/> | 50700 Narrow Flip-Down for 1-5/8" to 3" Thick Sea | \$ 282 |
| <input type="checkbox"/> | 50701 Narrow Flip-Down for 3" to 4-1/4" Thick Sea | \$ 282 |
| <input type="checkbox"/> | 50702 Narrow Flip-Down for 4" to 5-1/2" Thick Sea | \$ 282 |

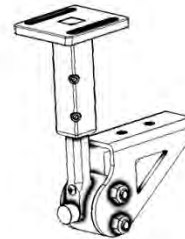

### Medial Thigh Pads E0957

#### Pad with Cover

- |                          |                                    |        |
|--------------------------|------------------------------------|--------|
| <input type="checkbox"/> | 50285 Pad, Molded w/ Cover, Small  | \$ 144 |
| <input type="checkbox"/> | 50286 Pad, Molded w/ Cover, Medium | \$ 144 |
| <input type="checkbox"/> | 50287 Pad, Molded w/ Cover, Large  | \$ 145 |

#### Pad without Cover

- |                          |                                    |       |
|--------------------------|------------------------------------|-------|
| <input type="checkbox"/> | 31429 Abductor Pad, Molded, Small  | \$ 92 |
| <input type="checkbox"/> | 31430 Abductor Pad, Molded, Medium | \$ 92 |
| <input type="checkbox"/> | 31431 Abductor Pad, Molded, Large  | \$ 92 |

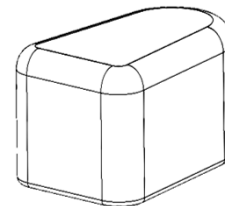

#### Gel Pads

- |                          |  |        |
|--------------------------|--|--------|
| <input type="checkbox"/> | 50288 Abductor Pad, Narrow Molded Gel w/ Remov | \$ 155 |
|--------------------------|--|--------|

#### Custom Pad

- |                          |                           |        |
|--------------------------|---------------------------|--------|
| <input type="checkbox"/> | 50037 Custom Abductor Pad | \$ 397 |
|--------------------------|---------------------------|--------|

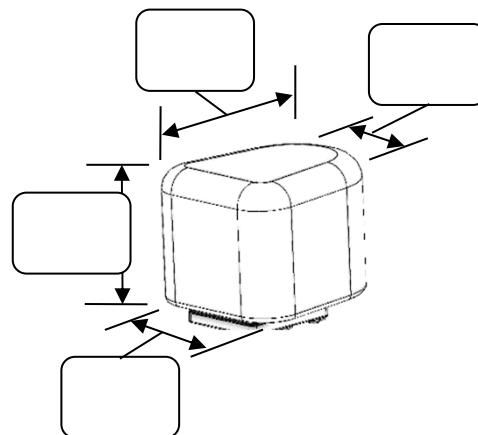

## Lateral Knee Supports

### Muti-Axis Knee Adductor and Pad Each K0108

7/8" Tubing	<input type="checkbox"/>	31547	7/8" Mount, Small Pad, Each	\$255.00
	<input type="checkbox"/>	31548	7/8" Mount, Medium Pad, Each	\$255.00
	<input type="checkbox"/>	31549	7/8" Mount, Large Pad, Each	\$255.00
1" Tubing	<input type="checkbox"/>	31532	1" Mount, Small Pad, Each	\$255.00
	<input type="checkbox"/>	31533	1" Mount, Medium Pad, Each	\$255.00
	<input type="checkbox"/>	31534	1" Mount, Large Pad, Each	\$255.00

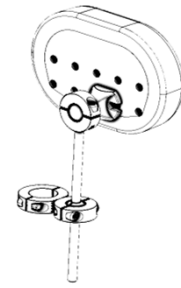

### Muti-Axis Knee Adductor and Pad Pair K0108

7/8" Tubing	<input type="checkbox"/>	50277	7/8" Mount, Small Pad, Pair	\$507.00
	<input type="checkbox"/>	50278	7/8" Mount, Medium Pad, Pair	\$507.00
	<input type="checkbox"/>	50279	7/8" Mount, Large Pad, Pair	\$507.00
1" Tubing	<input type="checkbox"/>	50280	1" Mount, Small Pad, Pair	\$507.00
	<input type="checkbox"/>	50281	1" Mount, Medium Pad, Pair	\$507.00
	<input type="checkbox"/>	50282	1" Mount, Large Pad, Pair	\$507.00

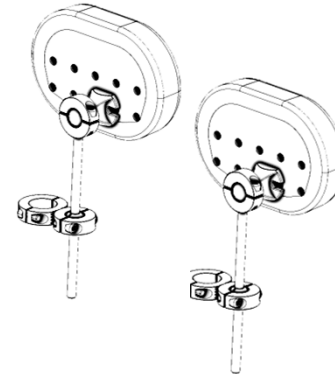

### Flip Down Knee Adductor w/Short Arm E1028 (order pad below)

3/4" OR 7/8" OR 1" Tubing	<input type="checkbox"/>	30271	Short Arm for 3/4" OR 7/8" OR 1" Tubing, Left	\$306.00
	<input type="checkbox"/>	30272	Short Arm for 3/4" OR 7/8" OR 1" Tubing, Right	\$306.00
	<input type="checkbox"/>	30248	Short Arm for 3/4" OR 7/8" OR 1" Tubing, Pair	\$610.00
1 1/8" Tubing	<input type="checkbox"/>	32979	Short Arm for 1.125" Tubing, Left	\$355.00
	<input type="checkbox"/>	32980	Short Arm for 1.125" Tubing, Right	\$355.00
	<input type="checkbox"/>	32982	Short Arm for 1.125" Tubing, Pair	\$710.00
1 1/4" Tubing	<input type="checkbox"/>	30092	Short Arm for 1.25" Tubing, Left	\$355.00
	<input type="checkbox"/>	30093	Short Arm for 1.25" Tubing, Right	\$355.00
	<input type="checkbox"/>	30083	Short Arm for 1.25" Tubing, Pair	\$710.00
1 3/8" Tubing	<input type="checkbox"/>	32971	Short Arm for 1.375" Tubing, Left	\$366.00
	<input type="checkbox"/>	32972	Short Arm for 1.375" Tubing, Right	\$366.00
	<input type="checkbox"/>	32974	Short Arm for 1.375" Tubing, Par	\$731.00
Quantu m Tracks	<input type="checkbox"/>	30255	Short Arm for Quantum Channel, Left	\$306.00
	<input type="checkbox"/>	30256	Short Arm for Quantum Channel, Right	\$306.00
	<input type="checkbox"/>	30240	Short Arm for Quantum Channel, Pair	\$610.00

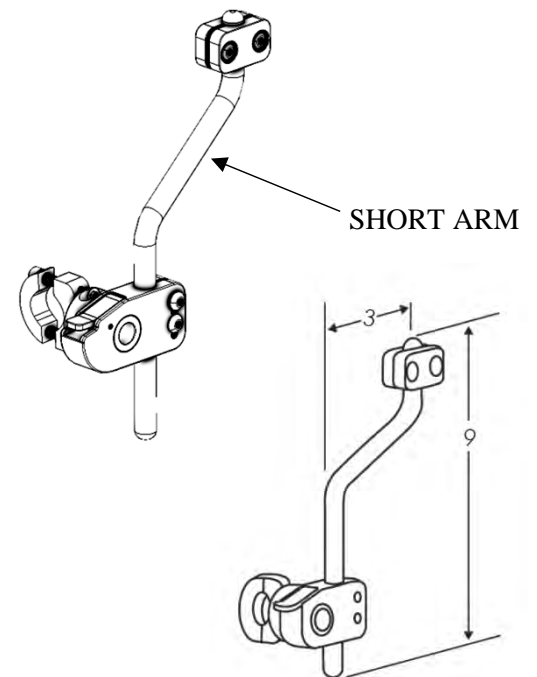

### Flip Down Knee Adductor w/Long Arm E1028 (order pad below)

3/4" OR 7/8" OR 1" Tubing	<input type="checkbox"/>	30079	Long Arm for 3/4" OR 7/8" OR 1" Tubing, Left	\$306.00
	<input type="checkbox"/>	30080	Long Arm for 3/4" OR 7/8" OR 1" Tubing, Right	\$306.00
	<input type="checkbox"/>	30284	Long Arm for 3/4" OR 7/8" OR 1" Tubing, Pair	\$610.00
1 1/8" Tubing	<input type="checkbox"/>	32977	Long Arm for 1.125" Tubing, Left	\$355.00
	<input type="checkbox"/>	32978	Long Arm for 1.125" Tubing, Right	\$355.00
	<input type="checkbox"/>	32981	Long Arm for 1.125" Tubing, Pair	\$710.00
1 1/4" Tubing	<input type="checkbox"/>	30090	Long Arm for 1.25" Tubing, Left	\$355.00
	<input type="checkbox"/>	30091	Long Arm for 1.25" Tubing, Right	\$355.00
	<input type="checkbox"/>	30082	Long Arm for 1.25" Tubing, Pair	\$710.00
1 3/8" Tubing	<input type="checkbox"/>	32969	Long Arm for 1.375" Tubing, Left	\$366.00
	<input type="checkbox"/>	32970	Long Arm for 1.375" Tubing, Right	\$366.00
	<input type="checkbox"/>	32973	Long Arm for 1.375" Tubing, Par	\$731.00
Quantum Tracks	<input type="checkbox"/>	30291	Long Arm for Quantum Channel, Left	\$306.00
	<input type="checkbox"/>	30292	Long Arm for Quantum Channel, Right	\$306.00
	<input type="checkbox"/>	30276	Long Arm for Quantum Channel, Pair	\$610.00

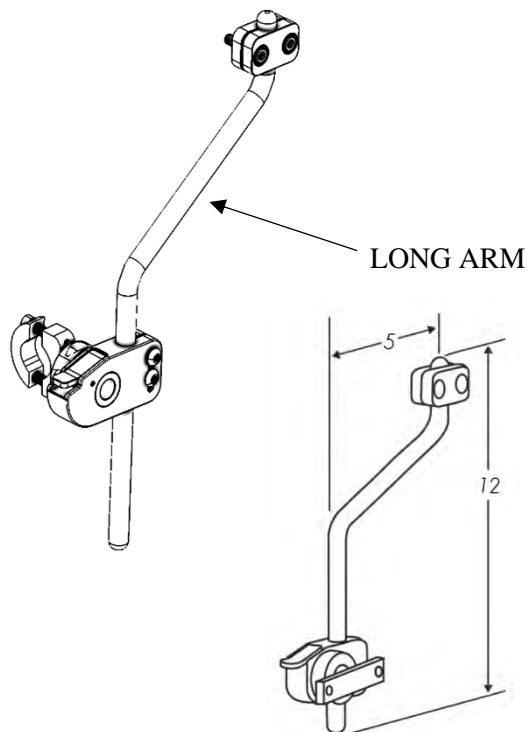

### Lateral Knee Pads E0957

Qty		<b>Pad with Neoprene Cover Ea</b>	
<input type="checkbox"/>	50490	Knee Adductor Pad w/ Neoprene Cover, 3x4	\$119.00
<input type="checkbox"/>	50491	Knee Adductor Pad w/ Neoprene Cover, 4x6	\$119.00
<input type="checkbox"/>	50492	Knee Adductor Pad w/ Neoprene Cover, 5x7	\$119.00

Qty		<b>Pad without Cover Ea</b>	
<input type="checkbox"/>	31460S	Knee Adductor Pad, 3x4	\$ 74.00
<input type="checkbox"/>	31460M	Knee Adductor Pad, 4x6	\$ 74.00
<input type="checkbox"/>	31460L	Knee Adductor Pad, 5x7	\$ 78.00

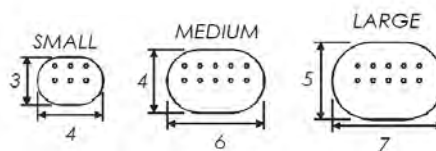
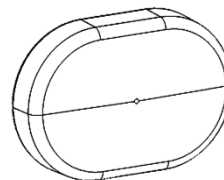

### Lateral Knee Pads Covers K0108

Qty		<b>Cover with Gel Insert</b>	
<input type="checkbox"/>	50048	Cover w/ Gel Insert, Small	\$128.00
<input type="checkbox"/>	50049	Cover w/ Gel Insert, Medium	\$128.00
<input type="checkbox"/>	50050	Cover w/ Gel Insert, Large	\$128.00

Qty		<b>Neoprene Cover</b>	
<input type="checkbox"/>	32383	Adductor Pad Cover, Neoprene, Small	\$ 67.00
<input type="checkbox"/>	32384	Adductor Pad Cover, Neoprene, Medium	\$ 67.00
<input type="checkbox"/>	32385	Adductor Pad Cover, Neoprene, Large	\$ 67.00

Qty		<b>Custom Pad E0955 Each</b>	
<input type="checkbox"/>	50493	Custom Abductor Pad	\$194.00

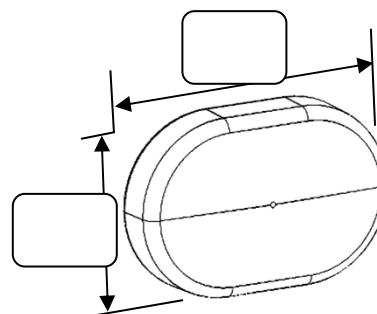

## TheraFit 4 Point Hip Belt

### *PUSH BUTTON BUCKLE*

#### 1" Straps, 4.25L x 1.75H Pads E0978

<input type="checkbox"/>	60125 Adjustable straps, metal buckle	\$138.00
<input type="checkbox"/>	60490 Adjustable straps, security buckle	\$148.00
<input type="checkbox"/>	60135 Adjustable straps, plastic side release buckle	\$134.00
<input type="checkbox"/>	60130 Fixed straps, metal buckle	\$130.00
<input type="checkbox"/>	60494 Fixed straps, security buckle	\$141.00
<input type="checkbox"/>	60140 Fixed straps, plastic side release buckle	\$127.00

#### 1" Straps, 5.25L x 1.75H Pads E0978

<input type="checkbox"/>	60126 Adjustable straps, metal buckle	\$138.00
<input type="checkbox"/>	60491 Adjustable straps, security buckle	\$148.00
<input type="checkbox"/>	60136 Adjustable straps, plastic side release buckle	\$134.00
<input type="checkbox"/>	60131 Fixed straps, metal buckle	\$130.00
<input type="checkbox"/>	60494 Fixed straps, security buckle	\$141.00
<input type="checkbox"/>	60495 Fixed straps, plastic side release buckle	\$141.00

#### 1.5" Straps, 5.25L x 2.25H Pads E0978

<input type="checkbox"/>	60127 Adjustable straps, metal buckle	\$138.00
<input type="checkbox"/>	60492 Adjustable straps, security buckle	\$148.00
<input type="checkbox"/>	60137 Adjustable straps, plastic side release buckle	\$134.00
<input type="checkbox"/>	60132 Fixed straps, metal buckle	\$130.00
<input type="checkbox"/>	60496 Fixed straps, security buckle	\$141.00
<input type="checkbox"/>	60142 Fixed straps, plastic side release buckle	\$127.00

#### 1.5" Straps, 7.25L x 2.25H Pads E0978

<input type="checkbox"/>	60128 Adjustable straps, metal buckle	\$138.00
<input type="checkbox"/>	60493 Adjustable straps, security buckle	\$148.00
<input type="checkbox"/>	60138 Adjustable straps, plastic side release buckle	\$134.00
<input type="checkbox"/>	60133 Fixed straps, metal buckle	\$130.00
<input type="checkbox"/>	60497 Fixed straps, security buckle	\$141.00
<input type="checkbox"/>	60143 Fixed straps, plastic side release buckle	\$127.00

#### Y-Style Pads, 1" Straps, 6" long Pads E0978

<input type="checkbox"/>	60024 Adjustable straps, metal buckle	\$169.00
<input type="checkbox"/>	60046 Adjustable straps, security buckle	\$181.00
<input type="checkbox"/>	60027 Adjustable straps, plastic side release buckle	\$164.00

#### Y-Style Pads, 1.5" Straps, 9" long Pads E0978

<input type="checkbox"/>	60025 Adjustable straps, metal buckle	\$169.00
<input type="checkbox"/>	60047 Adjustable straps, security buckle	\$181.00
<input type="checkbox"/>	60028 Adjustable straps, plastic side release buckle	\$164.00

#### Y-Style Pads, 2" Straps, 11" long Pads E0978

<input type="checkbox"/>	60026 Adjustable straps, metal buckle	\$169.00
<input type="checkbox"/>	60048 Adjustable straps, security buckle	\$181.00
<input type="checkbox"/>	60029 Adjustable straps, plastic side release buckle	\$164.00



## TheraFit Single Pull Hip Belt

### *PUSH BUTTON BUCKLE*

#### Single Pull 1" Straps, 4.25L x 1.75H Pads E0978

<input type="checkbox"/>	61001 Belt w/Clips	\$ 82.00
<input type="checkbox"/>	61002 Belt w/Cams	\$ 82.00
<input type="checkbox"/>	61003 Belt w/Clips AND Cams	\$ 87.00

#### Single Pull 1" Straps, 5.25L x 1.75H Pads E0978

<input type="checkbox"/>	61101 Belt w/Clips	\$ 82.00
<input type="checkbox"/>	61102 Belt w/Cams	\$ 82.00
<input type="checkbox"/>	61103 Belt w/Clips AND Cams	\$ 85.00

#### Single Pull 1" Straps, 6.25L x 1.75H Pads E0978

<input type="checkbox"/>	61201 Belt w/Clips	\$ 82.00
<input type="checkbox"/>	61202 Belt w/Cams	\$ 82.00
<input type="checkbox"/>	61203 Belt w/Clips AND Cams	\$ 85.00

#### Single Pull 1.5" Straps, 5.25L x 2.25H Pads E0978

<input type="checkbox"/>	62001 Belt w/Clips	\$ 91.00
<input type="checkbox"/>	62002 Belt w/Cams	\$104.00
<input type="checkbox"/>	62003 Belt w/Clips AND Cams	\$109.00

#### Single Pull 1.5" Straps, 7.25L x 2.25H Pads E0978

<input type="checkbox"/>	62101 Belt w/Clips	\$ 91.00
<input type="checkbox"/>	62102 Belt w/Cams	\$104.00
<input type="checkbox"/>	62103 Belt w/Clips AND Cams	\$109.00

#### Single Pull 1.5" Straps, 9.25L x 2.25H Pads E0978

<input type="checkbox"/>	62201 Belt w/Clips	\$ 91.00
<input type="checkbox"/>	62202 Belt w/Cams	\$104.00
<input type="checkbox"/>	62203 Belt w/Clips AND Cams	\$109.00

#### Single Pull 2" Straps, 9.25L x 3H Pads E0978

<input type="checkbox"/>	64001 Belt w/Clips	\$ 97.00
<input type="checkbox"/>	64002 Belt w/Cams	\$111.00
<input type="checkbox"/>	64003 Belt w/Clips AND Cams	\$115.00

#### Single Pull 2" Straps, 11.25L x 3H Pads E0978

<input type="checkbox"/>	64101 Belt w/Clips	\$ 97.00
<input type="checkbox"/>	64102 Belt w/Cams	\$111.00
<input type="checkbox"/>	64103 Belt w/Clips AND Cams	\$115.00

#### Bariatric Single Pull 2" Straps, 11.25L x 3H Pads E0978

<input type="checkbox"/>	64301 Belt w/Clips	\$108.00
<input type="checkbox"/>	64302 Belt w/Cams	\$129.00
<input type="checkbox"/>	64303 Belt w/Clips AND Cams	\$131.00

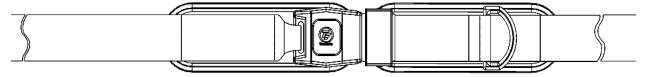

METAL CLIP



CAM LOCK BUCKLE



## TheraFit Single Pull Hip Belt

### SECURITY STYLE BUCKLE

#### Single Pull 1" Straps, 4.25L x 1.75H Pads E0978

<input type="checkbox"/>	60411 Belt w/Clips	\$ 94.00
<input type="checkbox"/>	60412 Belt w/Cams	\$ 94.00
<input type="checkbox"/>	60413 Belt w/Clips AND Cams	\$ 96.00

#### Single Pull 1" Straps, 5.25L x 1.75H Pad

<input type="checkbox"/>	60421 Belt w/Clips	\$ 94.00
<input type="checkbox"/>	60422 Belt w/Cams	\$ 94.00
<input type="checkbox"/>	60423 Belt w/Clips AND Cams	\$ 96.00

#### Single Pull 1" Straps, 6.25L x 1.75H Pads E0978

<input type="checkbox"/>	60431 Belt w/Clips	\$ 94.00
<input type="checkbox"/>	60432 Belt w/Cams	\$ 94.00
<input type="checkbox"/>	60433 Belt w/Clips AND Cams	\$ 96.00

#### Single Pull 1.5" Straps, 5.25L x 2.25H Pads

<input type="checkbox"/>	60441 Belt w/Clips	\$102.00
<input type="checkbox"/>	60442 Belt w/Cams	\$115.00
<input type="checkbox"/>	60443 Belt w/Clips AND Cams	\$119.00

#### Single Pull 1.5" Straps, 7.25L x 2.25H Pads E0978

<input type="checkbox"/>	60451 Belt w/Clips	\$102.00
<input type="checkbox"/>	60452 Belt w/Cams	\$115.00
<input type="checkbox"/>	60453 Belt w/Clips AND Cams	\$119.00

#### Single Pull 1.5" Straps, 9.25L x 2.25H Pads E0978

<input type="checkbox"/>	60461 Belt w/Clips	\$102.00
<input type="checkbox"/>	60462 Belt w/Cams	\$115.00
<input type="checkbox"/>	60463 Belt w/Clips AND Cams	\$119.00

#### Single Pull 2" Straps, 9.25L x 3H Pads E0978

<input type="checkbox"/>	60471 Belt w/Clips	\$109.00
<input type="checkbox"/>	60472 Belt w/Cams	\$121.00
<input type="checkbox"/>	60473 Belt w/Clips AND Cams	\$126.00

#### Single Pull 2" Straps, 11.25L x 3H Pads E0978

<input type="checkbox"/>	60481 Belt w/Clips	\$109.00
<input type="checkbox"/>	60482 Belt w/Cams	\$121.00
<input type="checkbox"/>	60483 Belt w/Clips AND Cams	\$126.00

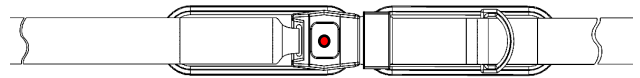

METAL CLIP



CAM LOCK BUCKLE

## TheraFit Single Pull Hip Belt

### *SIDE RELEASE STYLE BUCKLE*

#### **Single Pull 1" Straps, 4.25L x 1.75H Pads E0978**

- |                          |                             |          |
|--------------------------|-----------------------------|----------|
| <input type="checkbox"/> | 65001 Belt w/Clips          | \$ 76.00 |
| <input type="checkbox"/> | 65002 Belt w/Cams           | \$ 76.00 |
| <input type="checkbox"/> | 65003 Belt w/Clips AND Cams | \$ 78.00 |

#### **Single Pull 1" Straps, 5.25L x 1.75H Pads E0978**

- |                          |                             |          |
|--------------------------|-----------------------------|----------|
| <input type="checkbox"/> | 65101 Belt w/Clips          | \$ 76.00 |
| <input type="checkbox"/> | 65102 Belt w/Cams           | \$ 76.00 |
| <input type="checkbox"/> | 65103 Belt w/Clips AND Cams | \$ 78.00 |

#### **Single Pull 1" Straps, 6.25L x 1.75H Pads E0978**

- |                          |                             |          |
|--------------------------|-----------------------------|----------|
| <input type="checkbox"/> | 65201 Belt w/Clips          | \$ 76.00 |
| <input type="checkbox"/> | 65202 Belt w/Cams           | \$ 76.00 |
| <input type="checkbox"/> | 65203 Belt w/Clips AND Cams | \$ 78.00 |

#### **Single Pull 1.5" Straps, 5.25L x 2.25H Pads E0978**

- |                          |                             |          |
|--------------------------|-----------------------------|----------|
| <input type="checkbox"/> | 65301 Belt w/Clips          | \$ 84.00 |
| <input type="checkbox"/> | 65302 Belt w/Cams           | \$ 97.00 |
| <input type="checkbox"/> | 65303 Belt w/Clips AND Cams | \$101.00 |

#### **Single Pull 1.5" Straps, 7.25L x 2.25H Pads E0978**

- |                          |                             |          |
|--------------------------|-----------------------------|----------|
| <input type="checkbox"/> | 65401 Belt w/Clips          | \$ 84.00 |
| <input type="checkbox"/> | 65402 Belt w/Cams           | \$ 97.00 |
| <input type="checkbox"/> | 65403 Belt w/Clips AND Cams | \$101.00 |

#### **Single Pull 1.5" Straps, 9.25L x 2.25H Pads E0978**

- |                          |                             |          |
|--------------------------|-----------------------------|----------|
| <input type="checkbox"/> | 65501 Belt w/Clips          | \$ 84.00 |
| <input type="checkbox"/> | 65502 Belt w/Cams           | \$ 97.00 |
| <input type="checkbox"/> | 65503 Belt w/Clips AND Cams | \$101.00 |

#### **Single Pull 2" Straps, 9.25L x 3H Pads E0978**

- |                          |                             |          |
|--------------------------|-----------------------------|----------|
| <input type="checkbox"/> | 65601 Belt w/Clips          | \$ 90.00 |
| <input type="checkbox"/> | 65602 Belt w/Cams           | \$103.00 |
| <input type="checkbox"/> | 65603 Belt w/Clips AND Cams | \$108.00 |

#### **Single Pull 2" Straps, 11.25L x 3H Pads E0978**

- |                          |                             |          |
|--------------------------|-----------------------------|----------|
| <input type="checkbox"/> | 65701 Belt w/Clips          | \$ 90.00 |
| <input type="checkbox"/> | 65702 Belt w/Cams           | \$103.00 |
| <input type="checkbox"/> | 65703 Belt w/Clips AND Cams | \$108.00 |

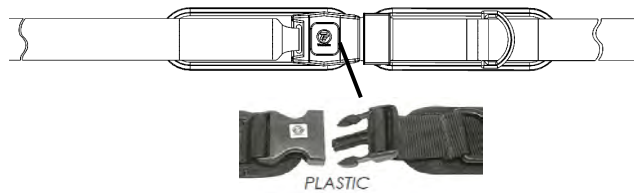

METAL CLIP



CAM LOCK BUCKLE

## TheraFit Single Pull Unpadde

### *PUSH BUTTON BUCKLE*

#### Single Pull 1" Straps, Unpadded E0978

- |                          |                    |          |
|--------------------------|--------------------|----------|
| <input type="checkbox"/> | 33120 Belt w/Clips | \$ 48.00 |
|--------------------------|--------------------|----------|

#### Single Pull 1.5" Straps, Unpadded E0978

- |                          |                             |          |
|--------------------------|-----------------------------|----------|
| <input type="checkbox"/> | 33130 Belt w/Clips AND Cams | \$ 48.00 |
|--------------------------|-----------------------------|----------|

#### Single Pull 2" Straps, Unpadded E0978

- |                          |  |          |
|--------------------------|--|----------|
| <input type="checkbox"/> | 33140 Belt w/Clips AND Cams            | \$ 48.00 |
| <input type="checkbox"/> | 33148 Extra Long 80" Long Belt w/Clips | \$ 54.00 |

### *SECURITY STYLE BUCKLE*

#### Single Pull 1" Straps, Unpadded E0978

- |                          |                    |          |
|--------------------------|--------------------|----------|
| <input type="checkbox"/> | 33126 Belt w/Clips | \$ 62.00 |
|--------------------------|--------------------|----------|

#### Single Pull 1.5" Straps, Unpadded E0978

- |                          |                             |          |
|--------------------------|-----------------------------|----------|
| <input type="checkbox"/> | 60310 Belt w/Clips AND Cams | \$ 62.00 |
|--------------------------|-----------------------------|----------|

#### Single Pull 2" Straps, Unpadded E0978

- |                          |                             |          |
|--------------------------|-----------------------------|----------|
| <input type="checkbox"/> | 33146 Belt w/Clips AND Cams | \$ 62.00 |
|--------------------------|-----------------------------|----------|

### *SIDE RELEASE STYLE BUCKLE*

#### Single Pull 1" Straps, Unpadded E0978

- |                          |                    |          |
|--------------------------|--------------------|----------|
| <input type="checkbox"/> | 33127 Belt w/Clips | \$ 45.00 |
|--------------------------|--------------------|----------|

#### Single Pull 1.5" Straps, Unpadded E0978

- |                          |                             |          |
|--------------------------|-----------------------------|----------|
| <input type="checkbox"/> | 33136 Belt w/Clips AND Cams | \$ 45.00 |
|--------------------------|-----------------------------|----------|

#### Single Pull 2" Straps, Unpadded E0978

- |                          |                             |          |
|--------------------------|-----------------------------|----------|
| <input type="checkbox"/> | 33147 Belt w/Clips AND Cams | \$ 45.00 |
|--------------------------|-----------------------------|----------|

### *METAL FLAP (AIRPLANE) STYLE BUCKLE*

#### Single Pull 2" Straps, Unpadded E0978

- |                          |                    |          |
|--------------------------|--------------------|----------|
| <input type="checkbox"/> | 33149 Belt w/Clips | \$ 81.00 |
|--------------------------|--------------------|----------|

### *PUSH BUTTON BUCKLE*

#### Push Button (Travis Logo) Single Pull 1.5" Straps, Unpadded E0978

- |                          |                    |          |
|--------------------------|--------------------|----------|
| <input type="checkbox"/> | 60129 Belt w/Clips | \$ 48.00 |
|--------------------------|--------------------|----------|

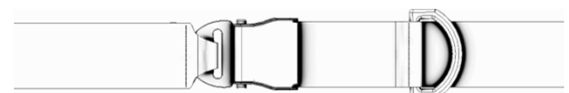
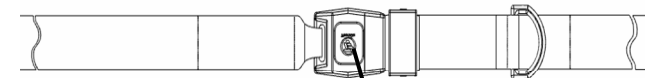
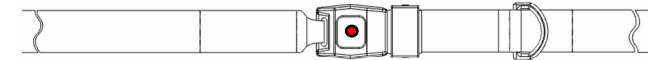
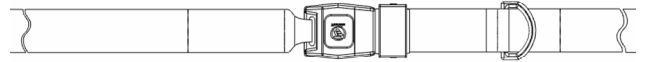

## TheraFit Slip on Pads

### Slip on Pads for 1" Strap Width K0108

- 33178 Slip on Hip Belt Pad 4.25W x 1.75 H, Pair \$ 54.00
- 33179 Slip on Hip Belt Pad 5.25W x 1.75 H, Pair \$ 54.00
- 33180 Slip on Hip Belt Pad 6.25W x 1.75 H, Pair \$ 54.00

### Slip on Pads for 1.5" Strap Width K0108

- 33181 Slip on Hip Belt Pad 5.25W x 2.25 H, Pair \$ 54.00
- 33182 Slip on Hip Belt Pad 7.25W x 2.25 H, Pair \$ 54.00
- 33183 Slip on Hip Belt Pad 9.25W x 2.5 H, Pair \$ 54.00
- 33186 Slip on Hip Belt Pad 10.25W x 2.5 H, Pair \$ 54.00

### Slip on Pads for 2" Strap Width K0108

- 33184 Slip on Hip Belt Pad 9.25W x 3 H, Pair \$ 54.00
- 33187 Slip on Hip Belt Pad 10.25W x 3 H, Pair \$ 54.00
- 33185 Slip on Hip Belt Pad 11.25W x 3 H, Pair \$ 54.00



## TheraFit Rear Pull Hip Belt

### PUSH BUTTON BUCKLE

#### Single Pull 1" Straps, 6.25L x 1.75H Pads E0978

- 60161 Belt w/Clips \$ 94.00
- 60162 Belt w/Cams \$ 94.00
- 60163 Belt w/Clips AND Cams \$ 96.00

#### Single Pull 1.5" Straps, 7.25L x 2.25H Pads E0978

- 60171 Belt w/Clips \$102.00
- 60172 Belt w/Cams \$115.00
- 60173 Belt w/Clips AND Cams \$119.00

#### Single Pull 1.5" Straps, 9.25L x 2.5H Pads E0978

- 60181 Belt w/Clips \$102.00
- 60182 Belt w/Cams \$115.00
- 60183 Belt w/Clips AND Cams \$119.00

### SECURITY STYLE BUCKLE

#### Single Pull 1" Straps, 6.25L x 1.75H Pads E0978

- 60311 Belt w/Clips \$104.00
- 60312 Belt w/Cams \$104.00
- 60313 Belt w/Clips AND Cams \$106.00

#### Single Pull 1.5" Straps, 7.25L x 2.25H Pads E0978

- 60321 Belt w/Clips \$113.00
- 60322 Belt w/Cams \$126.00
- 60323 Belt w/Clips AND Cams \$130.00

#### Single Pull 1.5" Straps, 9.25L x 2.5H Pads E0978

- 60331 Belt w/Clips \$113.00
- 60332 Belt w/Cams \$126.00
- 60333 Belt w/Clips AND Cams \$130.00

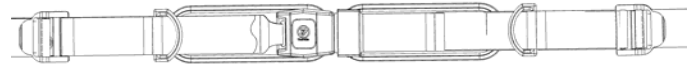

METAL CLIP



CAM LOCK BUCKLE

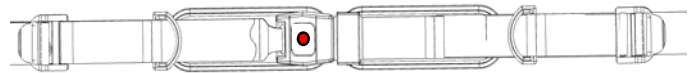

METAL CLIP



CAM LOCK BUCKLE

## TheraFit Center Pull Hip Belt

### *SIDE RELEASE STYLE BUCKLE*

#### Center Pull 1" Straps, 4.25L x 1.75H Pads E0978

<input type="checkbox"/>	60211 Belt w/Clips	\$ 77.00
<input type="checkbox"/>	60212 Belt w/Cams	\$ 77.00
<input type="checkbox"/>	60213 Belt w/Clips AND Cams	\$ 80.00

#### Center Pull 1" Straps, 5.25L x 1.75H Pads E0978

<input type="checkbox"/>	60221 Belt w/Clips	\$ 77.00
<input type="checkbox"/>	60222 Belt w/Cams	\$ 77.00
<input type="checkbox"/>	60223 Belt w/Clips AND Cams	\$ 80.00

#### Center Pull 1.5" Straps, 5.25L x 2.25H Pads E0978

<input type="checkbox"/>	60231 Belt w/Clips	\$ 85.00
<input type="checkbox"/>	60232 Belt w/Cams	\$ 98.00
<input type="checkbox"/>	60233 Belt w/Clips AND Cams	\$102.00

#### Center Pull 1.5" Straps, 7.25L x 2.25H Pads E0978

<input type="checkbox"/>	60241 Belt w/Clips	\$ 85.00
<input type="checkbox"/>	60242 Belt w/Cams	\$ 98.00
<input type="checkbox"/>	60243 Belt w/Clips AND Cams	\$102.00



## Hip Belt Accessories

### Hip Belt Extender Straps K0108

<input type="checkbox"/>	60144 Belt Extender Straps, 1" Pair	\$ 41.00
<input type="checkbox"/>	60145 Belt Extender Straps, 1.5" Pair	\$ 41.00
<input type="checkbox"/>	60146 Belt Extender Straps, 2" Pair	\$ 41.00

#### BELT EXTENDER STRAPS, EACH 24" LONG



### Hinged Collar K0108

	50410 Collar, Hinged - 7/8", 1" & 1-1/8" Diameter	\$ 22.00
<input type="checkbox"/>	_____ (Insert quantity)	

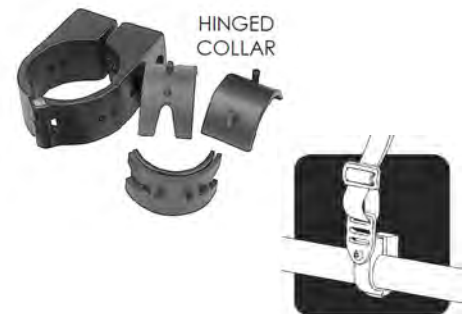

## Seat Harness

### *STATIC SEAT HARNESS*

#### **Static Front Pull**

<input type="checkbox"/>	50726 Small	\$192.00
<input type="checkbox"/>	50727 Medium	\$192.00
<input type="checkbox"/>	50728 Large	\$192.00

#### **Static Rear Pull**

<input type="checkbox"/>	50729 Small	\$192.00
<input type="checkbox"/>	50730 Medium	\$192.00
<input type="checkbox"/>	50731 Large	\$192.00

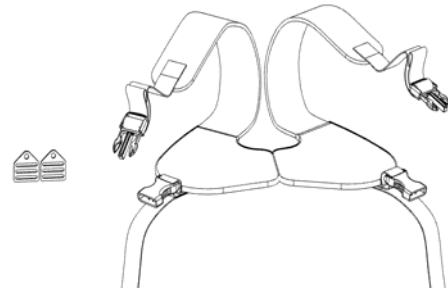

### *LEGACY (STRETCH) SEAT HARNESS*

#### **Stretch Harness**

<input type="checkbox"/>	30516 Small	\$186.00
<input type="checkbox"/>	30517 Medium	\$186.00
<input type="checkbox"/>	30518 Large	\$186.00



# TheraFit Shoulder Harness

## Shoulder Harness with Clips E0960

- 61301 Shoulder Harness, TheraFit, X-Small w/ Clip \$ 156
- 61401 Shoulder Harness, TheraFit, Small w/ Clips \$ 151
- 61501 Shoulder Harness, TheraFit, Medium w/ Clip \$ 157
- 61701 Shoulder Harness, TheraFit, Large w/ Clips \$ 164
- 61801 Shoulder Harness, TheraFit, X-Large w/ Clip \$ 171

## Shoulder Harness with Camlocks E0960

- 61302 Shoulder Harness, TheraFit, X-Small w/ Can \$ 156
- 61402 Shoulder Harness, TheraFit, Small w/ Camlo \$ 151
- 61502 Shoulder Harness, TheraFit, Medium w/ Can \$ 157
- 61702 Shoulder Harness, TheraFit, Large w/ Camlo \$ 164
- 61802 Shoulder Harness, TheraFit, X-Large w/ Can \$ 171

## Shoulder Harness with Clips and Camlocks E0960

- 61303 Shoulder Harness, TheraFit, X-Small w/ Clip \$ 156
- 61403 Shoulder Harness, TheraFit, Small w/ Clips & \$ 151
- 61503 Shoulder Harness, TheraFit, Medium w/ Clip \$ 157
- 61703 Shoulder Harness, TheraFit, Large w/ Clips & \$ 164
- 61803 Shoulder Harness, TheraFit, X-Large w/ Clip \$ 171

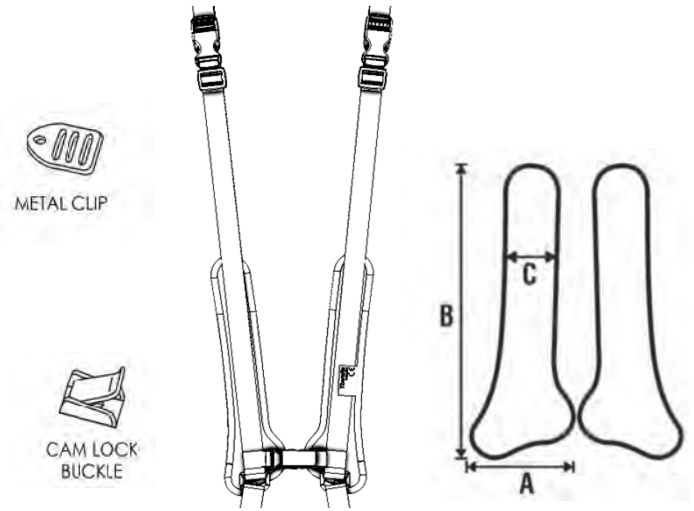

Harness Dimensions (inches)	A	B	C
X-SMALL	2.7	8.6	1.4
SMALL	3.0	12.0	1.8
MEDIUM	3.4	13.4	2.0
LARGE	4.0	16.1	2.3
X-LARGE	4.5	18.2	2.6



## Stretch TheraFit Vest

### Full Shape with Comfort Fit Straps E0960

- 30589 Vest, Full, Small \$ 161
- 30590 Vest, Full, Medium \$ 161
- 30591 Vest, Full, Large \$ 161
- 30592 Vest, Full, X-Large \$ 161
- 30593 Vest, Full, 2X-Large \$ 169

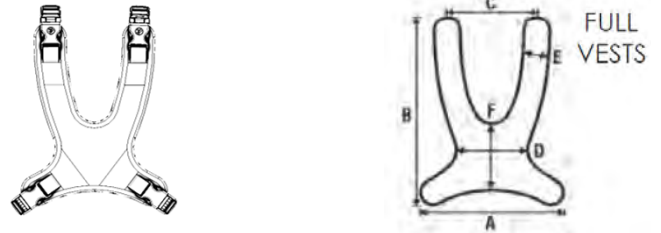

Vest Dimensions (inches)	A	B	C	D	E	F
Full SMALL	9.5	12.5	5.5	5	2	5
Full MEDIUM	11.25	15	7	5.75	2	5.5
Full LARGE	13.5	18	8.5	7	2.5	6.5
Full X-LARGE	15.75	21	10	8	3	7.5
Full 2X-LARGE	18	24	11	9.25	3.5	8.5

### Trim Shape with Comfort Fit Straps E0960

- 30601 Vest, Trim, Early Intervention \$ 163
- 30618 Vest, Trim, Small \$ 163
- 30619 Vest, Trim, Medium \$ 163
- 30620 Vest, Trim, Large \$ 163
- 30621 Vest, Trim, X-Large \$ 169
- 30622 Vest, Trim, 2X-Large \$ 169

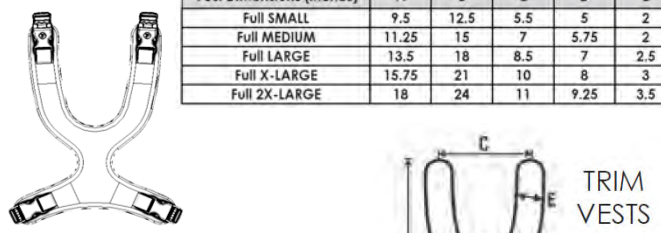

Vest Dimensions (inches)	A	B	C	D	E	F
Trim EARLY INTERVENTION	7.25	10.5	6.25	1	1.5	4
Trim SMALL	9.5	12.5	6	2	2	5.5
Trim MEDIUM	11.25	15	7	2.5	2	6
Trim LARGE	13.5	18	8.5	3	2.5	7.25
Trim X-LARGE	15.75	21	10	3.5	3	8.5
Trim 2X-LARGE	18	24	11	4.25	3.5	9.5

### Full Shape with Extended Straps Straps E0960

- 30594 Vest, Full, Small \$ 161
- 30595 Vest, Full, Medium \$ 161
- 30596 Vest, Full, Large \$ 161
- 30597 Vest, Full, X-Large \$ 169
- 30598 Vest, Full, 2X-Large \$ 169

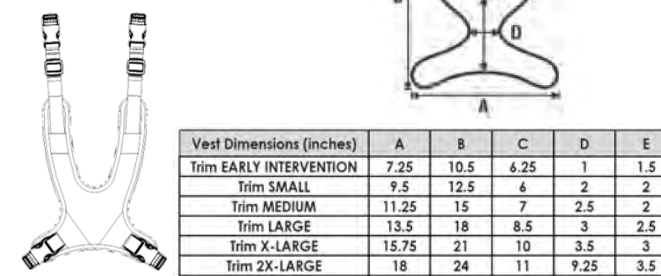

### Trim Shape with Comfort Fit Straps E0960

- 30603 Vest, Trim, Early Intervention \$ 163
- 30604 Vest, Trim, Small \$ 163
- 30624 Vest, Trim, Medium \$ 163
- 30625 Vest, Trim, Large \$ 163
- 30626 Vest, Trim, X-Large \$ 169
- 30627 Vest, Trim, 2X-Large \$ 169





## Non-Stretch Legacy Vest

### Full Shape with No-Sew Buckles (Comfort Fit) E0960

<input type="checkbox"/>	30479 Static,w/ No-Sew Buckles, Full, Small	\$ 166
<input type="checkbox"/>	30480 Static w/ No-Sew Buckles, Full, Medium	\$ 166
<input type="checkbox"/>	30481 Static w/ No-Sew Buckles, Male, Large	\$ 166
<input type="checkbox"/>	30507 Static w/ No-Sew Buckles, Male, X-Large	\$ 166

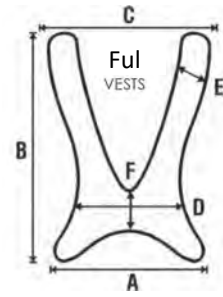

### Trim Shape with No-Sew Buckles (Comfort Fit) E09

<input type="checkbox"/>	30482 Static w/ No-Sew Buckles, Trim, Small	\$ 166
<input type="checkbox"/>	30483 Static w/ No-Sew Buckles, Trim, Medium	\$ 166
<input type="checkbox"/>	30484 Static w/ No-Sew Buckles, Trim, Large	\$ 166

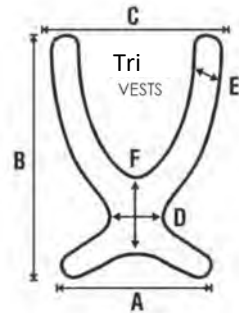

### Full Shape with Extended Straps E0960

<input type="checkbox"/>	51044 Static w/ Extended Straps, Full, X-Small	\$ 166
<input type="checkbox"/>	51045 Static w/ Extended Straps, Full, Small	\$ 166
<input type="checkbox"/>	51046 Static w/ Extended Straps, Full, Medium	\$ 166
<input type="checkbox"/>	51047 Static w/ Extended Straps, Full, Large	\$ 166
<input type="checkbox"/>	51048 Static w/ Extended Straps, Full, X-Large	\$ 166



Stretch & Non-Stretch Vests						
Vest Dimensions (inches)	A	B	C	D	E	F
Male X-SMALL	5.5	7.5	7.5	4.75	1.5	3.5
Male SMALL	7	12	8	5.5	1.75	2.75
Male MEDIUM	8.25	14	9.75	6.5	2.25	3
Male LARGE	8.75	17.25	12.5	6.75	2.5	5.25
Male X-LARGE	11	21.75	13	7.5	3	7
Female SMALL	7	11	8	2	2	5.25
Female MEDIUM	8	12.5	8	2	2	5.75
Female LARGE	8	16	10	2	2.25	7.5

### Trim Shape with Extended Straps E0960

<input type="checkbox"/>	51049 Static w/ Extended Straps, Trim, Small	\$ 166
<input type="checkbox"/>	51050 Static w/ Extended Straps, Trim, Medium	\$ 166
<input type="checkbox"/>	51051 Static w/ Extended Straps, Trim, Large	\$ 166

## TheraFit Zipper Vest

### Full Shape, Structured (Non-Stretch) E0960

<input type="checkbox"/>	30771 Structured, Zip-Up, Full, Small	\$ 177
<input type="checkbox"/>	30772 Structured, Zip-Up, Full, Medium	\$ 177
<input type="checkbox"/>	30773 Structured, Zip-Up, Full, Large	\$ 177

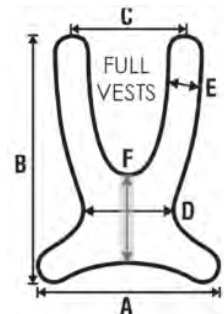
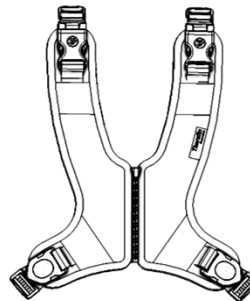

### Full Shape, Stretch (Non-Stretch) E0960

<input type="checkbox"/>	30777 Stretch, Zip-Up, Full, Small	\$ 177
<input type="checkbox"/>	30778 Stretch, Zip-Up, Full, Medium	\$ 177
<input type="checkbox"/>	30779 Stretch Zip-Up, Full, Large	\$ 177

Vest Dimensions (Inches)	A	B	C	D	E	F
Full SMALL	10.5	14	6.5	6	2	5.25
Full MEDIUM	12	16.25	7.5	6.5	2	6.5
Full LARGE	15.5	18.5	9.25	7.5	2.5	6.75

### Trim Shape, Structured (Non-Stretch) E0960

<input type="checkbox"/>	30774 Structured, Zip-Up, Trim, Small	\$ 177
<input type="checkbox"/>	30775 Structured, Zip-Up, Trim, Medium	\$ 177
<input type="checkbox"/>	30776 Structured, Zip-Up, Trim, Large	\$ 177

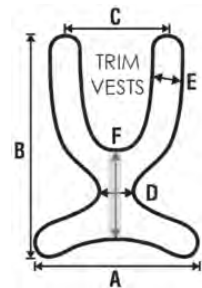
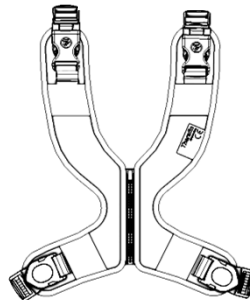

### Trim Shape, Stretch (Non-Stretch) E0960

<input type="checkbox"/>	30780 Stretch, Zip-Up, Trim, Small	\$ 177
<input type="checkbox"/>	30781 Stretch Zip-Up, Trim, Medium	\$ 177
<input type="checkbox"/>	30782 Stretch, Zip-Up, Trim, Large	\$ 177

Vest Dimensions (Inches)	A	B	C	D	E	F
Trim SMALL	10.5	14	6.25	3.5	2	5.25
Trim MEDIUM	12	16.25	7.25	3.5	2	6.5
Trim LARGE	15.5	18.5	9	3.75	2.5	6.75



## TheraFit Y Harness

### Y Harness E0960

<input type="checkbox"/>	30683 Small	\$ 181
<input type="checkbox"/>	30684 Medium	\$ 188
<input type="checkbox"/>	30685 Large	\$ 196

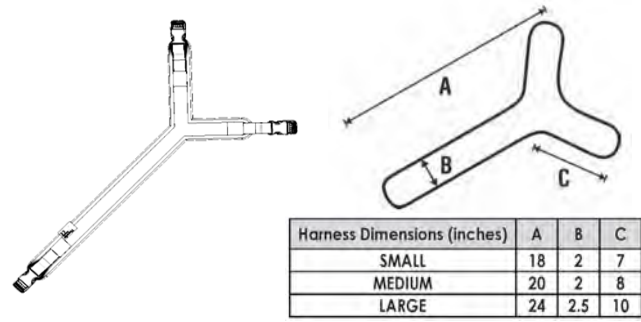

## TheraFit X Harness

### X Harness E0960

<input type="checkbox"/>	30519 Small	\$ 175
<input type="checkbox"/>	30520 Medium	\$ 175
<input type="checkbox"/>	30521 Large	\$ 187

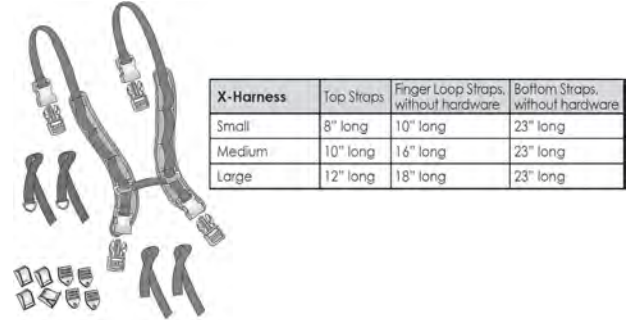

## TheraFit Chest Straps

### 2 Buckles w/Adj. Straps (Stretch) E0960

<input type="checkbox"/>	60110 Dynamic w/ Dual D-Ring Adj, Small	\$ 105
<input type="checkbox"/>	60111 Dynamic w/ Dual D-Ring Adj, Medium	\$ 105
<input type="checkbox"/>	60112 Dynamic w/ Dual D-Ring Adj, Large	\$ 105



Size	Pad Size
Small	3x16
Medium	4x20
Large	4x24

### 1 Buckles w/Adj. Strap (Stretch) E0960

<input type="checkbox"/>	60113 Dynamic w/ Single D-Ring Adj, Small	\$ 134
<input type="checkbox"/>	60114 Dynamic w/ Single D-Ring Adj, Medium	\$ 134
<input type="checkbox"/>	60115 Dynamic w/ Single D-Ring Adj, Large	\$ 134
<input type="checkbox"/>	60123 Dynamic w/ Single D-Ring Adj, X-Large	\$ 156
<input type="checkbox"/>	60124 Dynamic w/ Single D-Ring Adj, 2X-Large	\$ 167



Size	Pad Size
Small	3x16
Medium	4x20
Large	4x24
X-Large	6x28
2X-Large	8x32

### One-Piece w/2 Sewn Straps (Stretch) E0960

<input type="checkbox"/>	60116 Dynamic w/ Fixed Straps, Small	\$ 97
<input type="checkbox"/>	60117 Dynamic w/ Fixed Straps, Medium	\$ 97
<input type="checkbox"/>	60118 Dynamic w/ Fixed Straps, Large	\$ 97



Size	Pad Size
Small	3x16
Medium	4x20
Large	4x24

### Non-Stretch

<input type="checkbox"/>	60147 Static w/ Fixed Straps, Small	\$ 97
<input type="checkbox"/>	60148 Static w/ Fixed Straps, Medium	\$ 97
<input type="checkbox"/>	60149 Static w/ Fixed Straps, Large	\$ 97



Size	Pad Size
Small	3x10 (each piece)
Medium	4x14 (each piece)
Large	4x18 (each piece)

### Two-Piece w/2 Sewn Straps (Stretch) E0960

<input type="checkbox"/>	60119 Dynamic w/ Hook-N-Loop Adj, Small	\$ 134
<input type="checkbox"/>	60120 Dynamic w/ Hook-N-Loop Adj, Medium	\$ 134
<input type="checkbox"/>	60121 Dynamic w/ Hook-N-Loop Adj, Large	\$ 134

### Non-Stretch

<input type="checkbox"/>	60150 Static, 2-Piece w/ Hook-N-Loop Adj, Small	\$ 134
<input type="checkbox"/>	60151 Static, 2-Piece w/ Hook-N-Loop Adj, Medium	\$ 134
<input type="checkbox"/>	60152 Static, 2-Piece w/ Hook-N-Loop Adj, Large	\$ 134

**Two-Piece w/ 2 Sewn Straps, Safety Strap (Non-Stretch) E0960**

- 60153 Static, 2-Piece w/ H&L Adj, 1" Safety Strap, \$ 134
- 60154 Static, 2-Piece w/ H&L Adj, 1" Safety Strap, \$ 134
- 60155 Static, 2-Piece w/ H&L Adj, 1" Safety Strap, \$ 134

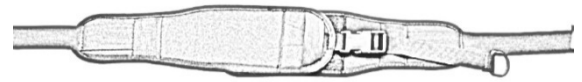

Size	Pad Size
Small	3x10 (each piece)
Medium	4x14 (each piece)
Large	4x18 (each piece)

**1 Rear Buckle w/ Adj. Strap, 1 Sewn Str:**

- 60157 Static w/ Single D-Ring Rear Adj, Small \$ 97
- 60158 Static w/ Single D-Ring Rear Adj, Medium \$ 97
- 60159 Static w/ Single D-Ring Rear Adj, Large \$ 97



Size	Pad Size
Small	3x16
Medium	4x20
Large	4x24

**Universal Positioning Strap**

**Positioning Strap, Universal, Stretch E0960**

- 34434 Small, 3W x 56L \$ 65
- 34435 Medium, 4.5W x 56L \$ 70
- 34436 Large, 6W x 56L \$ 75

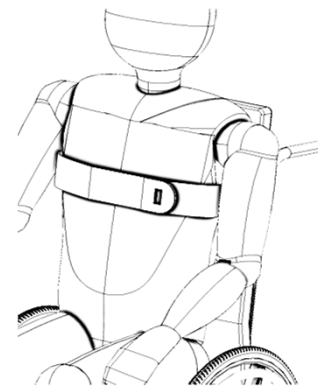

**Strap Guides**

**Strap Positioning Guides, Pair - K0108**

- 51030 Vest Strap Positioning Guides, Pair \$ 34

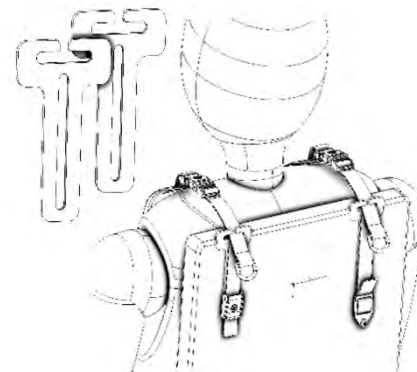

## Foot Supports

### Molded Shoe Holder with Padded Straps Pair K0108

<input type="checkbox"/>	30233	Molded w/ Padded Straps, Small, Pair	\$171.00
<input type="checkbox"/>	30234	Molded w/ Padded Straps, Medium, Pair	\$171.00
<input type="checkbox"/>	30235	Molded w/ Padded Straps, Large, Pair	\$171.00
<input type="checkbox"/>	30236	Molded w/ Padded Straps, X-Large, Pair	\$171.00

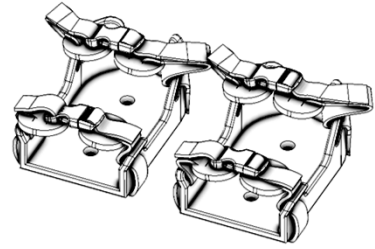

### Molded Shoe Holder with Unpadded Straps Pair K0108

<input type="checkbox"/>	30293	Molded w/ Plain Straps, Small, Pair	\$155.00
<input type="checkbox"/>	30303	Molded w/ Plain Straps, Medium, Pair	\$155.00
<input type="checkbox"/>	30309	Molded w/ Plain Straps, Large, Pair	\$155.00
<input type="checkbox"/>	30316	Molded w/ Plain Straps, X-Large, Pair	\$155.00

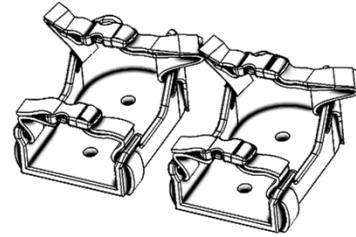

### Footsure Ankle Supports with Buckle Pair K0108

<input type="checkbox"/>	60250	Buckle, X-Small, Pair	\$180.00
<input type="checkbox"/>	60251	Buckle, Small, Pair	\$180.00
<input type="checkbox"/>	60252	Buckle, Medium, Pair	\$180.00
<input type="checkbox"/>	60253	Buckle, Large, Pair	\$180.00
<input type="checkbox"/>	60254	Buckle, X-Large, Pair	\$180.00



### Footsure Ankle Supports with Hook and Loop Pair K0108

<input type="checkbox"/>	60255	Hook & Loop, X-Small, Pair	\$180.00
<input type="checkbox"/>	60256	Hook & Loop, Small, Pair	\$180.00
<input type="checkbox"/>	60257	Hook & Loop, Medium, Pair	\$180.00
<input type="checkbox"/>	60258	Hook & Loop, Large, Pair	\$180.00
<input type="checkbox"/>	60259	Hook & Loop, X-Large, Pair	\$180.00



### Flexsure Feet Foot Supports with Buckles Pair K0108

<input type="checkbox"/>	31765	Hook-N-Loop Closure, Small, Pair	\$321.00
<input type="checkbox"/>	31766	Hook-N-Loop Closure, Medium, Pair	\$321.00
<input type="checkbox"/>	31767	Hook-N-Loop Closure, Large, Pair	\$321.00
<input type="checkbox"/>	31768	Hook-N-Loop Closure, X-Large, Pair	\$321.00



### Flexsure Feet Foot Supports with Hook and Loop Pair K0108

<input type="checkbox"/>	31772	Buckle Closure, Medium, Pair	\$321.00
<input type="checkbox"/>	31773	Buckle Closure, Large, Pair	\$321.00
<input type="checkbox"/>	31774	Buckle Closure, X-Large, Pair	\$321.00



### Flexsure Padded Inserts Pair K0108

<input type="checkbox"/>	31761	Padded Inserts, Small, Pair	\$ 90.00
<input type="checkbox"/>	31762	Padded Inserts, Medium, Pair	\$ 90.00
<input type="checkbox"/>	31763	Padded Inserts, Large, Pair	\$ 90.00
<input type="checkbox"/>	31764	Padded Inserts, X-Large, Pair	\$ 90.00

### Shoe Sandals with Toe Strap Pair K0108

<input type="checkbox"/>	30649	Shoe Sandals, X-Small, Pair	\$278.00
<input type="checkbox"/>	30650	Shoe Sandals, Small, Pair	\$278.00
<input type="checkbox"/>	30651	Shoe Sandals, Medium, Pair	\$278.00
<input type="checkbox"/>	30652	Shoe Sandals, Large, Pair	\$278.00

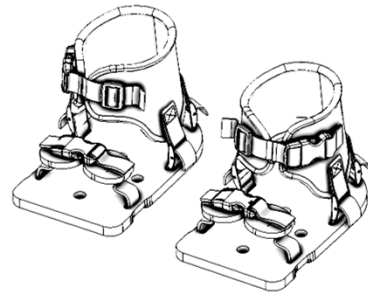

### Shoe Sandals with No Toe Strap Pair E0952

<input type="checkbox"/>	30695	Shoe Sandals, No Toe Strap, X-Small, Pair	\$280.00
<input type="checkbox"/>	30696	Shoe Sandals, No Toe Strap, Small, Pair	\$280.00
<input type="checkbox"/>	30697	Shoe Sandals, No Toe Strap, Medium, Pair	\$280.00
<input type="checkbox"/>	30698	Shoe Sandals, No Toe Strap, Large, Pair	\$280.00

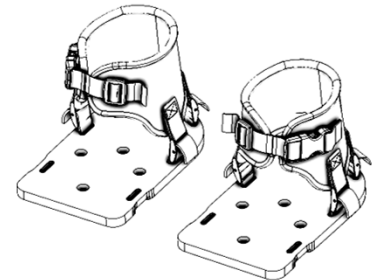

### Shoe Sandals Padded Inserts Pair E0952

<input type="checkbox"/>	30653	Shoe Sandal Padded Inserts, X-Small	\$102.00
<input type="checkbox"/>	30654	Shoe Sandal Padded Inserts, Small	\$102.00
<input type="checkbox"/>	30655	Shoe Sandal Padded Inserts, Medium	\$102.00
<input type="checkbox"/>	30656	Shoe Sandal Padded Inserts, Large	\$102.00

### 2 Piece Padded Shoeholder Pair E0952

<input type="checkbox"/>	30147	Shoeholder w/ 2-Piece Removable 1/2" Thick Pad, 5" x 10", Pair	\$284.00
--------------------------	-------	--	----------

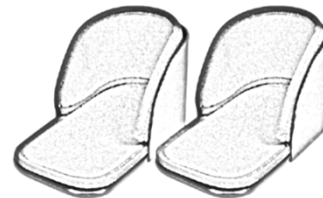

### Padded Full Footbox Each K0108

<input type="checkbox"/>	30111	Footbox, Padded Full, Small	\$299.00
<input type="checkbox"/>	30112	Footbox, Padded Full, Medium	\$321.00
<input type="checkbox"/>	30113	Footbox, Padded Full, Large	\$321.00

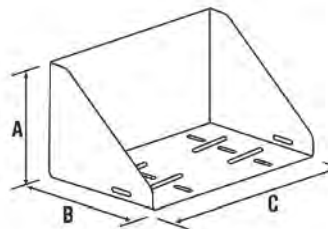

DIMENSIONS (inches)	A	B	C
SMALL	6"	8"	11"
MEDIUM	8"	10"	13"
LARGE	10"	12"	15"

### Padded Split Footbox Pair K0108

<input type="checkbox"/>	30152	Footbox, Padded Split, Small	\$399.00
<input type="checkbox"/>	30153	Footbox, Padded Split, Medium	\$404.00
<input type="checkbox"/>	30154	Footbox, Padded Split, Large	\$411.00

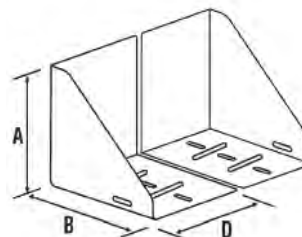

DIMENSIONS (inches)	A	B	D
SMALL	6"	8"	5.5"
MEDIUM	8"	10"	6.5"
LARGE	10"	12"	7.5"

**Custom Padded Full Footbox Each K0108**

- 70043 Footbox, Custom Full w/ Removable Padding \$ 1,363.00
- Box Material**
- 3/8" ABS (Standard)
- Other (Specify)
- Foam Thickness**
- 1/2" (Standard)
- 1"
- Other (Specify)
- Foam Type**
- Poly (Standard)
- Other (Specify)
- Cover Material**
- Soft Vinyl (Standard)
- Other (Specify)

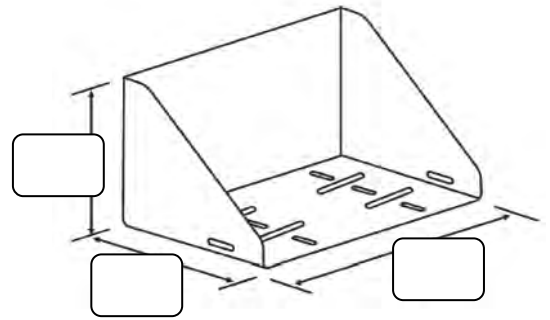

**Custom Padded Split Footbox Pair K0108**

- 70142 Footbox, Custom Split w/ Removable Padding \$ 1,363.00
- Box Material**
- 3/8" ABS (Standard)
- Other (Specify)
- Foam Thickness**
- 1/2" (Standard)
- 1"
- Other (Specify)
- Foam Type**
- Poly (Standard)
- Other (Specify)
- Cover Material**
- Soft Vinyl (Standard)
- Other (Specify)

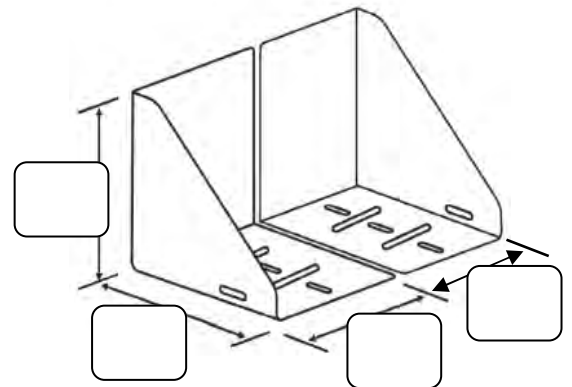

**Toe Straps Pair E0952**

- 30489 Toe Straps, Small 8" to 11.5" \$ 54.00
- 30490 Toe Straps, Medium 9" to 13.5" \$ 54.00
- 30491 Toe Straps, Large 10" to 15.5" \$ 54.00
- 50768 Soft Toe Strap with Buckle 1" , Pair \$ 56.00
- 50769 Soft Toe Strap with Buckle 1.5" , Pair \$ 56.00

**Basic Leg Strap E0960**

- 30398 Leg Strap, Basic, Single \$ 52.00
- 30399 Leg Strap, Basic, Pair \$ 97.00



**Premium Calf Panel K0108**

<input type="checkbox"/>	60038	Calf Panel, Premium, Small	\$ 96.00
<input type="checkbox"/>	60039	Calf Panel, Premium, Medium	\$ 96.00
<input type="checkbox"/>	60040	Calf Panel, Premium, Large	\$ 96.00
<input type="checkbox"/>	60044	Calf Panel, Premium, X-Large	\$175.00
<input type="checkbox"/>	60045	Calf Panel, Premium, 2X-Large	\$187.00

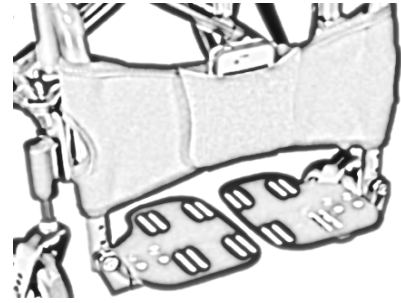

**Pocket for Premium Calf Panel K0108**

<input type="checkbox"/>	60041	Calf Panel Convenience Pocket, Small	\$ 30.00
<input type="checkbox"/>	60042	Calf Panel Convenience Pocket, Medium	\$ 30.00
<input type="checkbox"/>	60043	Calf Panel Convenience Pocket, Large	\$ 30.00

**Calf Panel K0108**

<input type="checkbox"/>	30485	Calf Panel, Standard, Small 11" x 4"	\$ 70.00
<input type="checkbox"/>	30486	Calf Panel, Standard, Medium 13" x 6"	\$ 70.00
<input type="checkbox"/>	30487	Calf Panel, Standard, Large 15" x 8"	\$ 70.00



**Custom Calf Board K0108**

<input type="checkbox"/>	60098	Custom Calf/Leg Board	\$206.00
--------------------------	-------	-----------------------	----------

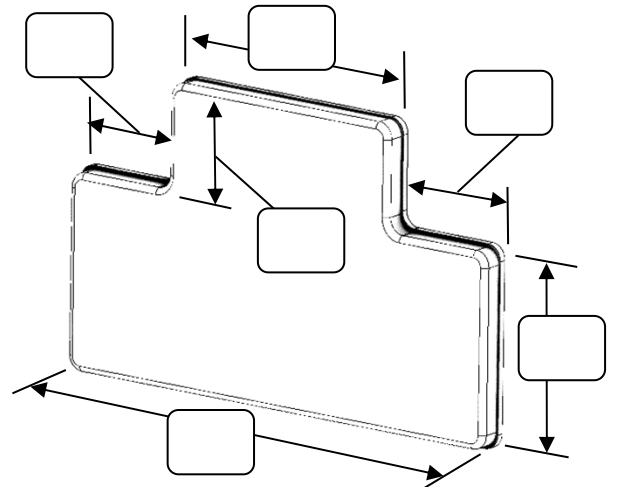

**Custom Foot Plate Board K0108**

<input type="checkbox"/>	52701	Custom Foot Plate Pad	\$231.00
--------------------------	-------	-----------------------	----------

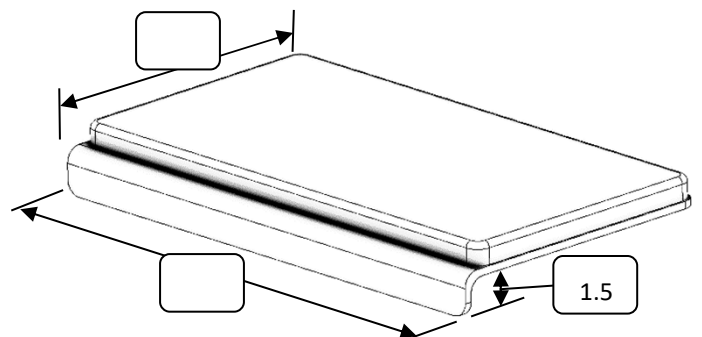

## Arm Troughs

### Arm Trough, Slide-On 4.5"W x 12L

<input type="checkbox"/>	41418	SLIDE-ON, LEFT	\$ 376
<input type="checkbox"/>	41419	SLIDE-ON, RIGHT	\$ 375

Left only Shown

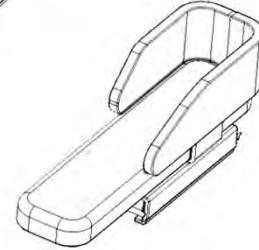
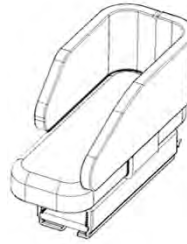

### Arm Trough, Slide-On 4.5"W x 18L

<input type="checkbox"/>	41420	SLIDE-ON, LEFT	\$ 375
<input type="checkbox"/>	41421	SLIDE-ON, RIGHT	\$ 375

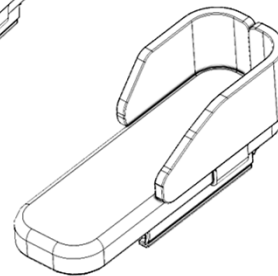
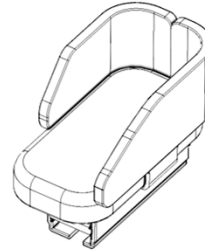

### Arm Trough, Slide-On 6"W x 12L

<input type="checkbox"/>	41422	SLIDE-ON, LEFT	\$ 375
<input type="checkbox"/>	41423	SLIDE-ON, RIGHT	\$ 375

### Arm Trough, Slide-On 6"W x 18L

<input type="checkbox"/>	41424	SLIDE-ON, LEFT	\$ 375
<input type="checkbox"/>	41425	SLIDE-ON, RIGHT	\$ 375

---

### Arm Trough, Clamp-On 4.5"W x 12L

<input type="checkbox"/>	41426	SLIDE-ON, LEFT	\$ 387
<input type="checkbox"/>	41427	SLIDE-ON, RIGHT	\$ 387

Left only Shown

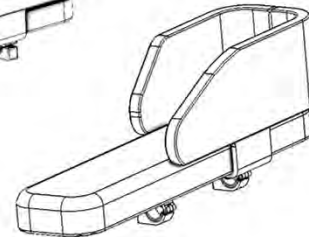

### Arm Trough, Clamp-On 4.5"W x 18L

<input type="checkbox"/>	41428	SLIDE-ON, LEFT	\$ 387
<input type="checkbox"/>	41429	SLIDE-ON, RIGHT	\$ 387

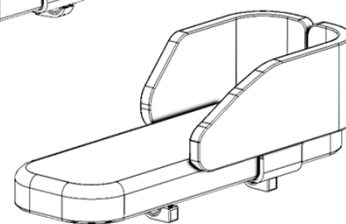
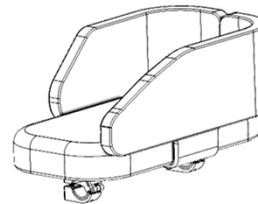

### Arm Trough, Clamp-On 6"W x 12L

<input type="checkbox"/>	41430	SLIDE-ON, LEFT	\$ 387
<input type="checkbox"/>	41431	SLIDE-ON, RIGHT	\$ 387

### Arm Trough, Clamp-On 6"W x 18L

<input type="checkbox"/>	41432	SLIDE-ON, LEFT	\$ 387
<input type="checkbox"/>	41433	SLIDE-ON, RIGHT	\$ 387



## Standard Tray

To Order Standard Tray Place Part Number Below

Refer to Tray Order Form If Needed

## Full Tray Attachment Hardware

(Hardware for trays that attach to both armrests)

### E-Z Lock Clamps

- |                          |       |                      |        |
|--------------------------|-------|----------------------|--------|
| <input type="checkbox"/> | 31098 | E-Z Lock Clamps Pair | \$ 153 |
|--------------------------|-------|----------------------|--------|

### E-Z Lock Clamps - Tube Arms

- |                          |       |                                  |        |
|--------------------------|-------|----------------------------------|--------|
| <input type="checkbox"/> | 31072 | E-Z Lock Clamps - Tube Arms Pair | \$ 163 |
|--------------------------|-------|----------------------------------|--------|

Tray Must be at least 1" wider than outside-to-outside armpad width

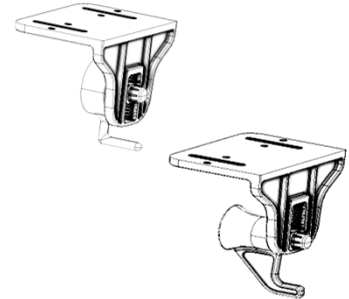

### Top Drop Clamps - Tube Arms

- |                          |       |                                  |        |
|--------------------------|-------|----------------------------------|--------|
| <input type="checkbox"/> | 31070 | E-Z Lock Clamps - Tube Arms Pair | \$ 208 |
|--------------------------|-------|----------------------------------|--------|

Below are adapter plates to allow Top Drop to work on Quantum TB3 Pads

- |                          |       |                             |       |
|--------------------------|-------|-----------------------------|-------|
| <input type="checkbox"/> | 31814 | Adapter Plates, 7.5" (Pair) | \$ 57 |
| <input type="checkbox"/> | 31797 | Adapter Plates 11.5"        | \$ 57 |

Tray Must be at least 3" wider than outside-to-outside armpad width

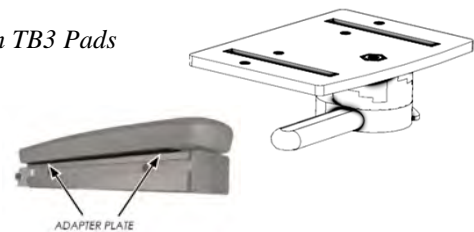

### Z Slide Brackets

- |                          |       |                                      |        |
|--------------------------|-------|--------------------------------------|--------|
| <input type="checkbox"/> | 32747 | 14" Long, 1 1/8" armpad thickness Pr | \$ 116 |
| <input type="checkbox"/> | 32799 | 9" Long, 1 1/8" armpad thickness Pr  | \$ 57  |
| <input type="checkbox"/> | 32793 | 9" Long, 1 1/4" armpad thickness Pr  | \$ 57  |
| <input type="checkbox"/> | 32800 | 9" Long, 1 1/2" armpad thickness Pr  | \$ 57  |

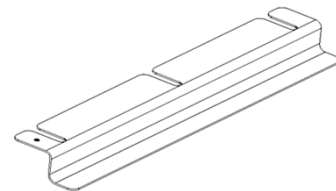

### U Slide Brackets

- |                          |       |                                     |        |
|--------------------------|-------|-------------------------------------|--------|
| <input type="checkbox"/> | 32798 | 6" Long, 1 1/8" armpad thickness Pr | \$ 106 |
| <input type="checkbox"/> | 32794 | 6" Long, 1 1/4" armpad thickness Pr | \$ 106 |
| <input type="checkbox"/> | 32797 | 6" Long, 1 1/2" armpad thickness Pr | \$ 106 |



### Tube Arm Brackets

- |                          |       |                                      |        |
|--------------------------|-------|--------------------------------------|--------|
| <input type="checkbox"/> | 31908 | 6" Long, 1 3/16" ring diameter Pr    | \$ 106 |
| <input type="checkbox"/> | 31907 | 7.5" Long, 1 3/16" ring diameter Pr  | \$ 106 |
| <input type="checkbox"/> | 31904 | 7.5" Long, 1 1/2" ring diameter Pr   | \$ 106 |
| <input type="checkbox"/> | 31902 | 7.5" Long, 1 11/16" ring diameter Pr | \$ 106 |

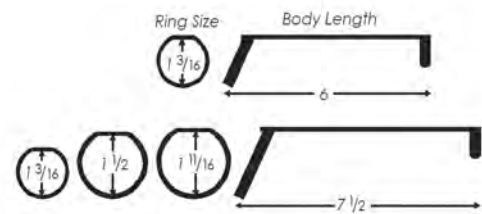
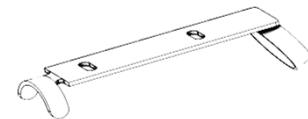

### Strap Mounting

- |                          |       |                            |       |
|--------------------------|-------|----------------------------|-------|
| <input type="checkbox"/> | 31091 | Hook and Loop Straps, Pair | \$ 19 |
| <input type="checkbox"/> | 31882 | Back Strap                 | \$ 25 |



## Special Instructions

Enter Any Special Instructions in the area below