

WHISPER-LITE SWINGAWAY SIP-N-PUFF

PARTS DESCRIPTION

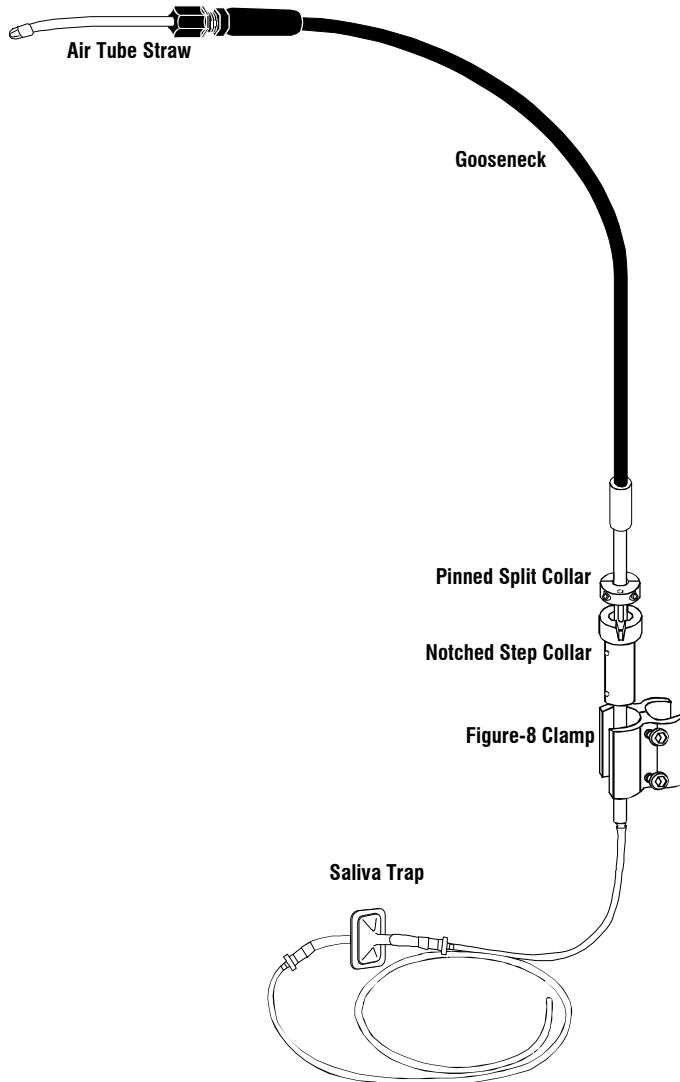

REPLACEMENT PARTS AND ACCESSORIES

ITEM	PART#	Figure-8 Clamp	32310
Air Tube Straw/10Pack	32698	Figure-8 Clamp, Black	32310B
Air Tube Straw/100Pk	32662	Large Fig.-8, Black	32312
Saliva Trap/5Pack	32661	Multimount Adaptor	32826
1/8" I.D. Clear Vinyl Tube, 5 yards			30088



9450 W Laraway Rd • Frankfort, IL 60423
Customer 800-843-7234 • Fax 888-479-1515
www.Therafin.com • info@Therafin.com

ASSEMBLY FOR STATIONARY USE

1. Install and tighten set screws into **Notched Step Collar**. Remove **Pinned Split Collar**, it will not be needed for stationary use.

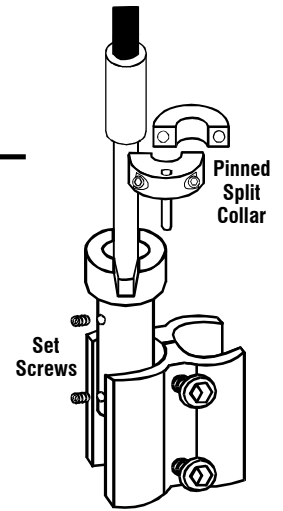

2. Place **Figure-8 Clamp** with Sip-N-Puff unit onto chair frame*, and tighten **Figure-8 Clamp's** button head cap screws. The **Figure-8 Clamp** can be turned and adjusted vertically during final adjustment.

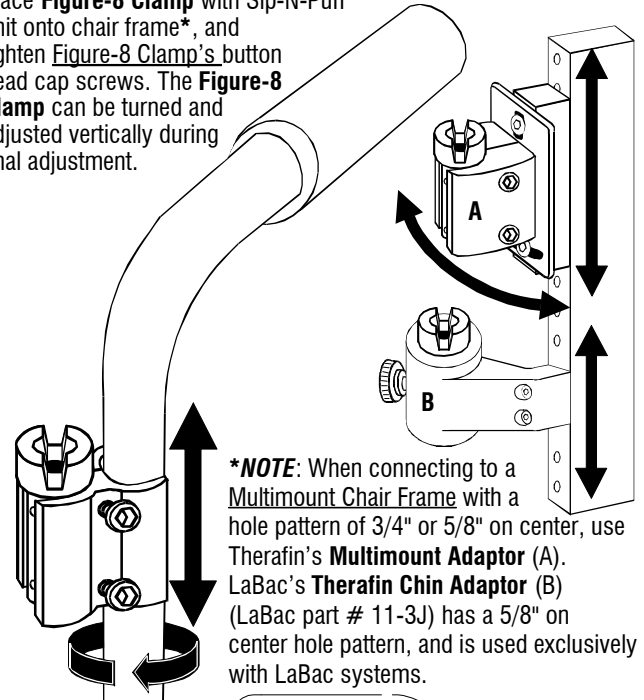

***NOTE:** When connecting to a **Multimount Chair Frame** with a hole pattern of 3/4" or 5/8" on center, use Therafin's **Multimount Adaptor (A)**. LaBac's **Therafin Chin Adaptor (B)** (LaBac part # 11-3J) has a 5/8" on center hole pattern, and is used exclusively with LaBac systems.

3. **Gooseneck** can be bent, turned, and adjusted vertically for final adjustment.
4. For final adjustment, turn or vertically slide appropriate part(s) to allow the **Air Tube Straw** to be positioned near the user's mouth. Re-tighten all cap screws.

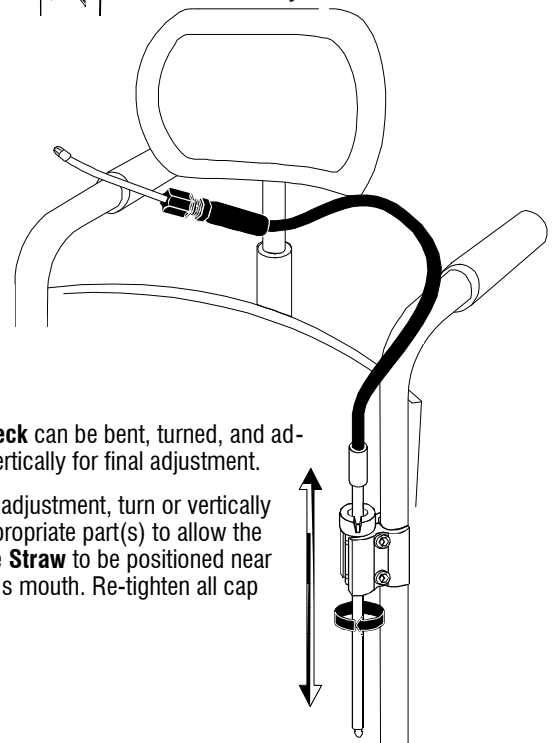

ASSEMBLY FOR SWING-AWAY USE

1. **Notched Step Collar** fits in **Figure-8 Clamp**. **Notched Step Collar** can be turned during final adjustment.

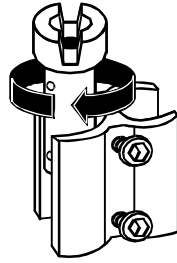

2. Place **Figure-8 Clamp** with Sip-N-Puff unit onto chair frame*, and tighten button head cap screws. The **Figure-8 Clamp** can be turned and adjusted vertically during final adjustment.

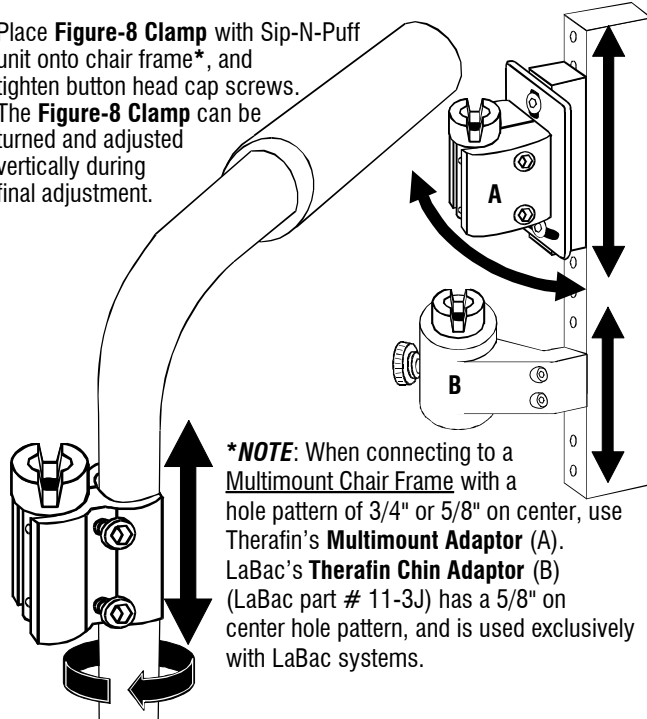

***NOTE:** When connecting to a Multimount Chair Frame with a hole pattern of 3/4" or 5/8" on center, use Therafin's Multimount Adaptor (A). LaBac's Therafin Chin Adaptor (B) (LaBac part # 11-3J) has a 5/8" on center hole pattern, and is used exclusively with LaBac systems.

3. **Pinned Split Collar** can be turned and adjusted vertically during final adjustment.

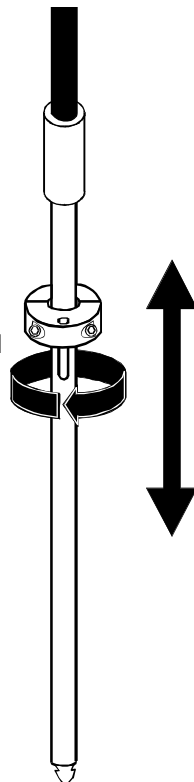

4. The pin in the **Pinned Split Collar** must rest in the notch in the **Notched Step Collar**.

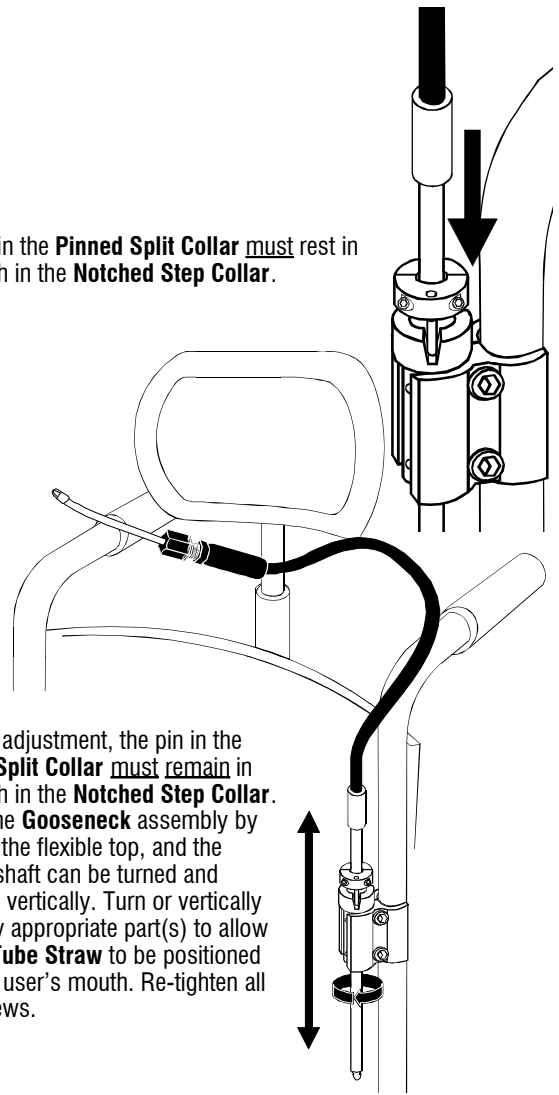

5. For final adjustment, the pin in the **Pinned Split Collar** must remain in the notch in the **Notched Step Collar**. Adjust the **Gooseneck** assembly by bending the flexible top, and the bottom shaft can be turned and adjusted vertically. Turn or vertically slide any appropriate part(s) to allow the **Air Tube Straw** to be positioned near the user's mouth. Re-tighten all cap screws.

USING

1. Connect tubing to fitting on bottom of **Gooseneck** shaft. Place **Saliva Trap** between **Gooseneck** shaft and your Control Unit.
2. To remove the user from the chair without changing the optimal adjustments you have made, simply lift the **Gooseneck** assembly and swing the entire unit out of the way. This will lift the pin in the **Pinned Split Collar** out of the notch in the **Notched Step Collar**. The **Gooseneck** assembly should be swung 180 degrees, and the pin will drop and lock into the notch, held securely out of the way. When the user is returned to the chair, the unit is swung back into place, and the pin will drop and lock into the notch, returning the **Gooseneck** to the previously set position.

MAINTENANCE

To change **Air Tube Straw**, loosen and remove compression fitting nut. Push straw through nut, and cut off compressed end of straw. Pull straw through nut and discard. To insert new **Air Tube Straw** into nut, place bottom end of nut onto hard, flat surface (table top). Push straw end down into hole, through compression flange, until straw makes contact with table top. Retighten nut onto compression fitting.

CLEANING

For external cleaning, wipe with moist cloth. Use mild detergent if desired. For internal cleaning, disconnect from ECU, remove saliva trap, and flush with warm running water. If available, rinse with a disinfecting oral rinse (Listerine, Scope, etc.). Cleaning at least twice a week is recommended, more as needed.